



# LEWIS POULTRY HOUSEKEEPER OWNER / OPERATOR MANUAL



## MODEL # 2 HOUSEKEEPER

From: Serial # 5825

Manufactured by:

**LEWIS BROTHERS MANUFACTURING, INC.**

Post Office Box 146

Baxley, GA 31513

Tel: (912) 367-4651

Fax: (912) 367-3958

1-29-14

# **INTRODUCTION**

All Lewis Brothers equipment is manufactured under stringent production and quality assurance procedures prior to preparation for shipment. A final quality check is performed on all equipment before shipping.

The best equipment is only as good as its operation and management. Sound operation and good preventive maintenance practices are essential to efficient performance of your Lewis Poultry Housekeeper.

Questions on parts and service for the equipment covered in this manual should be referred to the local dealer from whom the equipment was purchased, or the nearest Lewis Brothers Dealer.

We sincerely thank you for purchasing Lewis Brothers equipment.

# **TABLE OF CONTENTS**

INTRODUCTION	2
SAFETY	5
Owner's And Operator's Responsibility	6
General Precautions	7
LIMITED WARRANTY	10
SPECIFICATIONS	12
SETUP AND OPERATION	13
Tractor Settings	14
Attachment to Tractor	14
Operating Instructions	16
Spreader Installation	18
Turkey Operations	21
Towing and Transport	21
STORAGE	23
MAINTENANCE	25
Chain Adjustments	25
Setup for Total Clean out	32
Lubrication and Hydraulic Oil	33
Tires	33
Repairs	33
Decals	35
PARTS	38
Cylinder Reel Assembly	39
Shaker Wheel Assembly	39
Gooseneck	40
Hitch	40
Oil Tank and Related Parts	41
Loading Bars	42
Loading Chain	43
Leveling Bar	43
Leveling Chain	44
Unloading Chain	44
Loading Shaft Assembly	45

Loading conveyor Idler Sprocket Assembly	47
Leveling Shaft Assembly	47
Leveling Conveyor Idler Sprocket Assembly	49
Unloading Shaft Assembly	50
Unloading Motor and Related Parts	51
Bumper	52
Tailgate Hyd. Actuator Assembly	53
Tailgate Related Parts	54
Tank Filter and Related Parts	55
Control and Variable speed Valve	56
Guards	57
Hose Assemblies	61
Fittings and Adapters	63
Hydraulic Pump Assembly	64

# **SAFETY**

# **OWNER'S AND OPERATOR'S RESPONSIBILITY**

This manual is intended for use with your Lewis Poultry Housekeeper. Extra effort has been made to provide for safe operation of this equipment. This manual as well as the safety decals placed on the equipment is part of that effort. Your new Housekeeper should perform the various functions for which it was designed if it is maintained, adjusted to your specific conditions, and operated correctly.

It is the responsibility of the owner and every operator of this equipment to read and understand this manual before initial startup, before each season, before performing service or maintenance tasks and prior to storing the equipment. Each employee who will work on or around this equipment should be instructed in how to do so safely.

It is important to understand the operational methods and safety issues mentioned in this manual. Lewis Brothers cannot anticipate all conceivable ways service and operational functions might be performed and of the possible hazardous consequences of such. Anyone using or servicing this equipment must first satisfy themselves that their chosen methods do not jeopardize the safety of themselves, others, or the equipment.

Read the warranty on page 10. The purchaser is required to fill out and return the registration card supplied with this owner's manual within ten (10) days of purchase to Lewis Brothers Manufacturing to be eligible for warranty coverage.

Genuine Lewis replacement parts will insure the durability and long life of your Housekeeper. Lewis repair parts and optional equipment should be ordered through your Lewis Brothers' Dealer.

Operators should thoroughly inspect the Housekeeper before and after each use. All chains and bearings should be properly lubricated as specified, and any worn or damaged parts repaired or replaced. Failure to repair or replace worn parts could result in damage or excess wear to other parts.

# GENERAL PRECAUTIONS

- **MAKE SURE** everyone is clear of the equipment before starting the tractor's engine and while equipment is under operation.
- **DO NOT** permit anyone to ride on this equipment.
- **KEEP** hands, feet, hair and clothing away from all moving parts. Do not wear loose clothing while operating equipment, as this may present an entanglement hazard.
- **DRIVE** the pulling tractor at speeds compatible with conditions and good safety practices. This is especially important when operating over rough ground, on slopes, crossing ditches or while turning. Tip over may occur if a safe speed is not maintained during operation.
- **STOP** the tractor's engine and relieve any hydraulic pressure by actuating all hydraulic valves in both directions before disconnecting any part of the hydraulic system.
- **MAKE SURE** hitch components are attached securely before operating or transporting.
- **USE** flashing warning lights when on highways, except where prohibited by law.

- **STOP** tractor engine before leaving operator's position to adjust, lubricate, clean or unclog machine.
- **KEEP** all shields in place.
-  **DANGER** Chock wheels and block up head of machine securely prior to working under machine. Failure to do so may result in serious injury or death.
- **MAXIMUM** towing speed is 25 MPH.
- **OBSERVE** all safety decals located on machine. Should any safety decal become damaged unreadable, or lost, **REPLACE IT IMMEDIATELY**. New decals may be obtained from your Lewis Brothers' dealer.
- **WEAR** dust respirator at all times while using this machine (3M part # 8710 is recommended).
- **R.O.P.S.** Use ROPS and seat belts whenever and wherever applicable. If your tractor has a foldable ROPS, fold it down only when absolutely necessary and fold it up and lock it again as soon as possible. Do not wear seat belt when the ROPS is folded. We strongly recommend the use of ROPS and seat belts in almost all applications.



# **WARRANTY**

# **LEWIS BROTHERS MANUFACTURING, INC.**

## **LIMITED WARRANTY**

Lewis Brothers Manufacturing, Inc. (hereinafter referred to as "LBM") warrants each item of new equipment manufactured by LBM to be free from defects in material and workmanship under normal use and service.

The obligation of LBM under this LIMITED WARRANTY is limited to repair or replacement, as LBM may elect, of any parts that prove, in LBM's judgment, to be defective in material and workmanship within the first twelve (12) months after the date of invoice to the original purchaser. THIS LIMITED WARRANTY DOES NOT APPLY TO BELTS, HYDRAULIC HOSES, TIRES, AND OTHER SERVICE ITEMS, WHICH SHALL HAVE A NINETY (90) DAY WARRANTY.

**THIS LIMITED WARRANTY WILL APPLY FOR (3) MONTHS ONLY WHEN THE UNIT IS USED IN A COMMERCIAL APPLICATION.**

All warranty part repairs and replacements must be made by a certified LBM dealer. Any outside work or alterations made without written approval of LBM will render this LIMITED WARRANTY void.

LBM's obligation specifically excludes any liability for consequential damages, such as loss of profit, delays, expenses, damage to goods or property used in connection with or processed in or by the product sold, or damage to the product sold from whatever cause, whether or not such loss is due to negligence by LBM.

This LIMITED WARRANTY shall not apply to any item that has been operated in a manner not recommended by LBM.

No person is authorized to give any other warranties or to assume any other liability on behalf of LBM unless made in writing by Lewis Brothers Manufacturing, Inc.

THIS LIMITED WARRANTY IS IN LIEU OF AND REPLACES ALL OTHER WARRANTIES, EXPRESSED OR IMPLIED. WARRANTIES OF MERCHANTABILITY AND FITNESS FOR A PARTICULAR PURPOSE ARE EXCLUDED, AS ARE ALL OTHER REPRESENTATIONS TO THE USER-PURCHASER AND ALL OTHER OBLIGATIONS OR LIABILITIES, INCLUDING LIABILITY FOR INCIDENTAL AND CONSEQUENTIAL DAMAGES, ON THE PART OF LBM.

***LEWIS BROTHERS MANUFACTURING, INC.***  
***P.O. BOX 146 - BAXLEY, GA. 31513***  
***FEBRUARY 1, 2007***

# **SPECIFICATIONS**

# SPECIFICATIONS

## Housekeeper Model # 2

Overall Working Height	64 inches
Overall Length	20 ft.
Overall Width	78-1/2 inches
Throat	51-1/2 inches
Capacity	100 cu ft.
Weight (unloaded)	3600 lbs.
PTO Hydraulic Pump	16 GPM
Hydraulic Pressure @ 540 rpm	2500 psi
Tire Pressure	50 psi
Tire Size	11 L x 15
Hydraulic Oil	AW-68
Oil Reservoir Capacity	18 gallons
Tractor PTO Horsepower required	40 HP
Tongue Weight (unloaded)	920 lbs.

# **SETUP AND OPERATION**

# MACHINE SETUP

## TRACTOR SETTINGS

The Lewis Poultry Housekeeper #2 is designed to be operated at 540 rpm PTO. If your tractor has an option of a 540 or 1000 rpm PTO, you should install the 540 shaft.

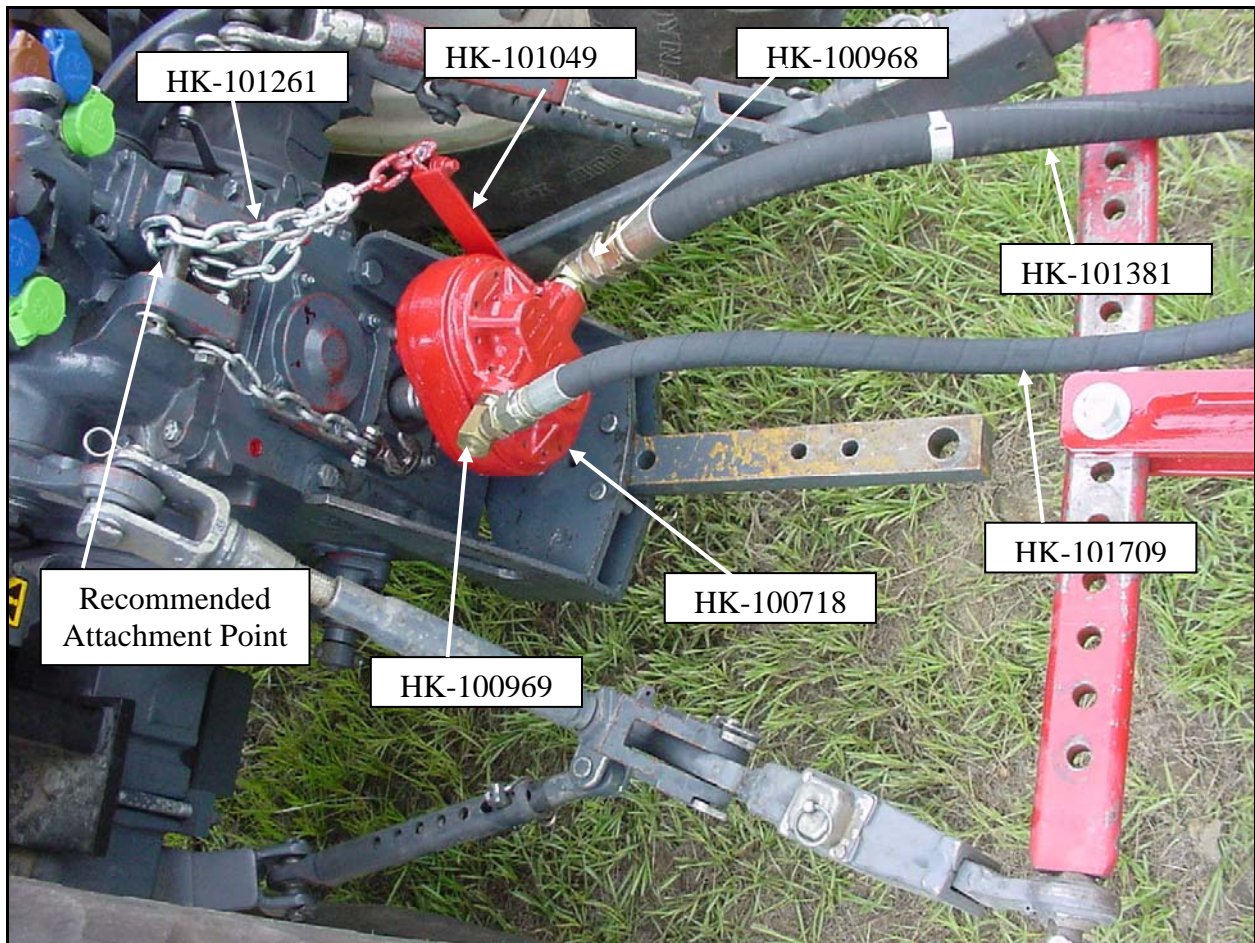

Figure 1

## ATTACHING HOUSEKEEPER TO TRACTOR

Attach the Poultry Housekeeper to the tractor's moveable drawbar using a heavy-duty hitch pin. Next, attach the hydraulic pump to the tractor PTO shaft. Slide the pump onto the PTO shaft as far as possible. Secure its position by wrapping the

chain on the torque arm around some portion of the tractor hitch which is secure and will not allow the pump to slide off or spin once the PTO is engaged.

A good place to chain the pump is around the top link pin. Always try to pull the pump from the PTO after it is chained into place. If the pump slides very far back on the shaft it is not snug enough. Take up another link on the chain and repeat the process again. Making this connection too tight may put excess pressure on the PTO shaft resulting in damage to pump or shaft. (See figure 1)

The main control valve should be adjusted so that it is easily accessible to the operator, but not so close that it will make contact with the tractor. (See figure 2)

**CAUTION** The Oil Supply Valve Handle must be in the horizontal position at all times during operation in order to supply full flow to the system. Be sure to check before engaging the pump. Failure to maintain this position will damage the pump.

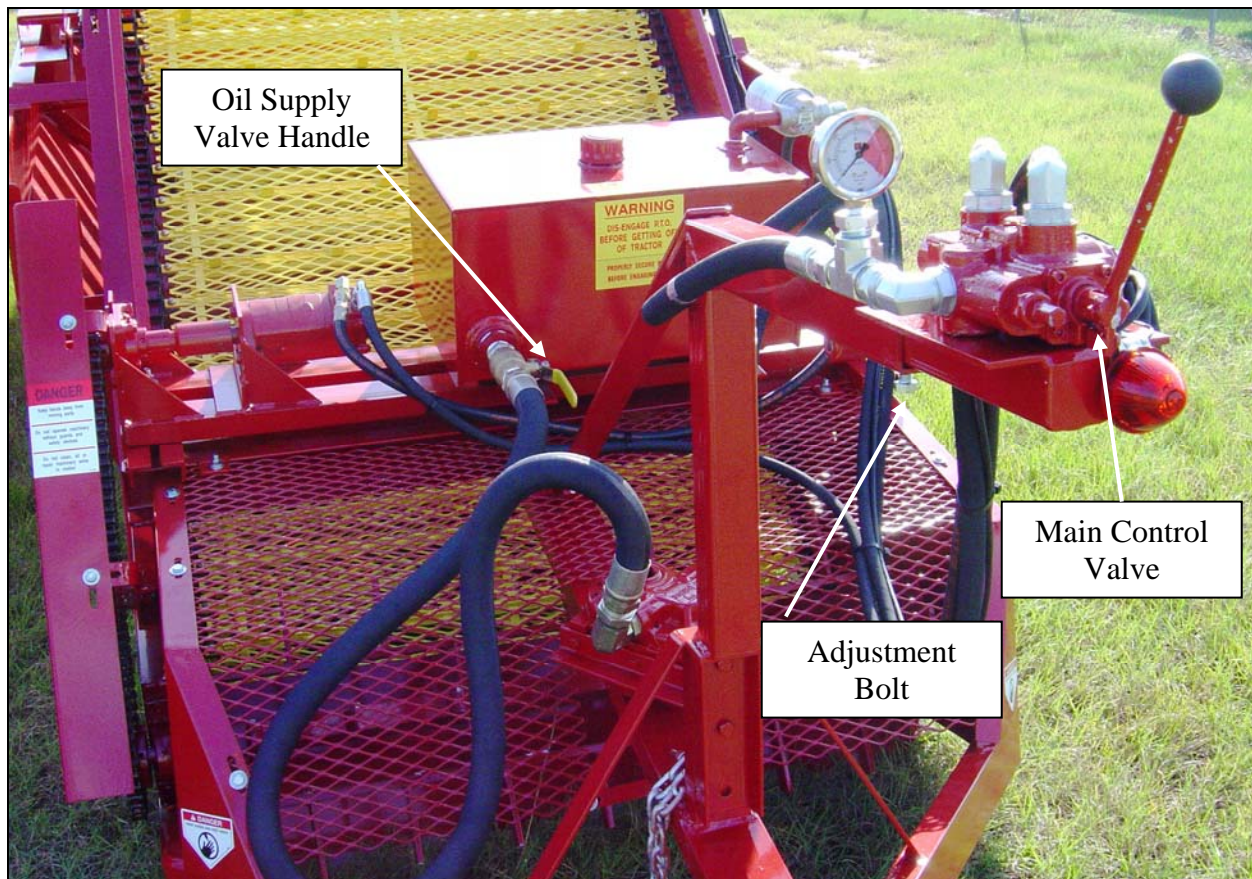

Figure 2

# OPERATING INSTRUCTIONS

The Lewis Poultry Housekeeper #2 is designed to be operated with the tractor PTO turning within a range of 500 to 540 RPM. 540 RPM is the most desirable speed and will produce the maximum flow and pressure from the pump. To put the machine into operation, first engage the PTO of the tractor and then pull the control valve handle forward. This should start the cylinder reel, loading conveyor and the leveling assembly into motion. Next, bring the PTO of the tractor up to speed.

The ground speed will depend on the particular operation being performed and the amount of material being removed from the floor of the house. Generally, first gear or 1 to 1-1/2 MPH is used for total clean out and removal of medium cake during sifting. Very heavy cake or excessive ground speed may cause litter to be pushed in front of the machine. The Poultry Housekeeper operates best at a depth of 3-4 inches. If litter or cake is deeper than four inches it is recommended that two passes be made through the house to clean or sift the litter. In excessive cake the ground speed may be reduced to help sift the total cake in a single pass. Higher gears may be used when sifting where the litter does not exceed 3-4 inches and where cake is light.

Speeds of the drive components are very important to the performance of the Poultry Housekeeper. PTO speeds in the 500-540 ranges should be maintained at all times during operation.

The ability to shake the loading conveyor while sifting the litter is what makes the Lewis Poultry Housekeeper work so well. Shaking makes the separation process work by allowing the smaller particles to pass through the screens while the larger "cakes" are tumbled for a short time before being carried into the body. The gentle lifting and shaking process keeps wet litter and feathers from passing through the screens.



Setting and maintaining the proper blade depth is important for maximum performance. To properly set the depth, slowly lower the front of the Poultry Housekeeper into the litter with your tractor. Lift until the desired depth is reached. It may take some time to become accustomed to how deep the blade is running. By observing the blade and loading cylinder during operation, proper depth can be determined for the given conditions. In houses where uniform amounts of material will be removed, set the stops on the tractor lift. This will provide consistent blade depth each time the machined is raised or lowered.

The body loads from front to rear, and although it is sometimes difficult to see the rear of the machine because of the dust, the operator will know the body is full when the leveling bars begin to kick litter into the air. When this occurs, move the control valve handle to the center position to disengage the conveyor. The load is now ready to be transported and unloaded at the desired site.

The body may be unloaded by spreading or by a quick dump method. If the spreading method is to be used, refer to the section on "Spreader Installation and Operation" on the following pages. To do a quick dump as in composting or stockpiling:

1. Make sure the bumper and spreader are not attached and that the hydraulic hoses are connected properly. Remove tailgate lock-down bolts and the tension springs from upper section of the tailgate. (See Figure 3) Store these in a secure place for later installation.
2. The center springs and pins should be installed between the upper and lower sections of the tailgate as shown in figure 3. This will cause the tailgate to become rigid and function as one piece while litter is being transferred rearward. Failure to install these properly will result in improper unloading of litter.
3. Once you have reached the composting or unloading site, push the control valve lever to the rear and begin the unloading process. The unloading chain will drag the litter out the back of the machine. Forward movement of the machine may be necessary to allow for litter being discharged.
4. After all the litter has been discharged, pull away from the pile and move the control lever forward to the loading position. This will engage the (optional) tailgate cylinder and cause the tailgate to return to the closed position. It is important to unload all the litter or the tailgate will not close properly. The machine is now ready to be re-loaded.

**CAUTION**

Never back the Lewis Poultry Housekeeper while the loading assembly is in the down position and in operation! Litter and other objects may be forced into the rear of the loading assembly and possibly cause the assembly to jam. Always lift the front of the machine or stop the assembly before backing the machine.



Figure 3

# **SPREADER INSTALLATION AND OPERATION**

## **INSTALLATION**

1. The spreader unit comes pre-assembled and is attached to the main frame of the Housekeeper using four 1/2x1-1/2 inch bolts.(see figure 4)
2. Locate the hydraulic 'quick-coupler' attached to the base end of the tailgate cylinder and uncouple the fittings from the coupling block (see fig. 5). Connect the two ends to the matching fittings on the hydraulic motor located on the spreader assembly (see figure 4).
3. Install the bumper and the diverter assembly.
4. Remove the pins and springs in the center section of the tailgate and store in a secure location.
5. Attach the lower tailgate tension springs from the tailgate to the frame

## **OPERATION**

Two primary concerns when spreading litter are the amount being applied and the pattern of distribution. The settings for the discharge rate will vary depending on the consistency of the litter. The common setting for dry litter is position No. 5 on the control valve. The flow control valve may be increased or decreased depending on the volume of litter to be applied.

The distribution pattern is influenced by the location of the diverter attached to the rear bumper. Best results are achieved when the diverter is positioned at approximately 45 degrees. (See Figure 4)

Fresh litter may be spread in the house with the Housekeeper once the clean out process has been completed. Shavings may be loaded into the body of the Housekeeper with a front loading device or by picking up the shavings with the loading conveyor of the Housekeeper itself. If equipped with perforated bars, you will need to remove the shaker wheels and operate the Housekeeper in the slowest gear and speed.

The unloading and spreading process requires a lot of hydraulic capacity both in volume and pressure. It is not uncommon for low horsepower tractors to become heavily loaded during these operations. Slower speeds may be required if this situation occurs.

**⚠ WARNING** Do not operate the spreader with anyone standing behind the machine. The material being discharged is traveling at a high rate of speed and could contain objects capable of causing serious personal injury.

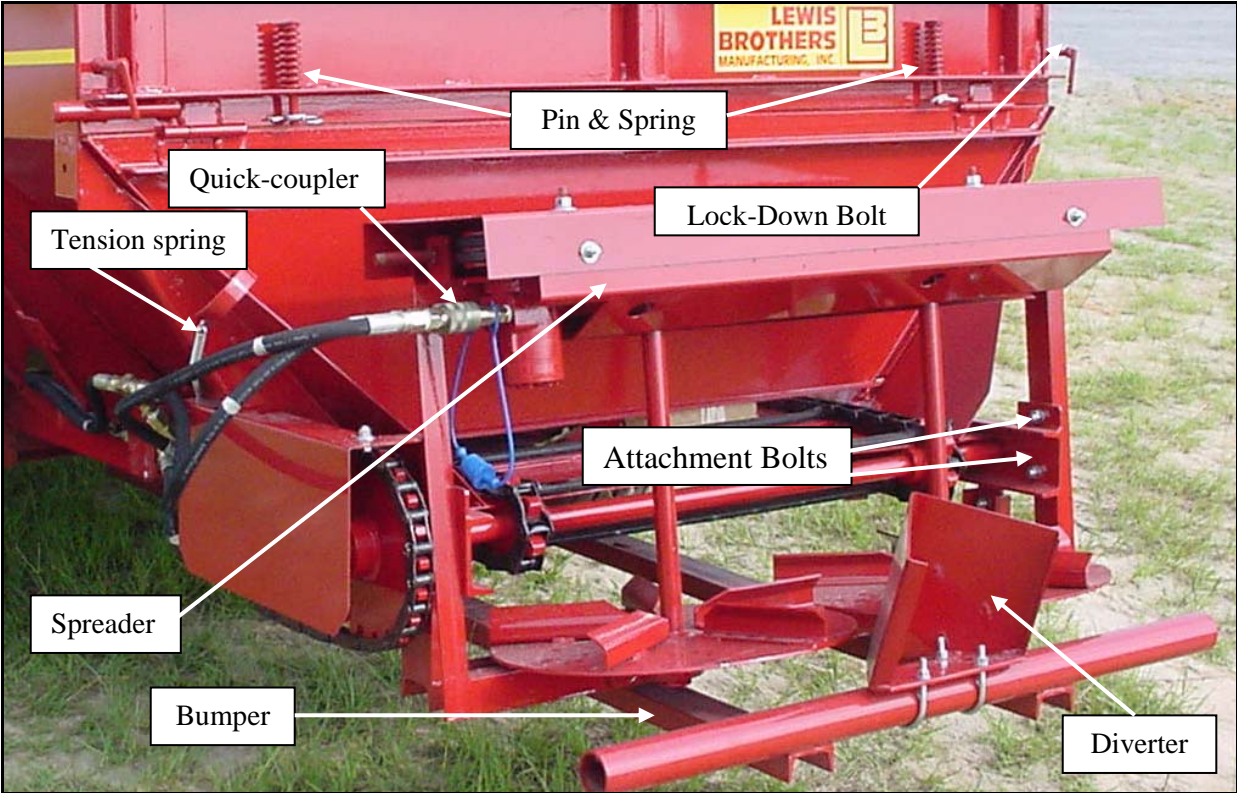

Figure 4

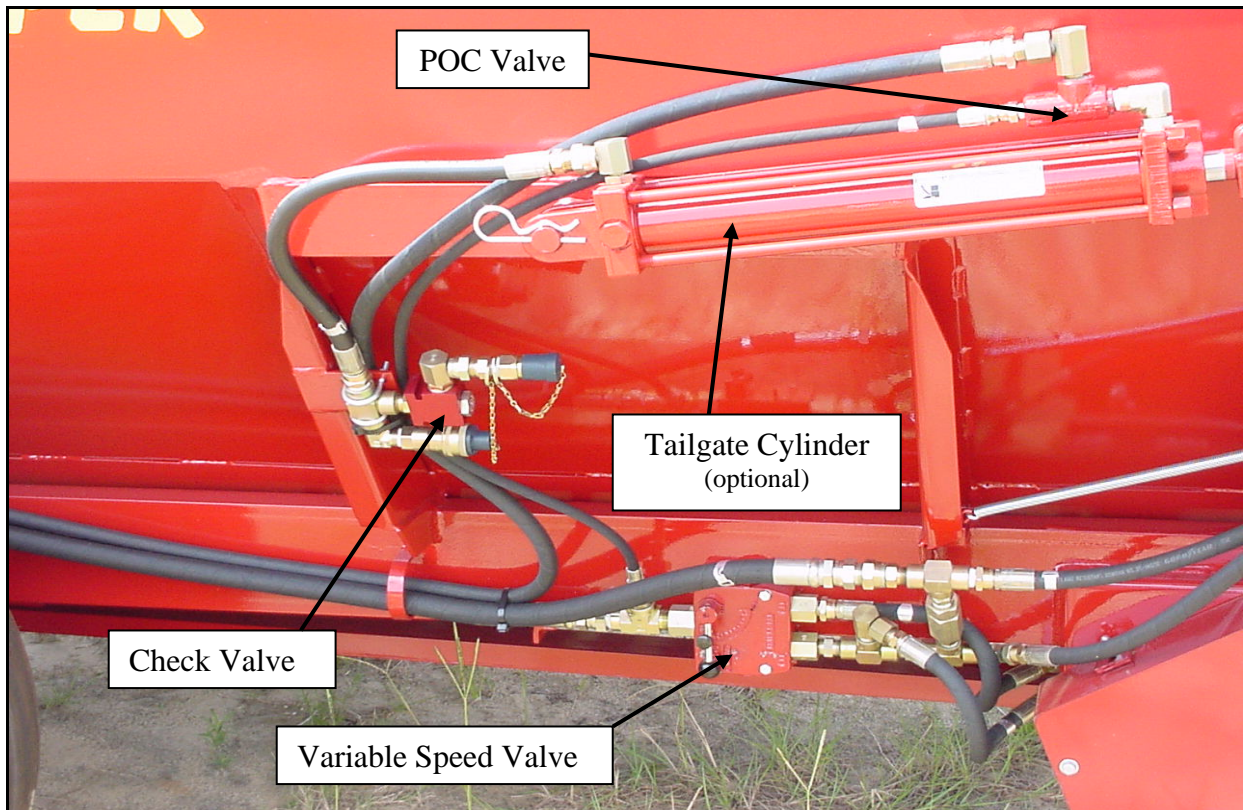

Figure 5

## **TURKEY OPERATIONS**

When the Lewis Poultry Housekeeper is used in very heavy turkey cake, it may become necessary to slow the ground speed to 1/2 MPH. This works best because it is very difficult to cut through turkey litter due to the very large feathers present. Additionally, feathers may wrap around the blade and loading cylinder, causing litter to be pushed ahead of the machine. The following procedure must be followed to properly remove the feathers from the loading blade.

1. Stop the tractor.
2. Disengage control valve.
3. Back the tractor up with the head in the down position.
4. Stop the tractor.
5. Engage control valve to loading position.
6. Start tractor in a forward motion again.
7. All feathers are wiped from the loading blade and are then loaded into the body.

With the #2 Housekeeper, you can leave strips a little less than (4) ft. wide. You then come back and work the strips. This positions your tires down on each side of the strip leaving the floor smooth and rigid free.

## **TOWING AND TRANSPORTING**

A tractor of sufficient weight and power is required to both pull and control a Lewis Brothers Housekeeper over the terrain in the given area of operation. A tractor with a minimum of 40 PTO hp is required for proper operation of the # 2 Housekeeper. In order to have full control, your tractor must be able to maintain traction under all turf or surface conditions. Additional weights may be required to the front of the tractor to avoid unstable towing conditions.

If it becomes necessary to tow the Poultry Housekeeper behind a truck for extended distances the following is recommended. Store the hydraulic pump on the support pin located on the tongue and secure it with the torque bar chain. Tie up all hoses to prevent them from dragging or becoming damaged. Tongue weight for towing is approximately 900 to 1000 lbs. The truck used for towing must be heavy enough to pull the Housekeeper, but more importantly must be equipped to safely stop under the additional load.

The hitch height must provide a clearance of five to six inches below the blade of the Housekeeper after the Housekeeper has been attached to the towing vehicle.

Maximum caution should be maintained at all times when transporting the Lewis Housekeeper.

# STORAGE

## **STORAGE**

After each use, the Poultry Housekeeper should be washed down thoroughly removing all litter, inside and out. After washing, treating with a disinfectant is recommended in order to kill any remaining bacteria. The next step is treating the machine with soluble oil to protect it from rust and corrosion. One product that meets these requirements is called LPS#3. You may find this or other similar products at your Lewis Poultry Housekeeper Dealer; tractor dealerships or farm supply stores. It is important to remember that all chains must be properly lubricated after each use and especially before storage.



When washing the Housekeeper, never allow a high-pressure water stream to come in contact with bearings or idler seals. Water can be forced into the bearing and will cause premature failure.

Check all safety decals and make any necessary replacements. Decals may be obtained from your Lewis Dealer.



# **MAINTENANCE**

# MAINTENANCE

## CHAIN ADJUSTMENTS

Periodical adjustments may be necessary to the conveyor chains, drive chains or belts and leveling assembly chains.

With the operator in front of the Housekeeper and facing towards the machine, the **loading cylinder drive chain** will be located on the left side of the machine. As it wears and stretches from use, the idler sprocket should be adjusted to remove any slack.

Proper tension on the chain should allow for approximately 1 inch of movement in the tightness of chain. (See figure 6)



Figure 6

The loading conveyor chain will also need adjusting as it wears. To adjust the tension on the chain, loosen all bolts on the base of the upper loading shaft bearing. Next, tighten the adjustment nut on the adjustment rod located at the top of the assembly. Be sure to adjust both sides of the assembly equally before securing the bolts. (See figure 7)

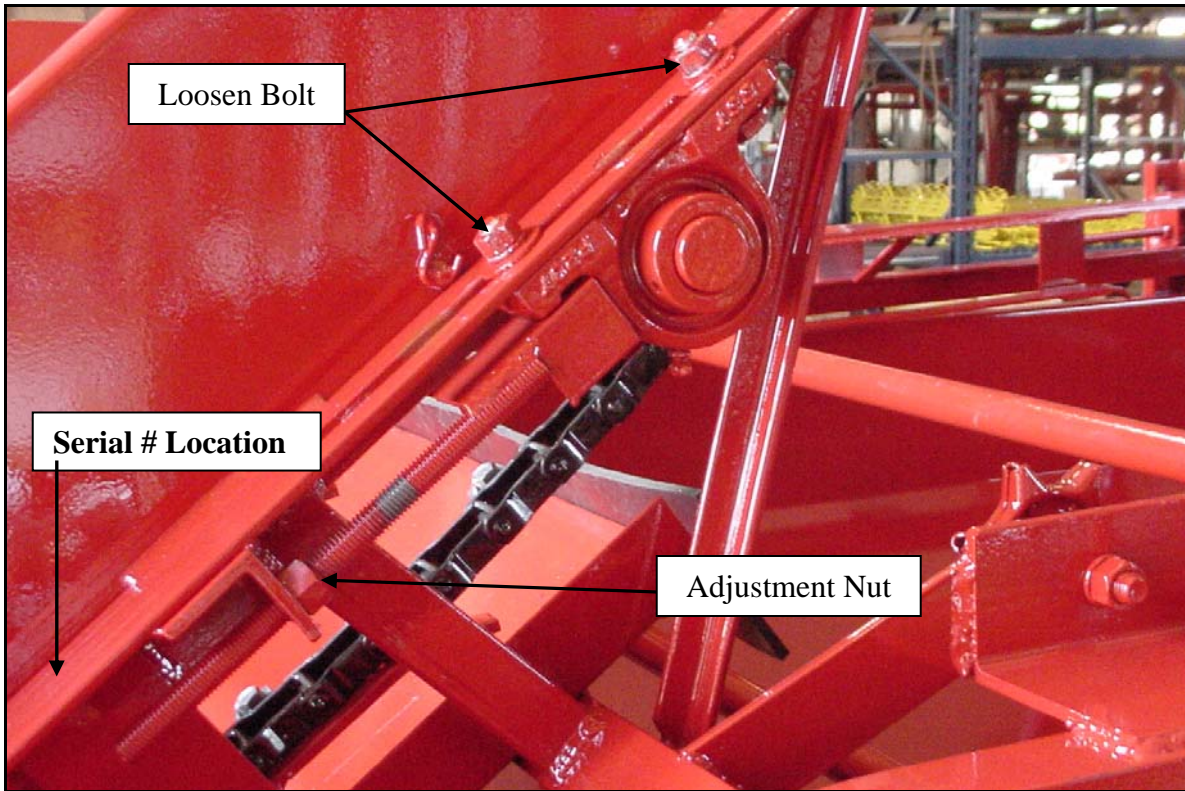
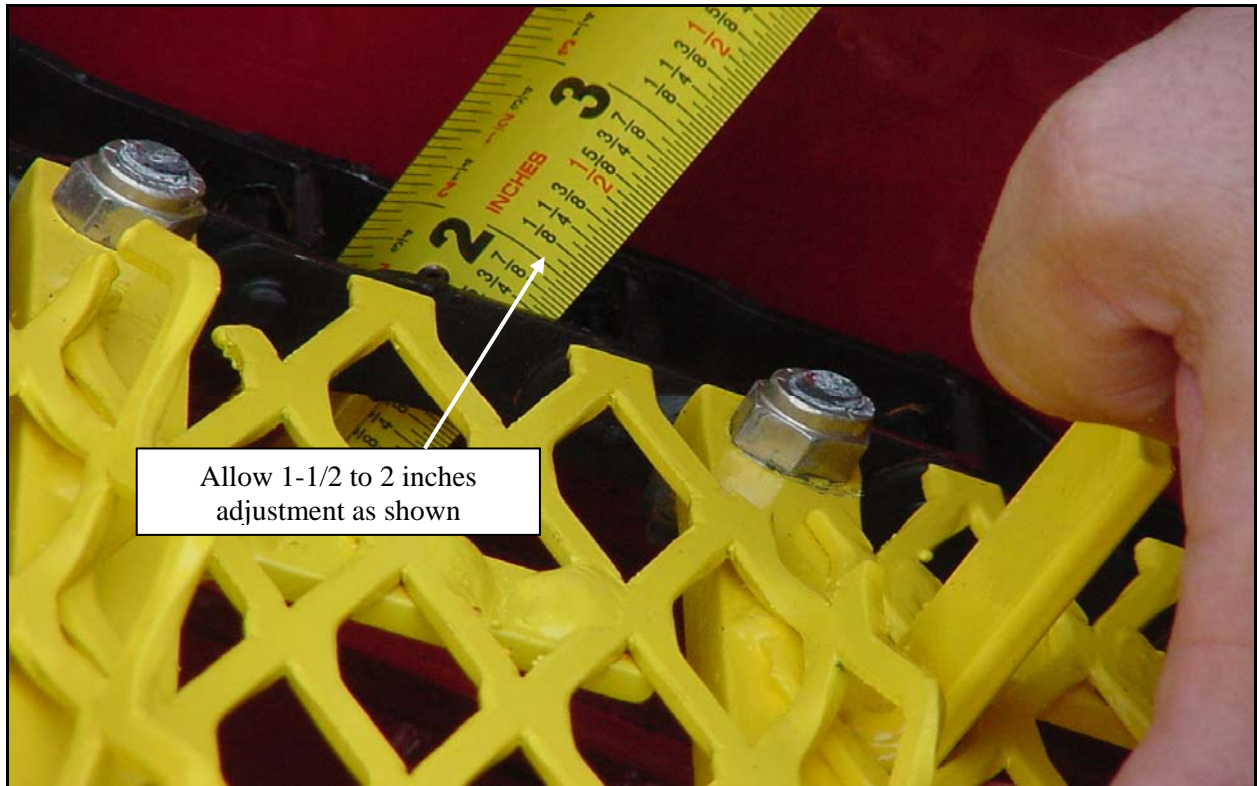

Figure 7

Proper tensioning of this chain should allow you to lift the chain off the side runners between 1-1/2 to 2 inches. (See Figure 8a) When the chain stretches far enough that it cannot be tightened, you must remove two links and one bar and reconnect the chain. Do this by grinding out selected link pins. Reassemble the chain by using an attaching link. Be sure to remove and replace any damaged bars or worn chain links.

When adjusting the tension on the leveling chain, there should be contact between the chain and the lower runner with the chain slightly rising off the lower runner at the rear of the machine. (See Figure 8b)



Allow 1-1/2 to 2 inches adjustment as shown

Figure 8a



Excess sag should be adjusted out before operation

Chain should slightly rise at rear of runner when properly tensioned

Figure 8b

The **leveling chain assembly** is adjusted from the rear of the assembly. Begin by loosening the jam nut located on the adjustment rod. Next, loosen the bearing flange bolts and turn the adjustment rod to achieve the proper tension. Special care should be taken to adjust both sides of the assembly in equal amounts. Adjusting one side more than the other will cause misalignment of the assembly and damage the assembly. (See Figure 9)

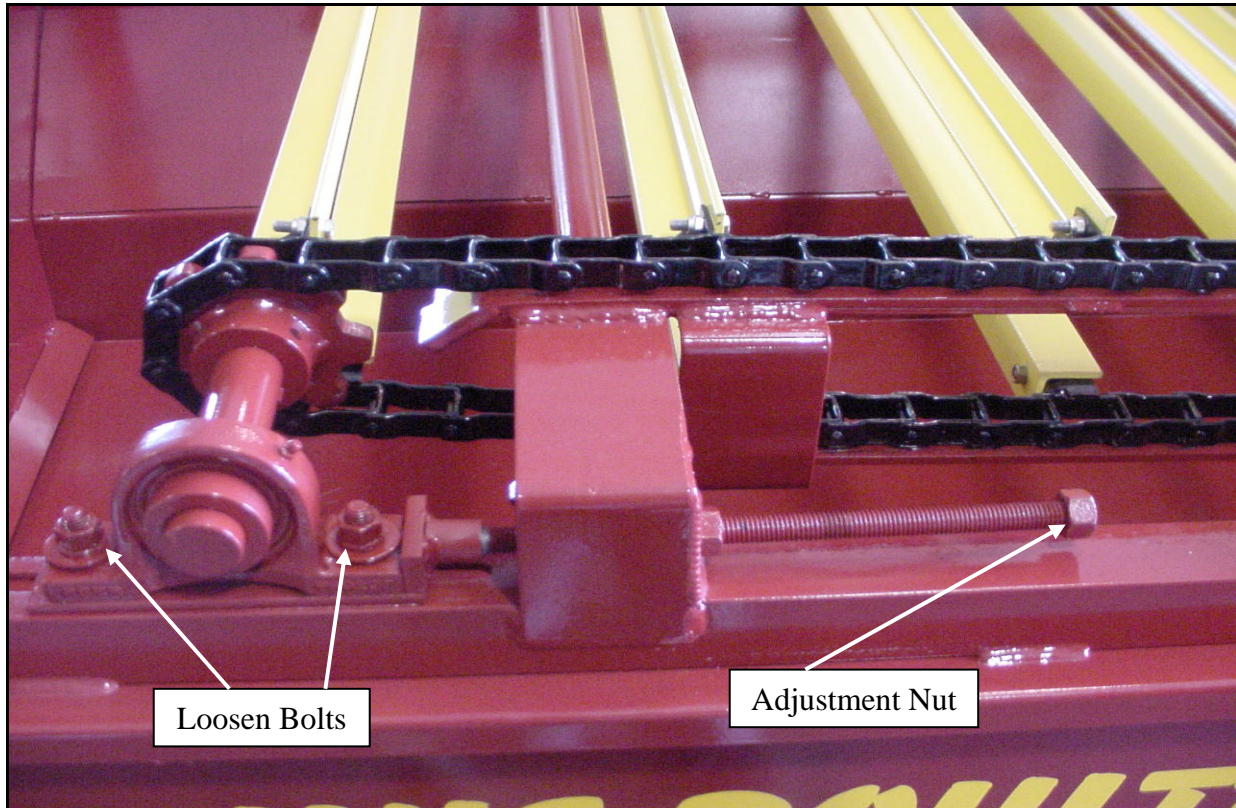

Figure 9

The **unloading chain** adjustment is located at the front of the chain directly behind the lower portion of the loading conveyor. Adjust both sides of the idler shaft assembly equally by tightening the adjustment nut. (See fig. 10)

The chain should be tightened until approximately 5-3/4" clearance exists between it and the body floor in order to achieve proper tensioning. This should place the bottom of the chain even with, or just below the main frame channel.

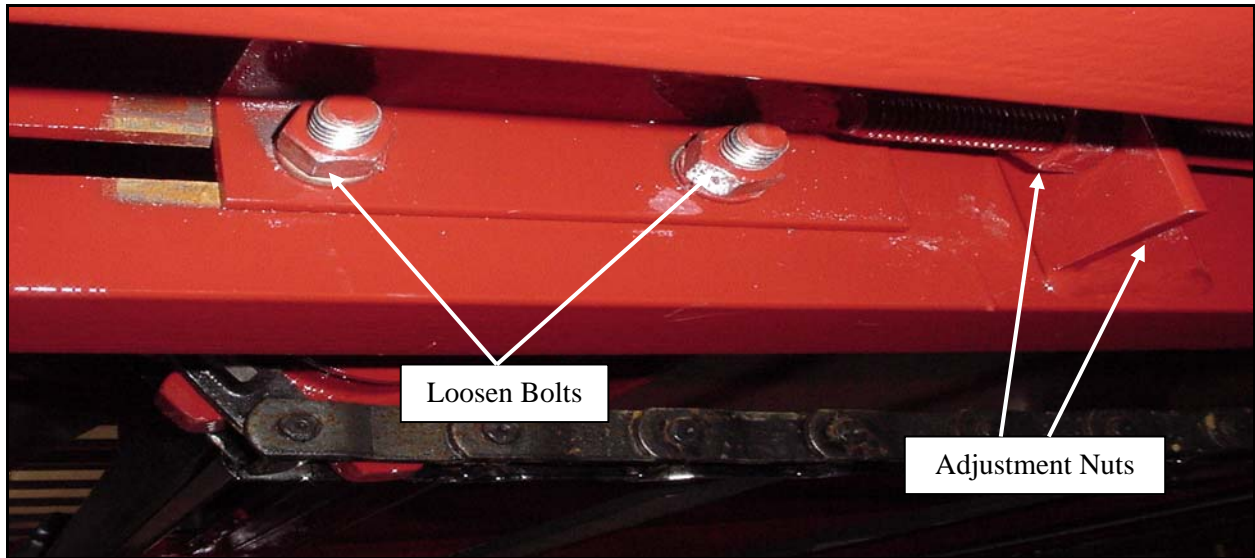

Figure 10

The **unloading drive chain** can be adjusted by loosening the idler and sliding it downward in the slot. (See Figure 11) Proper adjustment should allow for 1/2" to 1" of movement on the tension side of the chain when not under a load. Once the correct tension has been set, secure the idler by tightening the idler bolt and re-install the guard.

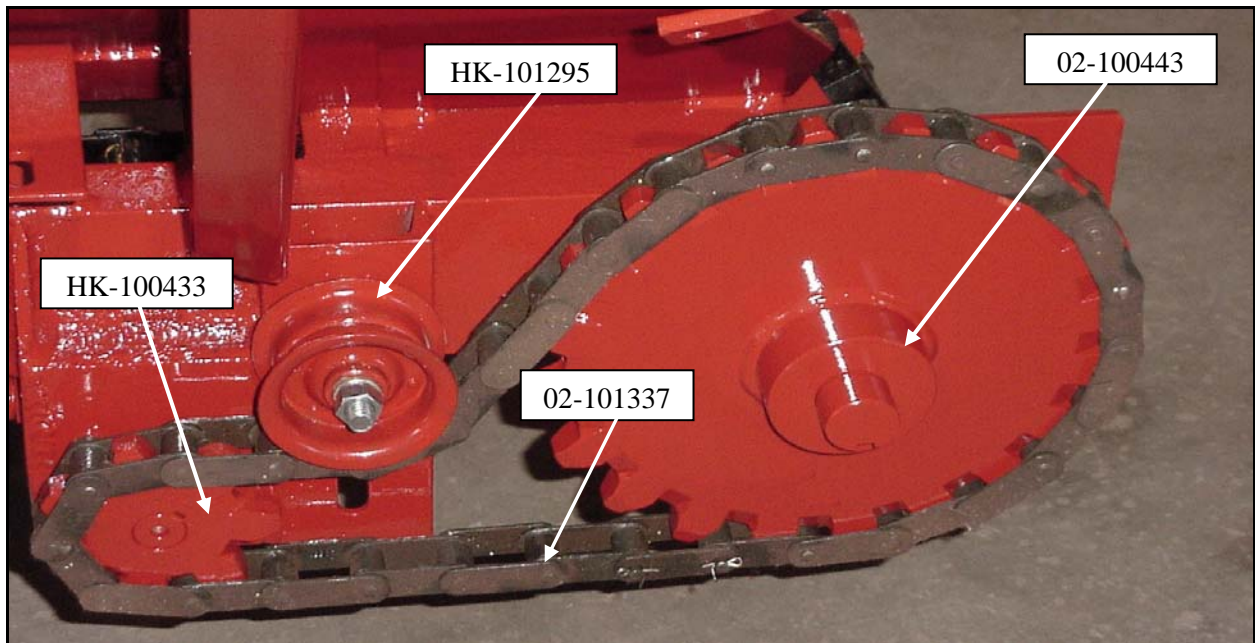

Figure 11

The drive belts on the spreader assembly may need to be adjusted over time. The first step after removing the protective guard is to loosen the idler axle bolt. Tighten the adjustment nut on the draw bolt until the proper tension is achieved. Re-secure the idler assembly by tightening the idler axle bolt. (See Figure 12)

It should take 4-5 pounds of force to deflect a single belt 5/16 of an inch at the midpoint of the longest span. If no gauge is available to make this measurement, an alternative method of measurement would be to apply moderate force using one finger to push the belt 5/16 of an inch. Once the proper tension has been achieved for each of the belts, secure their position by tightening the jam nut and axle bolt.

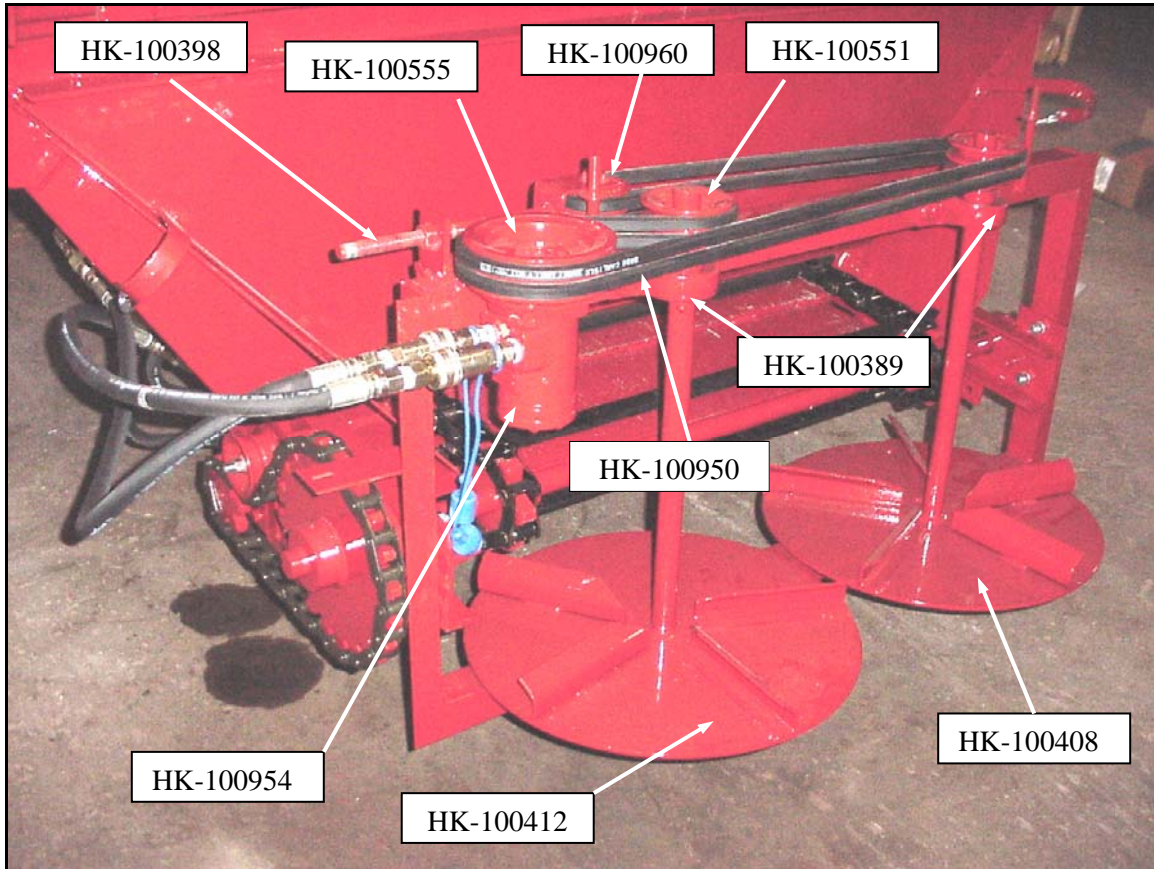

Figure 12

HK-100433	Sprocket, Unloading Motor
HK-101295	Idler
02-101337	Drive Chain
02-100443	Sprocket, Rear Unloading Shaft
HK-100398	Belt Adjustment Rod
HK-100555	Pulley, Drive
HK-100960	Pulley, Idler
HK-100551	Pulley, Spinner Shaft
HK-100950	Belt, Spinner Assembly
HK-100408	Shaft and Blade Weldment, R.H.
HK-100412	Shaft and Blade Weldment, L.H.
HK-100389	Bearing, Spinner Shaft
HK-100954	Spinner Motor

The **hydraulic leveling drive chain** assembly should also be checked regularly and adjusted as needed. After removing the guard, locate and loosen the leveling shaft assembly bolts. (See figure 13) Use the adjustment rod to set the proper tension on the drive chain taking care not to over-tighten. Once the proper adjustment has been made re-tighten the assembly bolts and re-install the guard.

**ATTENTION:** Be sure to keep all drive chains well lubricated and free of obstructions to insure proper operation.

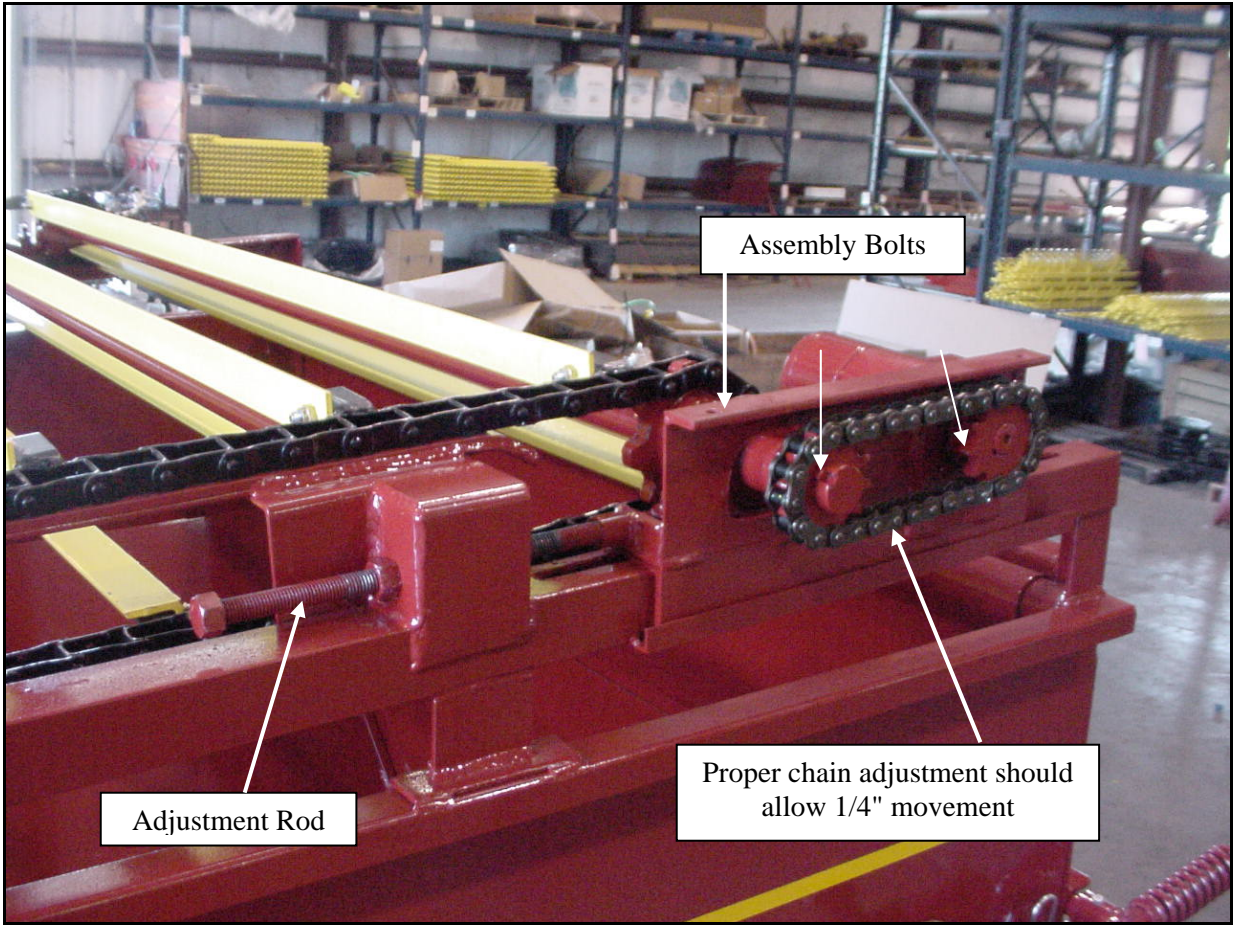

Figure 13



## **BELT DRIVEN HOUSEKEEPERS**

Chain drives on housekeepers are adjusted to the specs, as are hydraulic drives. The belt must be loosened – the chains adjusted and then the belt re-tightened.

## **SETTING THE MACHINE FOR TOTAL CLEANOUT**

Setting the machine for total clean out requires that all perforated bars utilized for caking or sifting be removed and replaced with solid bars. The best method to achieve this is to first remove all perforated bars before installation of the solid bars. The use of an impact wrench will make this job easier and much faster. Once all perforated bars have been removed, the shaker wheels (See figure 14) must then be removed. This must be done prior to the installation of the solid bars. Replace the solid bars one at a time using the same hardware. Replace the bars on the front of the machine, then rotate the conveyor chain over and replace the remaining bars.

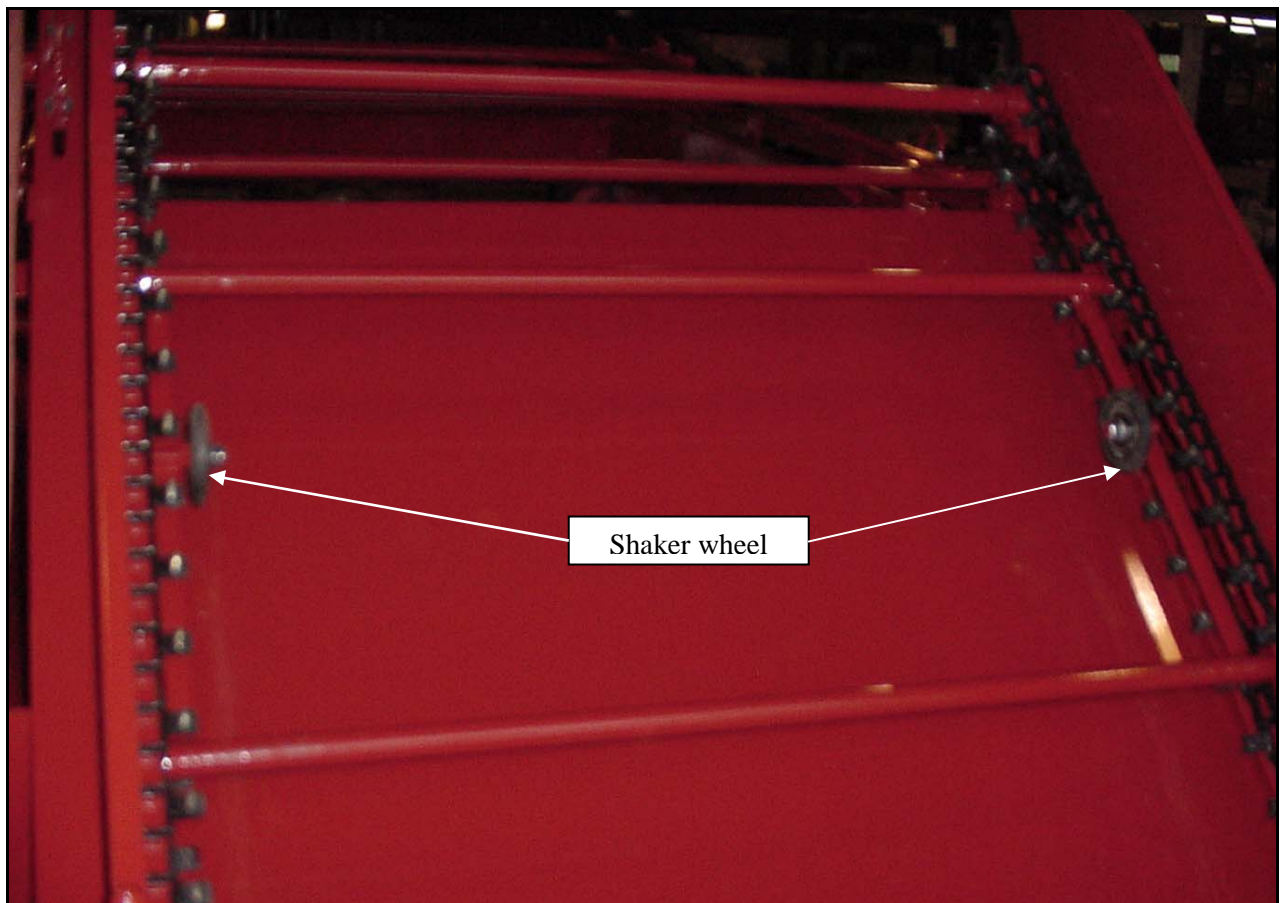

Figure 14

# LUBRICATION

## HYDRAULIC FLUID

The hydraulic fluid is a vital component of the system. Low levels may cause overheating and damage to hydraulic components. The hydraulic system holds approximately 20 gallons. With the machine on level ground, the oil level in the tank should come to within four inches of the top of the tank. If it becomes necessary to add hydraulic fluid, use petroleum based anti-wear hydraulic oil with ISO 68 viscosity grade AW 68. Oil temperature should not exceed 180 degrees Fahrenheit. In the event that components may need replacing, the hydraulic oil should also be replaced.



Always look for hydraulic leaks with the tractor's engine off. Wear hand and eye protection. Use a piece of cardboard or wood instead of your hands to search for a leak's source.

Grease all chains and bearings after each use. Change the oil filter every six (6) to twelve (12) months depending on usage.

## TIRES

Check tire pressure on a regular basis. Adjust the pressure not to exceed 50 PSI.

## REPAIRS

Check for worn or damaged components. Order needed parts from your Lewis Dealer. Make all repairs as early as possible to avoid additional expense. Prolonged use of worn or damaged parts may result in premature failure of other components.

# DECALS

# MODEL #2

HK-100901

**PAT. #4,897,183**  
**PAT. #6,092,668**

HK-100923

**KEEP AWAY  
FROM  
MOVING MACHINE**

HK-100986

**WARNING**



**MOVING PART HAZARD**  
To prevent serious injury or death from moving parts:

- Close and secure guards and shields before starting.
- Keep hand, feet, hair and clothing away from moving parts.
- Disconnect and lockout power source before adjusting or servicing.
- Do not stand or climb on machine when operating.

SUNWEST SCREEN GRAPHICS® SW 404

HK-100908

**CAUTION**

1. Read Operator's Manual before using machine.
2. Stop tractor engine, lower machine to the ground, place all controls in neutral, set park brake, remove ignition key and wait for all moving parts to stop before servicing, adjusting, repairing, unplugging or fitting.
3. Install and secure all guards before starting.
4. Keep hands, feet, hair and clothing away from moving parts.
5. Do not allow riders.
6. Keep all hydraulic lines, fittings and couplers tight and free of leaks before using.
7. Clean reflectors, SMV and lights before transporting.
8. Install safety locks before transporting or working beneath components.
9. Add extra lights and use pilot vehicle when transporting during times of limited visibility.
10. Use hazard flashers in tractor when transporting.
11. Install safety chain when attaching to tractor.
12. Keep away from overhead electrical lines. Electrocutation can occur without direct contact.
13. Review safety instructions with all operators annually.

SW4

HK-100906

**DANGER**

KEEP HANDS AND FEET AWAY



SUNWEST SCREEN GRAPHICS® SW B03

HK-100916

**BE CAREFUL**

1. KEEP ALL SHIELDS IN PLACE.
2. STOP ENGINE BEFORE LEAVING OPERATOR'S POSITION TO ADJUST, LUBRICATE, CLEAN OR UNCLOG MACHINES.
3. WAIT FOR ALL MOVEMENT TO STOP BEFORE SERVICING THE MACHINE.
4. KEEP HANDS, FEET AND CLOTHING AWAY FROM POWER DRIVEN PARTS.
5. KEEP OFF EQUIPMENT UNLESS SEAT OR PLATFORM FOR OPERATION AND OBSERVATION IS PROVIDED.
6. KEEP ALL OTHERS OFF.
7. USE FLASHING WARNING LIGHTS WHEN OPERATING ON HIGHWAYS EXCEPT WHEN PROHIBITED BY LAW.
8. MAKE CERTAIN EVERYONE IS CLEAR OF MACHINE BEFORE STARTING ENGINE OR OPERATION.

HK-100899

HK-100899



**HK-100918**



**HK-100917**



**HK-100910**

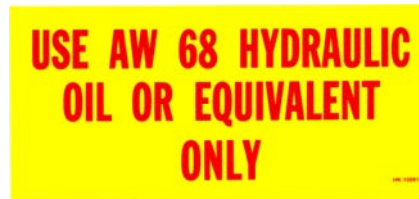

**HK-100911**

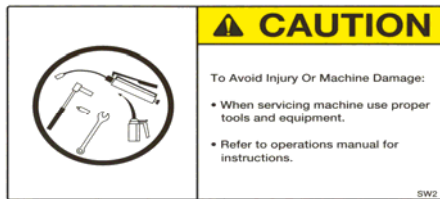

**HK-100907**



**HK-100912**



**HK-100919**



**HK-100913**



# LEWIS



## POULTRY HOUSEKEEPER

MANUFACTURED BY  
**LEWIS BROTHERS MFG. INC.**

BAXLEY, GA.

OPERATION

SERIAL NO.

*Read Carefully*

1. Do not use machine in any house where boards, bricks, or metal are present.
2. Load machine by driving tractor in low or first gear.
3. Do not raise or alter in any way the tail gate.
4. Operate the machine as level as possible at all times.
5. After house is cleaned, wash machine with a water hose, when dry, thoroughly lubricate chains with light weight oil.
6. Do not use loading chain bars or unloading chain bars other than those furnished by dealer.
7. Grease idler sprockets with bushings twice daily, other bearings once every six months.

HK-100914

**HK-100914**



**HK-101669**

# PARTS

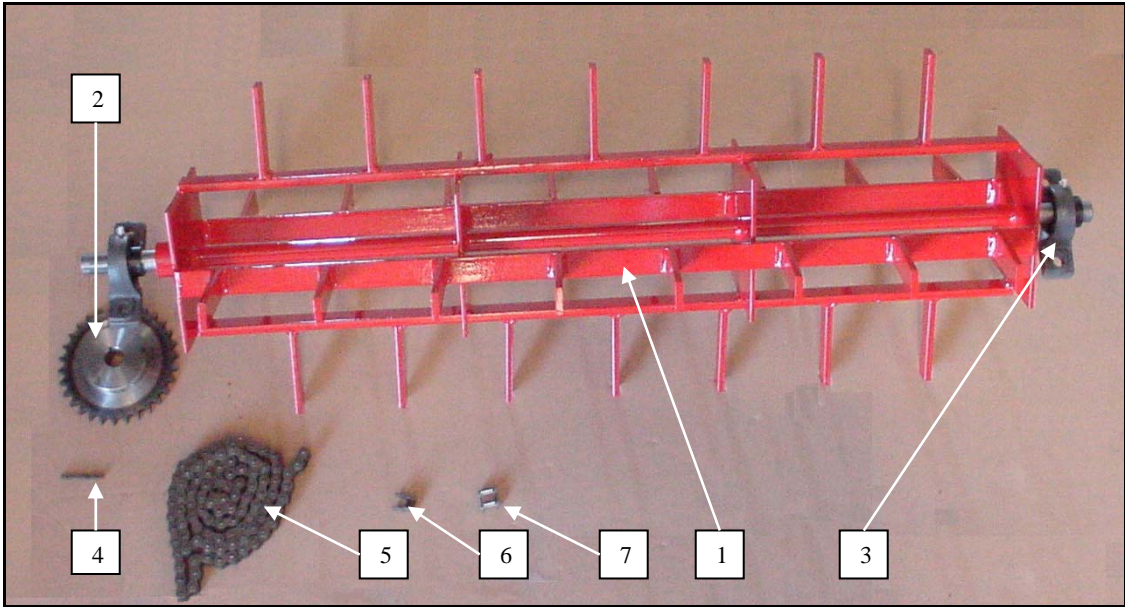

**Cylinder Reel**

Ref.	Part #	Description
1	HK-100386	Cylinder Reel
2	HK-100388	Sprocket
3	HK-100389	Bearing
4	HK-100495	Key 1/4" x 1/4" X 2-1/2"
5	HK-100445	Chain
6	HK101320	Offset Link
7	HK101270	Connecting Link

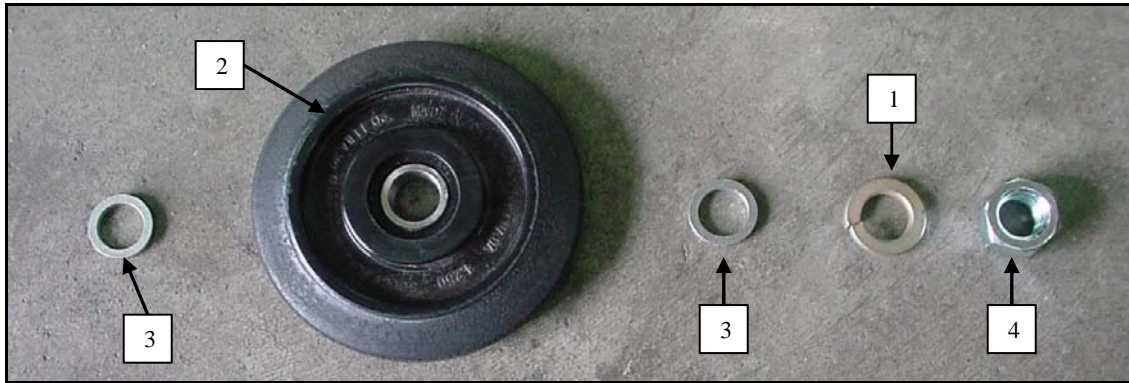

**Shaker Wheel Assembly**

Ref.	Part #	Description
1	001-1255	Washer, Lock
2	HK-101469	Shaker Wheel
3	HK-100961	Shim
4	HW-300212ZG5	Nut, 5/8"-11NC



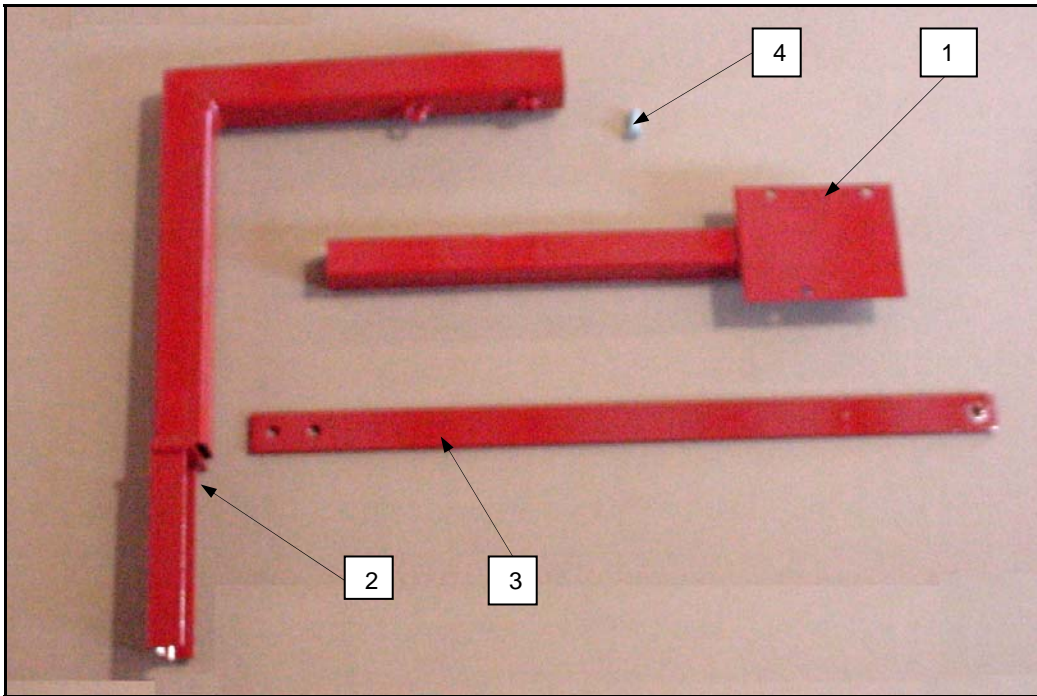

**Gooseneck**

<b>Ref.</b>	<b>Part #</b>	<b>Description</b>
1	HK-100014	Control Valve Mount
2	HK-100339	Gooseneck
3	HK-100372	Support
4	HW-208106G5Z	Bolt, HH, ZP, 1/2"-13NC x 1-1/4"

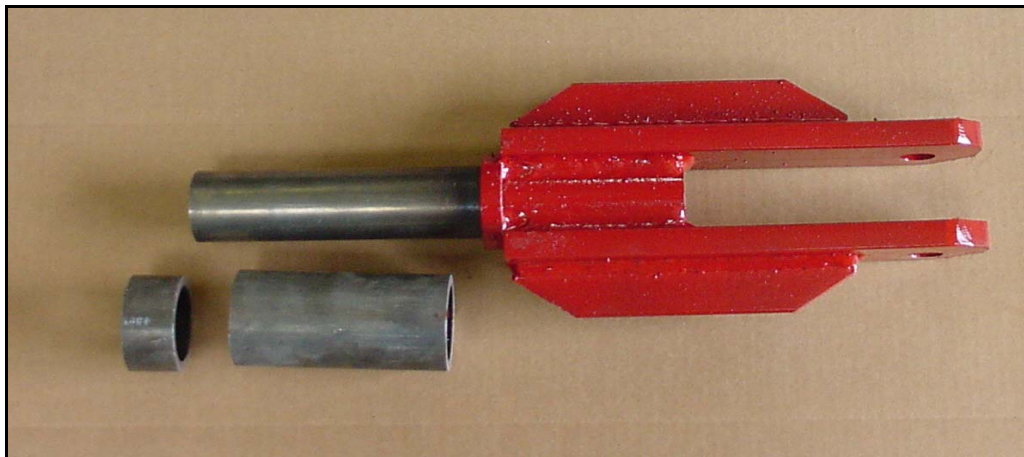

**Hitch Repair Kit    HK-101505**

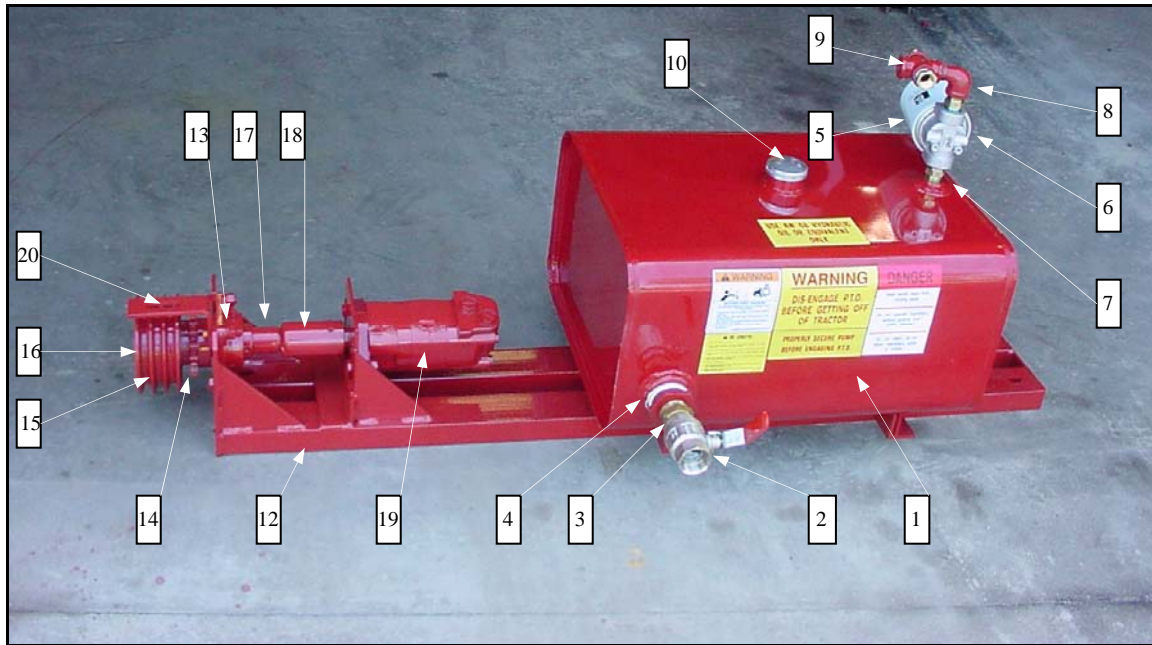

**Oil Tank Mount**

Ref.	Part #	Description
1	HK-100414	Tank
2	HK-100777	Ball Coupling
3	HK-100776	Nipple
4	HK-100778	Tank Strainer
5	HK-100721	Filter
6	HK-100722	Filter Assembly
7	HK-100772	¾ Hydraulic Nipple
8	HK-100775	Elbow
9	HK-100773	Cross
10	HK-100422	Cap
11	HK-100421	Cap Assembly (not shown)
12	HK-100940	Oil Tank and Cylinder Motor Mount
13	HK-100464	Flange Bearing
14	HK-100563	Sprocket
15	HK-100428	Pulley
16	HK-101224	Key (5/16" x 5/16" x 4")
17	HK-100564	Spacer
18	HK-100560	Shaft Coupling
19	HK-100589	Hydraulic Motor
20	HK-100946	Guard Mount

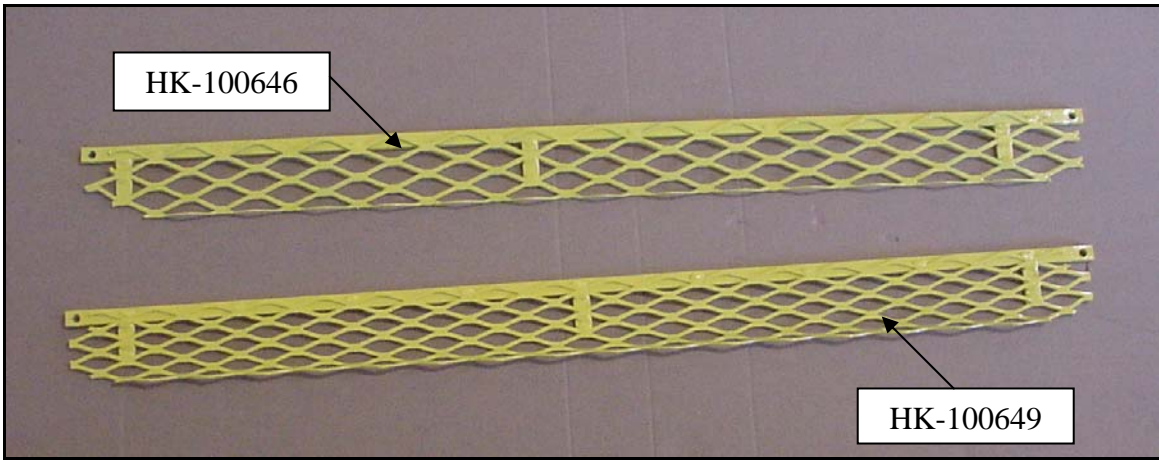

**Loading Bars**

<b>Part #</b>	<b>Description</b>	<b>Quantity</b>
<b>HK-101275</b>	<b>1" Shaker Bar Kit Complete</b> (not shown)	<b>1</b>
HK-100649	1" Mesh Shaker Bar (No Peg)	23
HK-100650	1" Mesh Shaker Bar (4 Peg) (not shown)	11
HK-100651	1" Mesh Shaker Bar (5 Peg) (not shown)	11
<b>HK-101276</b>	<b>1-1/2" Shaker Bar Kit Complete</b>	<b>1</b>
HK-100646	1-1/2" Mesh Shaker Bar (No Peg)	23
HK-100647	1-1/2" Mesh Shaker Bar (4 Peg) (not shown)	11
HK-100648	1-1/2" Mesh Shaker Bar (5 Peg) (not shown)	11
<b>HK-101277</b>	<b>Solid Bar Kit Complete</b> (not shown)	<b>1</b>
HK-101860	Solid Bar	45



**Solid Bar    HK-101860**

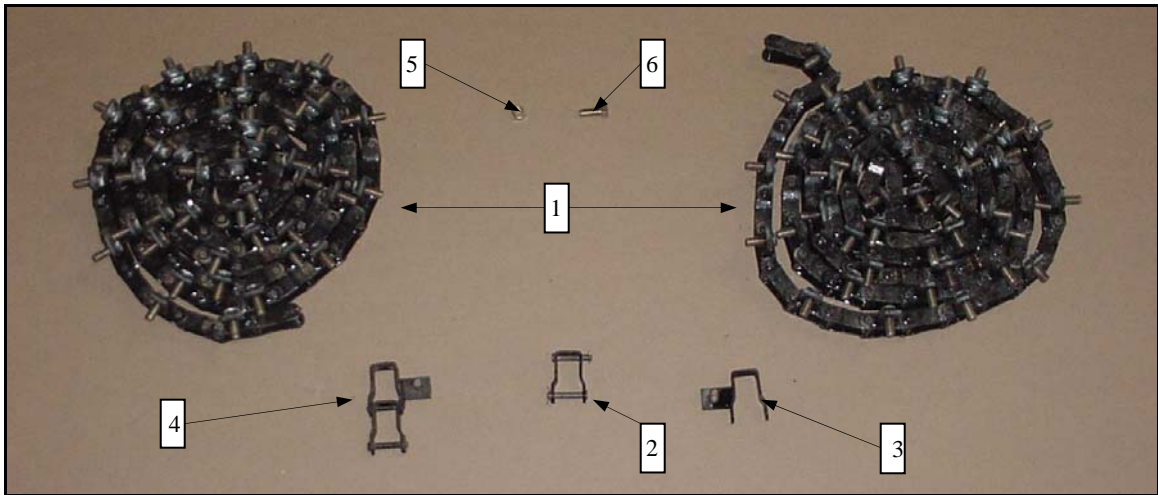

**Loading Chain Assembly**

<b>Ref.</b>	<b>Part #</b>	<b>Description</b>
1	HK-101348	Loading Chain Complete w/ Bolts Left & Right
2	HK-100661	Loading Chain Link W/ Pin
3	HK-100662	Loading Chain Bar Attaching Link (R.H.)
4	HK-100663	Loading Chain Bar Attaching Link (L.H.)
5	HW-301205L9	Nut, Stover Collar
6	HW-205104L9YZ	Bolt, L9 (3/8" x 1")

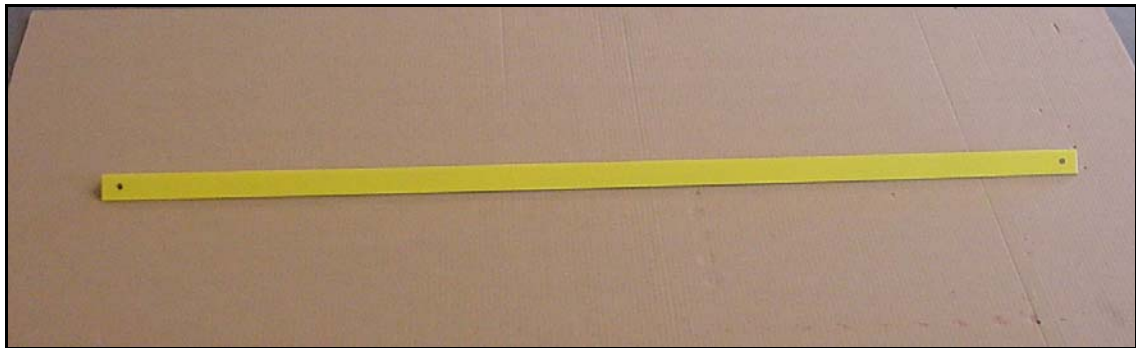

**Leveling Conveyor Bar      HK-100664**

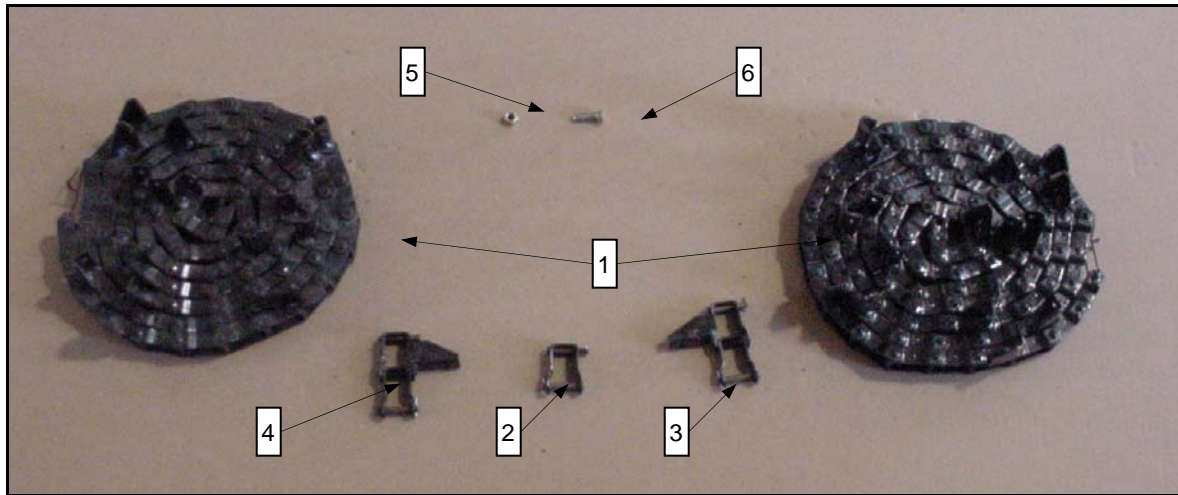

**Leveling Chain**

Ref.	Part #	Description
1	02-101346	Leveling Chain Complete
2	HK-100661	Leveling Conveyor Chain Link
3	HK-100667	Leveling Chain Attach Link (R.H.)
4	HK-100668	Leveling Chain Attach Link (L.H.)
5	HW-301203L9	Nut, Stover Collar
6	HW-203104L9YZ	Bolt, L9 (5/16" x 1")



**Unloading Chain**

Ref.	Part #	Description
1	HK-100674	Unloading Bar W/ Link
2	HK-100671	Unloading Conveyor Chain Link
3	ULB1071	Link Pin
4	HK-101344	Unloading Chain Complete (not shown)

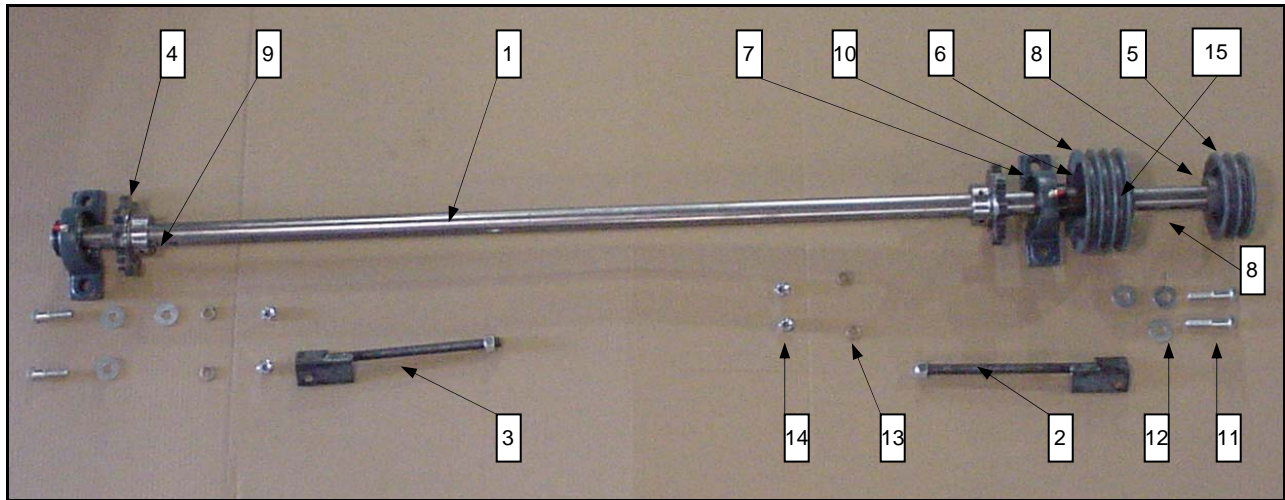

**Upper Belt Loading Conveyor Shaft Assembly**

Ref.	Part #	Description
1	HK-100425	Top Loading Shaft
2	HK-100573	Loading Adjustment Rod (L.H.)
3	HK-100572	Loading Adjustment Rod (R.H.)
4	HK-100426	Sprocket (Up To Serial # 5470)
4	HK-101660	Sprocket (Serial # 5470 & Up)
5	HK-100427	Pulley
6	HK-100428	Pulley
7	HK-100429	Bearing Assembly
8	HK-100496	Key 5/16" x 5/16" x 2-1/2"
9	HK-100496	Key 5/16" x 5/16" x 2-1/2"
10	HK-100564	Spacer
11	HW-208116G5Z	Bolt, Hh, Zp, 1/2"-13nc x 2-1/2", Gr5
12	HW-325208Z	Washer, Flat, 1/2" Zp
13	HW-335208Z	Washer, Lock, 1/2" Zp
14	HW-300208ZG5	Nut, Hex, 1/2"-13nc, Zp, Gr5
15	HK-100947	Belt, Loading

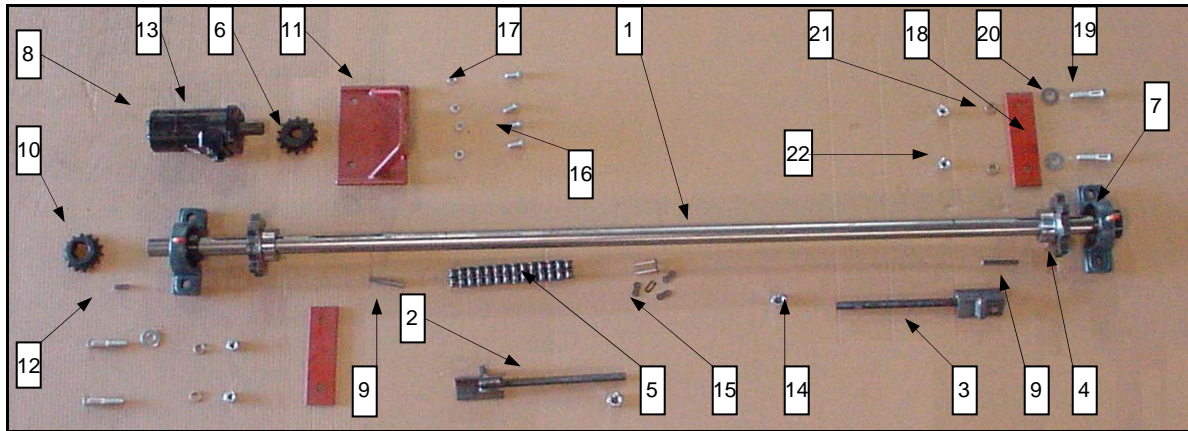

**Upper Hydraulic Loading Conveyor Shaft Assembly**

<b>Ref.</b>	<b>Part #</b>	<b>Description</b>
1	HK-100511	Top Loading Shaft
2	HK-100581	Loading Adjustment Rod (L.H.)
3	HK-100582	Loading Adjustment Rod (R.H.)
4	HK-100426	Sprocket (Up To Serial # 5470)
4	HK-101660	Sprocket (Serial # 5470 & Up)
5	HK-100482	Coupling Chain
6	HK-100480	Sprocket
7	HK-100429	Bearing Assembly
8	HK-100512	Hydraulic Motor
9	HK-100496	Key, 5/16" x 5/16" x 2-1/2"
10	HK-100479	Sprocket
11	HK-100590	Loading Motor Mount
12	HK-100497	Key 5/16" x 5/16" x 1"
13	HK-101659	Woodruff Key
14	HW-300212ZG5	Nut, Gr5, 5/8"-11nc, ZP
15	LVHK1011008C	Connection Link, Double Row Chain
16	HW-204103G5Z	Bolt, HH, ZP, 3/8"-16nc x 7/8", Gr5
17	HW-335204Z	Washer, Lock, 3/8" ZP
18	05-100836	Slide
19	HW-208116G5Z	Bolt, HH, ZP, 1/2"-13nc x 2-1/2"
20	HW-325208Z	Washer, Flat, 1/2", ZP
21	HW-335208Z	Washer, , Lock, 1/2", ZP
22	HW-300208ZG5	Nut, Hex, Gr5, 1/2"-13nc, ZP

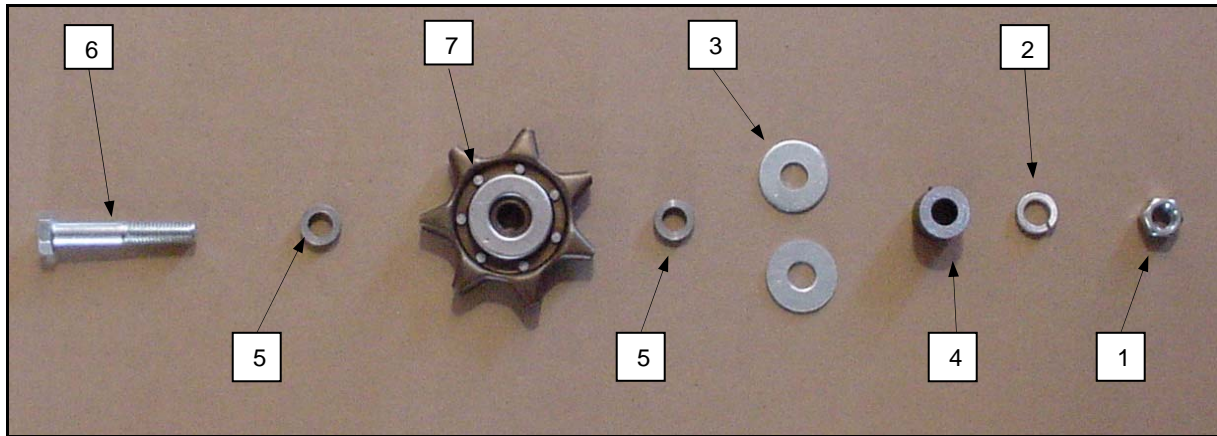

**Lower Loading Conveyor Idler Sprocket Assembly**

<b>Ref.</b>	<b>Part #</b>	<b>Description</b>
1	HW-300212ZG5	Nut, ZP, 5/8"-11nc, Gr5
2	HW-335212Z	Washer, Lock 5/8" ZP
3	HW-325212Z	Washer, Flat, 5/8" ZP
4	HK-101088	Loading Idler Spacer
5	HK-100491	Spacer
6	HW-212132G5Z	Bolt, ZP, 5/8"-11nc x 4-1/2"
7	HK-100492	Idler



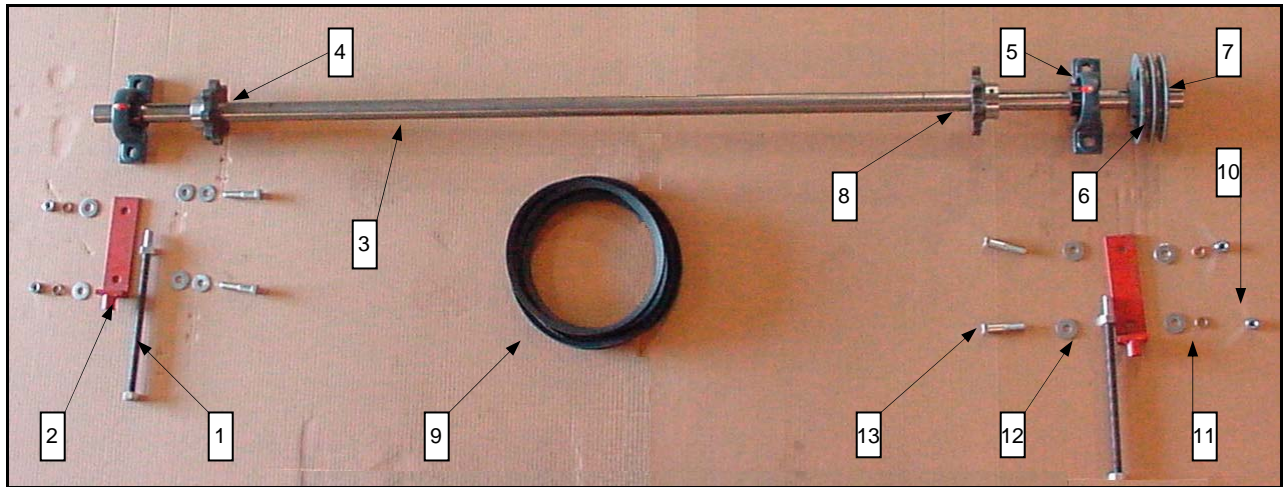

**Belt Leveling Conveyor Shaft Assembly**

Ref.	Part #	Description
1	HK-101264	Leveling Tensioning Rod
2	05-100835	Adjustment Bracket
3	HK-100431	Leveling Shaft
4	HK-100426	Sprocket
5	HK-100429	Bearing Assembly
6	HK-100432	Pulley
7	HK-100496	Key 5/16" x 5/16" x 2-1/2"
8	HK-100498	Key 5/16" x 5/16" x 3-1/2"
9	HK-100948	Leveling Drive Belt
10	HW-300208ZG5	Nut, Hex, 1/2"-13 NC, ZP
11	HW-335208Z	Washer, Lock 1/2" ZP
12	HW-325208Z	Washer, Flat, 1/2" ZP
13	HW-208116G5Z	Bolt, HH, ZP, 1/2"-13nc x 2-1/2" Gr-5

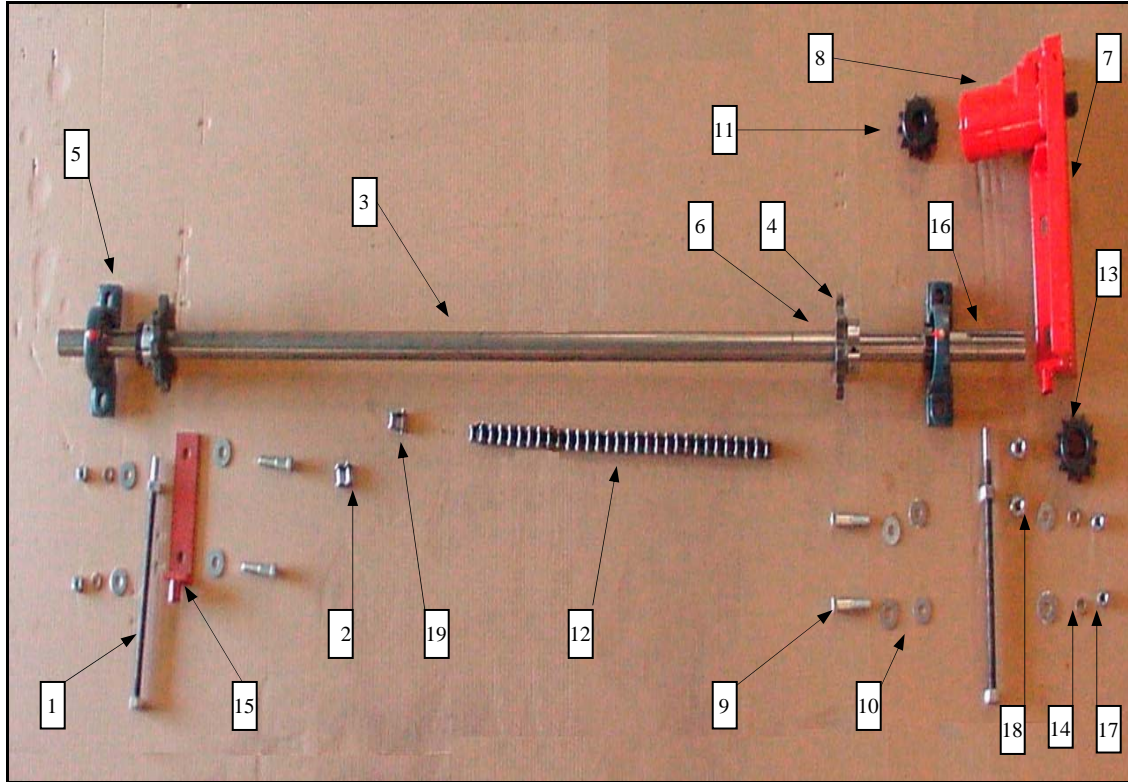

**Hydraulic Leveling Conveyor Shaft Assembly**

Ref.	Part #	Description
1	HK-101264	Leveling Tensioning Rod
2	HK-101270	Connection Link
3	HK-100518	Leveling Shaft
4	HK-100426	Sprocket
5	HK-100429	Bearing Assembly
6	HK-100498	Key (5/16" x 5/16" x 3-1/2")
7	05-100800	Leveling Motor Mount
8	HK-100513	Hydraulic Motor
9	HW-208116G5Z	Bolt, HH, ZP, 1/2"-13nc x 2-1/2" Gr-5
10	HW-325205Z	Washer, Flat, 1/2" ZP
11	05-100832	Sprocket
12	HK-101229	Leveling Drive Chain
13	HK-101230	Sprocket
14	HW-335208Z	Washer, Lock, 1/2" ZP
15	05-100835	Adjustment Bracket
16	HK-100497	Key 5/16" x 5/16" x 1"
17	HW-300208ZG5	Nut, Hex, 1/2"-13nc ZP
18	HW-300212ZG5	Nut, Hex, 5/8"-11nc,ZP
19	HK-101320	Link, Offset

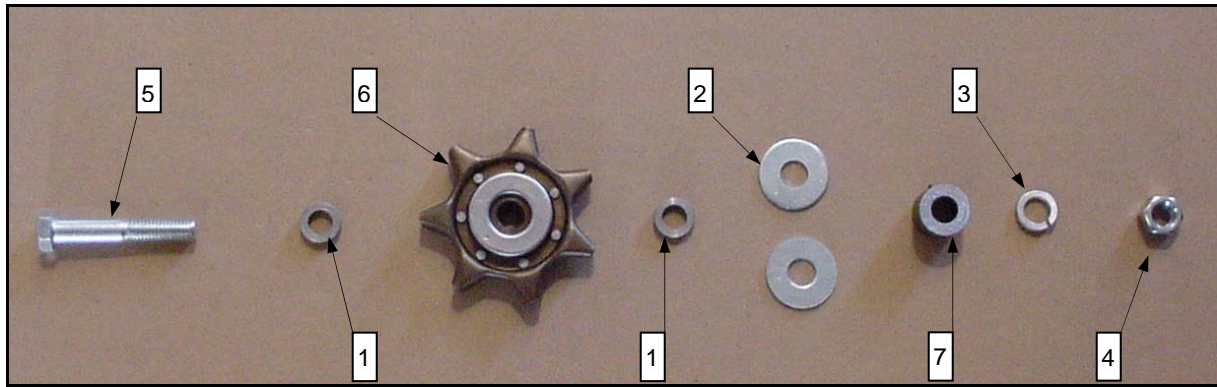

**Leveling Idler Sprocket Assembly**

Ref.	Part #	Description
1	HK-100491	Spacer
2	HW-325212Z	Washer, Flat, 5/8" ZP
3	HW-335212Z	Washer, Lock, 5/8" ZP
4	HW-300212G5	Nut, 5/8"-11nc, ZP, Gr5
5	HW-212124G5Z	Bolt, HH, ZP, 5/8"-11nc x 3-1/2"
6	HK-100492	Idler
7	HK-101089	Leveling Idler Spacer

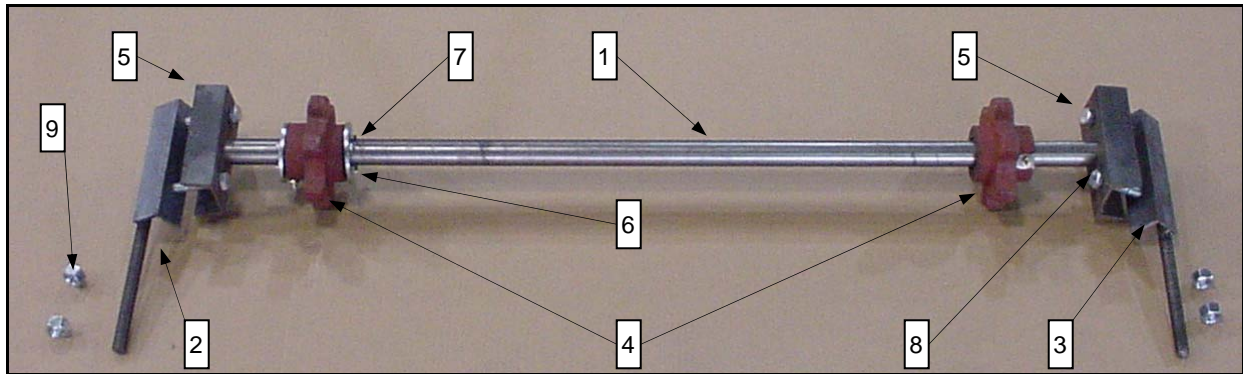

**Front Unloading Shaft Assembly**

Ref.	Part #	Description
1	02-100436	Front Unloading Shaft
2	HK-100586	Unloading Tensioning Rod (L.H.)
3	HK-100587	Unloading Tensioning Rod (R.H.)
4	02-100437	Sprocket
5	02-100438	Channel
6	HW-325222Z	Washer, Flat 1-1/8"
7	HW-426120	Pin, Cotter, 3/16" x 3"
8	HW-208120G5Z	Bolt, HH, ZP, 1/2"-13nc x 3" Gr5
9	HW-300208ZG5	Nut, Hex, 1/2"-13nc, ZP

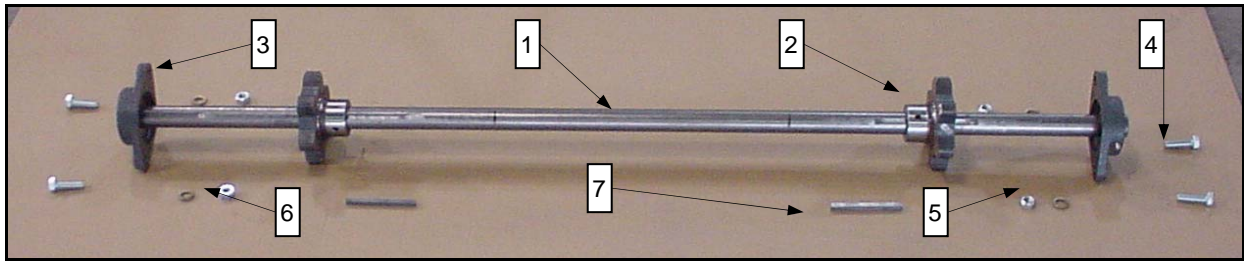

### Rear Unloading Shaft Assembly

Ref.	Part #	Description
1	02-100441	Shaft
2	02-100442	Sprocket
3	02-100444	Bearing
4	HW-208108G5Z	Bolt, HH, ZP, 1/2"-13nc x 1-1/2"
5	HW-300208ZG5	Nut, Hex, 1/2"-13nc, ZP
6	HW-335208Z	Washer, Lock, 1/2" ZP
7	HK-100498	Key 5/16" x 5/16" x 3-1/2"

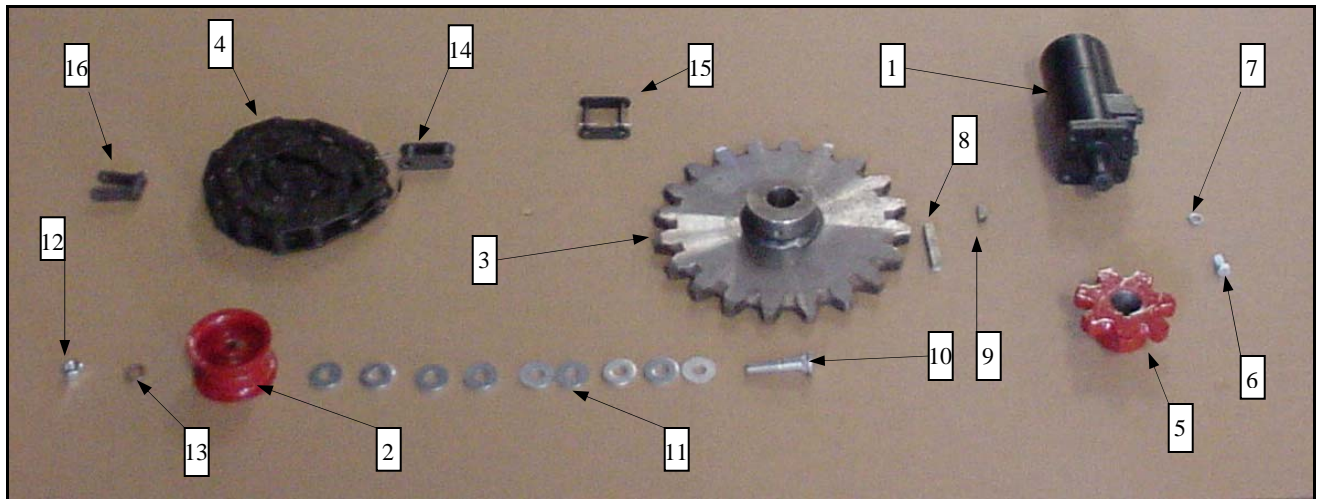

**Unloading Motor & Related Parts**

Ref.	Part #	Description
1	HK-100513	Unloading Motor
2	HK-101295	Idler
3	02-100443	Sprocket
4	02-101337	Drive Chain
5	HK-100433	Sprocket, Unloading Drive
6	HW-204103G5Z	Bolt, HH, ZP, 3/8"-16nc x 7/8"
7	HW-335204Z	Washer, Lock, 3/8" ZP
8	HK-100496	Key 5/16" x 5/16" x 2-1/2"
9	HK-101659	Woodruff Key
10	HW-808120G5Z	Bolt, Carriage ZP, 1/2"-13nc x 3", Gr5
11	HW-325208Z	Washer, Flat, 1/2"ZP
12	HW-300208ZG5	Nut, Hex, 1/2"-13nc, ZP
13	HW-335208Z	Washer, Lock, 1/2", ZP
14	RL550	Roller Link
15	HK-101297	Connecting Link
16	HK-101658	Offset Link

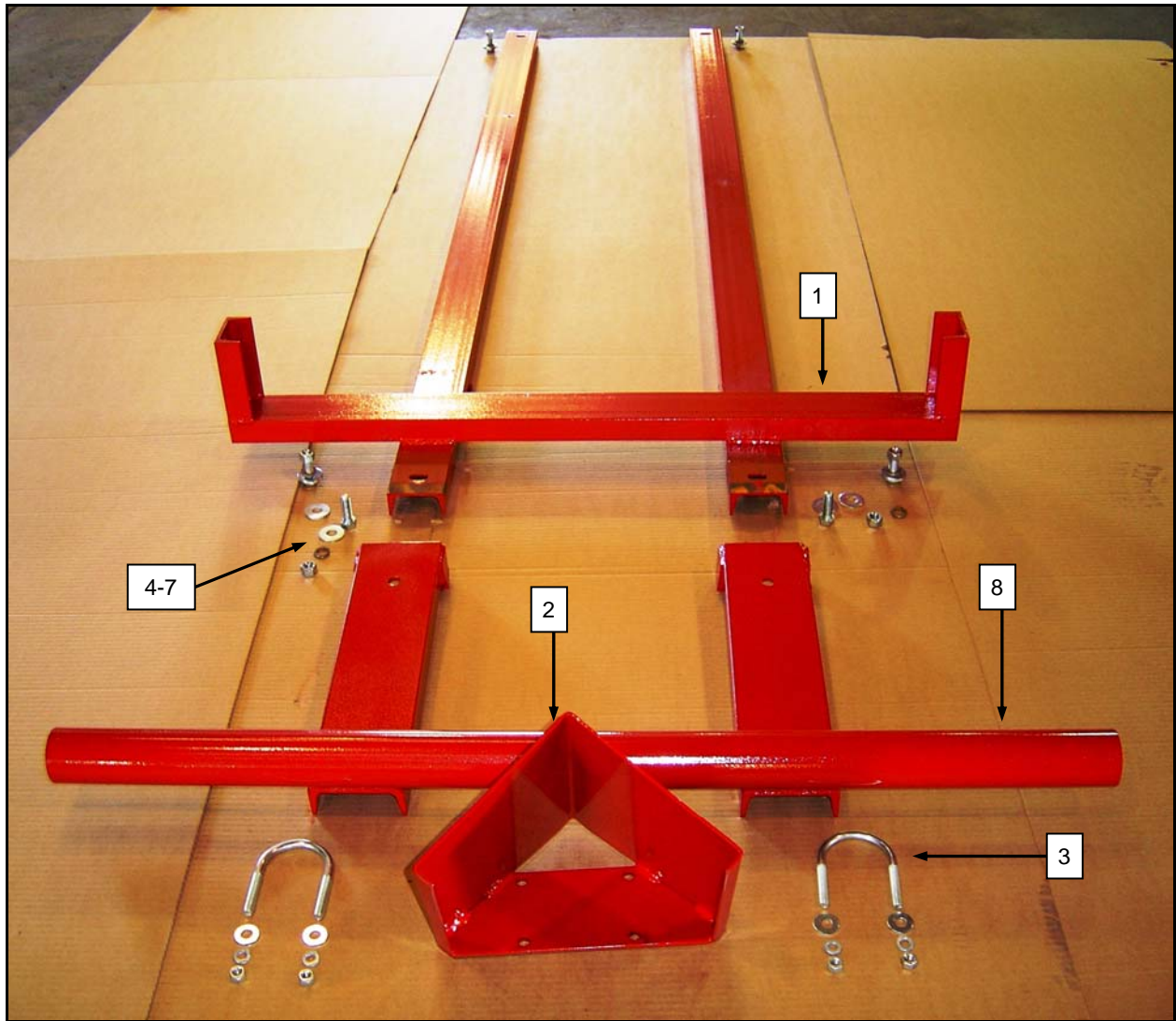

**Spinner Bumper Assembly**

Ref.	Part #	Description
1	HK-101817	Bumper, Front
2	HK-100015	Flow Divider Weldment
3	SP-200115	U-Bolt
4	HW-208108G5Z	Bolt, HH, Sp, 1/2"-13nc x 1-1/2", Gr5
5	HW-325208Z	Washer, Flat, 1/2" ZP USS Std
6	HW-335208Z	Washer, Lock, 1/2" ZP
7	HW-300208ZG5	Nut, Hex, 1/2"-13nc , ZP
8	HK-101818	Bumper, Rear

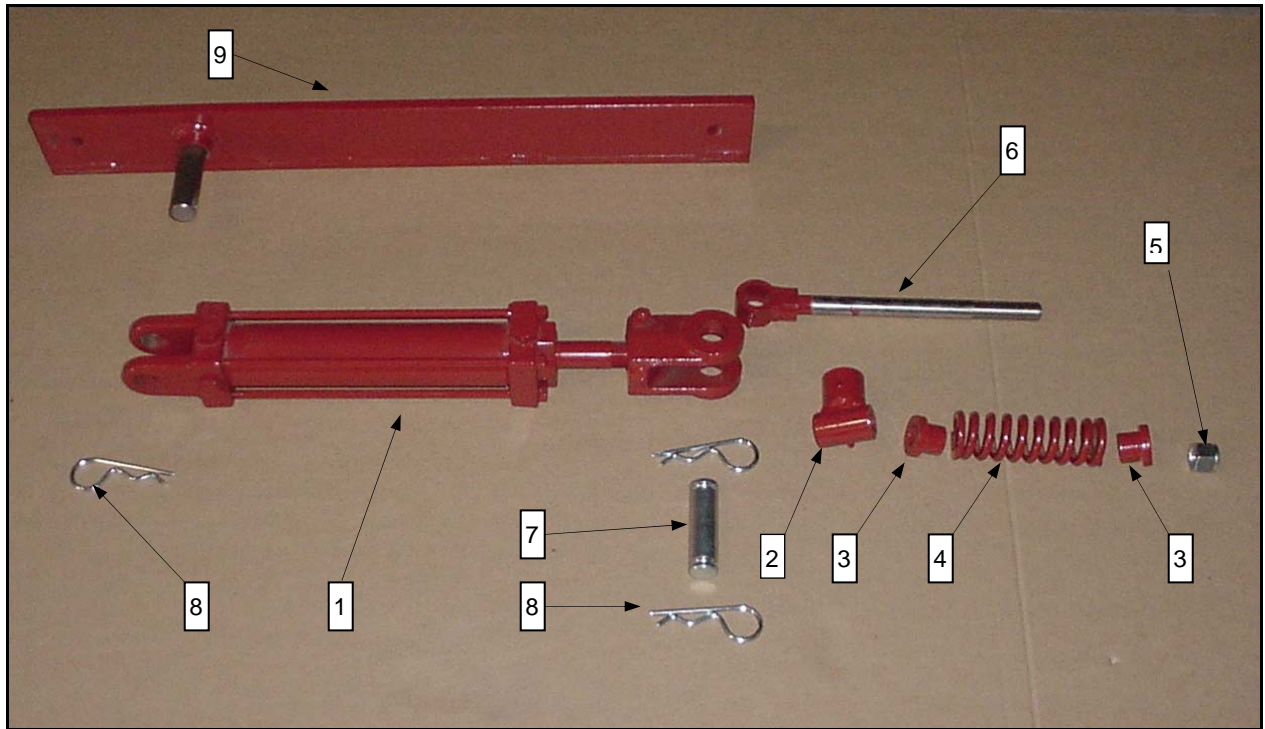

**Hydraulic Tailgate Actuator Assembly**

<b>Ref.</b>	<b>Part #</b>	<b>Description</b>
1	HK-100700	Hydraulic Cylinder
2	HK-100702	Swivel Knuckle Bracket
3	HK-100703	Spring Bushing
4	HK-100704	Spring
5	HW-301216NEZ	3/4" Nylon Lock Nut
6	HK-100705	Bracket
7	HK-101307	Hydraulic Cylinder Pin
8	HK-101254	Hair Pin
9	HK-100895	Tailgate Cylinder Mount

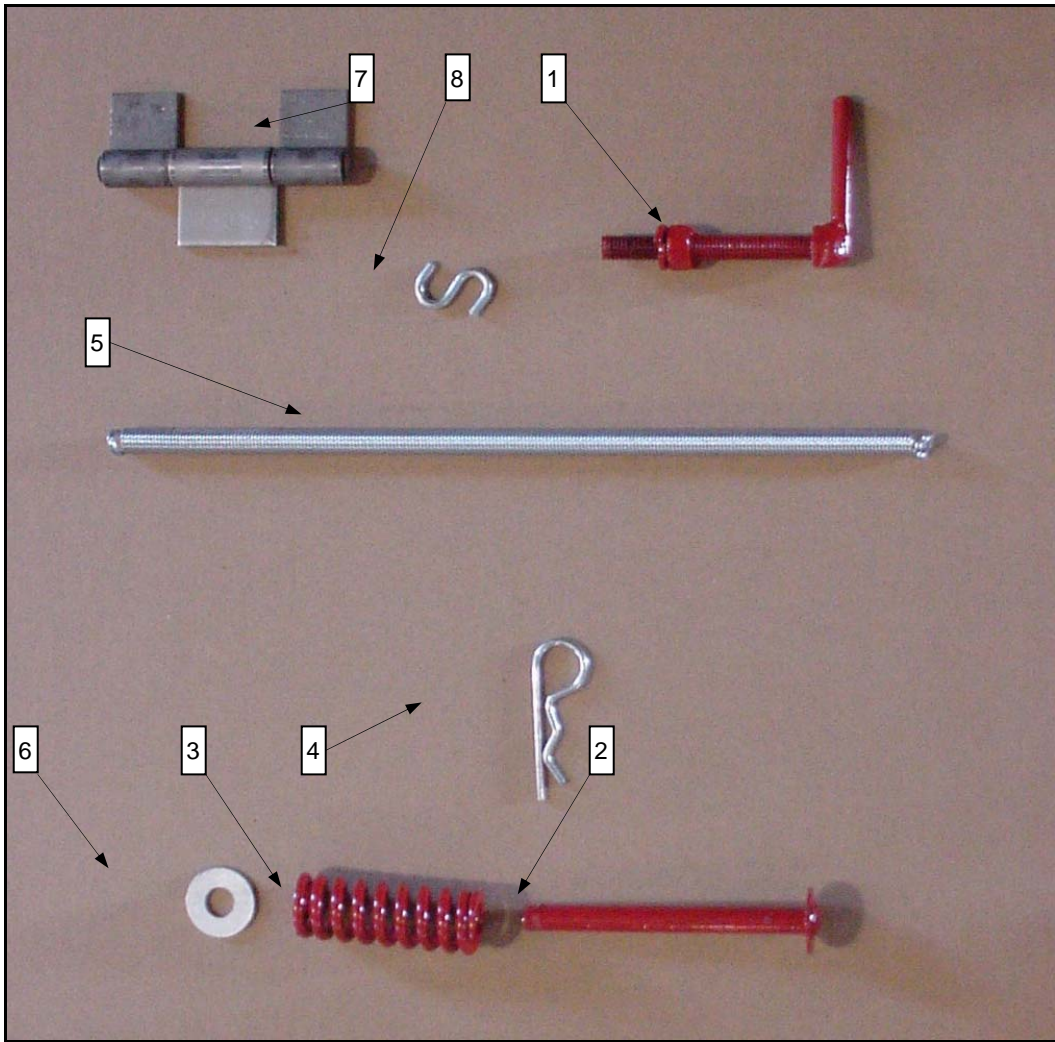

**Tailgate Related Parts**

<b>Ref.</b>	<b>Part #</b>	<b>Description</b>
1	HK-100952	Tailgate Attach Bolt
2	HK-100725	Pin
3	HK-100726	Spring
4	HK-101458	Hairpin
5	HK-100717	Tailgate Spring
6	HW-325208Z	Washer, Flat, 1/2" ZP
7	HK-100080	Hinge
8	02-100265	S-Link



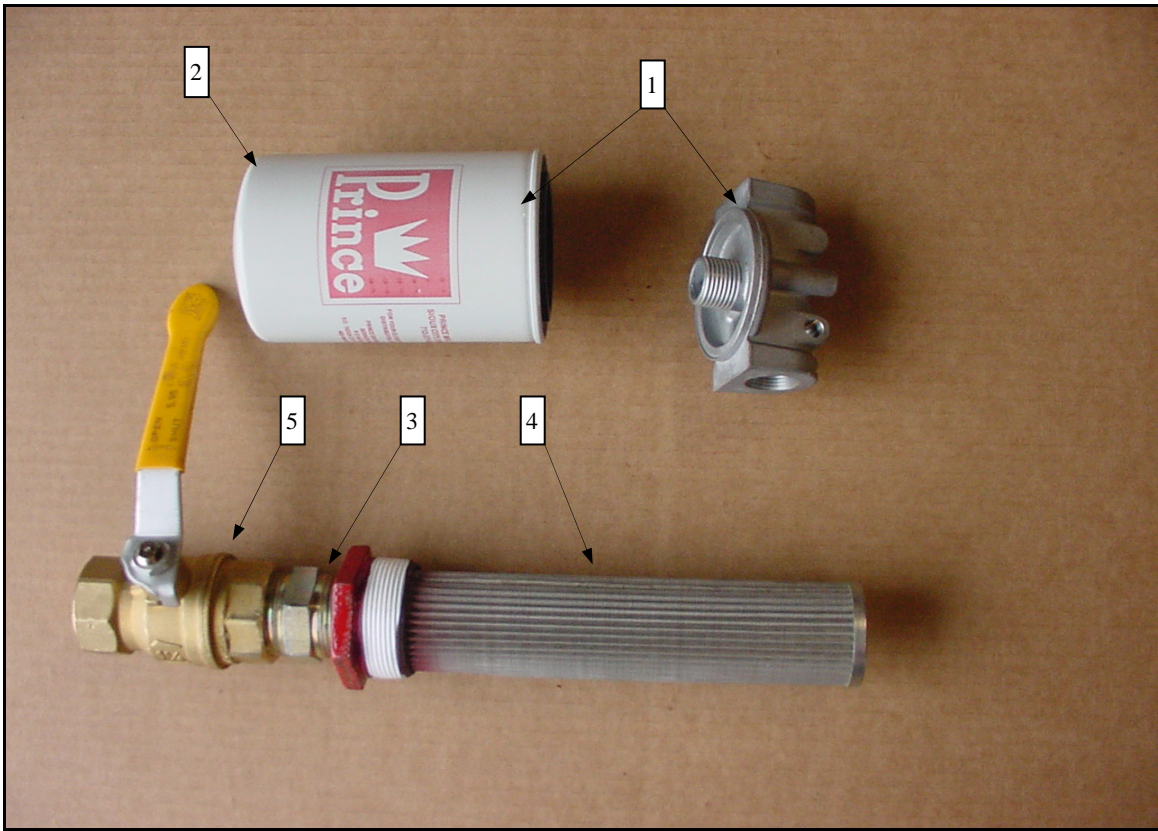

**Tank Filter & Related Parts**

<b>Ref</b>	<b>Part #</b>	<b>Description</b>
1	HK-100722	Filter Assy.
2	HK-100721	Filter
3	HK-100776	Nipple
4	HK-100778	Tank Strainer
5	HK-100777	Ball Valve

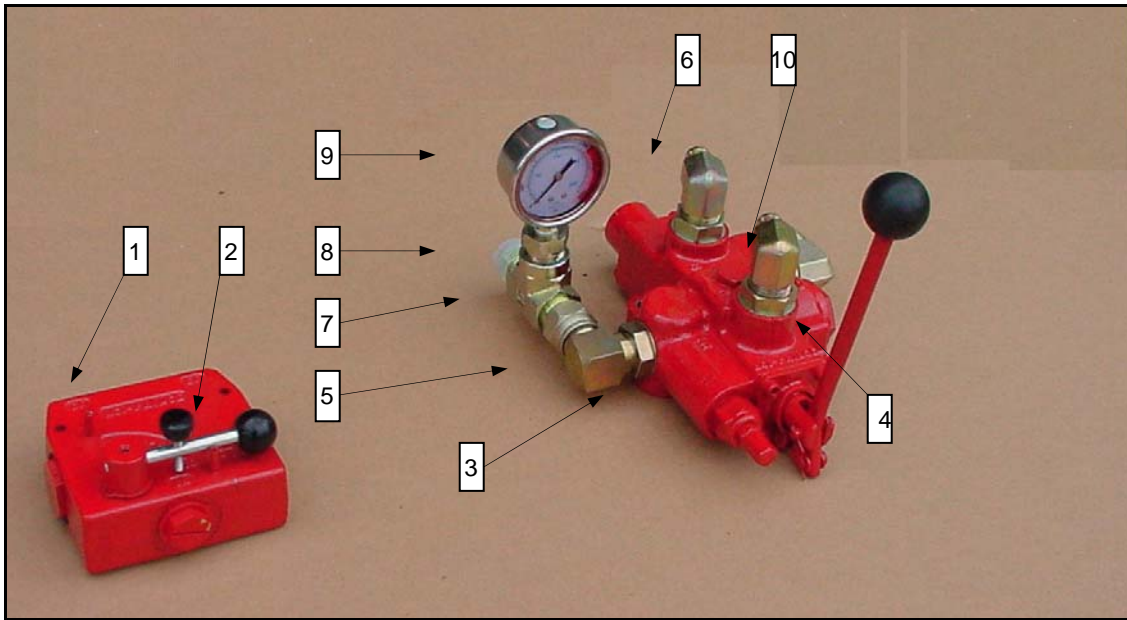

**Control Valve & Variable Speed Valve**

Ref.	Part #	Description
1	HK-100696	Variable Speed Valve
2	H1071	Handle
3	HK-101515	Control Valve
4	6601500004	Valve Handle
5	HK-101633	90° Elbow 12MB - 12FJX
6	HK-101629	90° Elbow 12MB - 8MJ
7	HK-101634	Tee 12FP - 12MJ - 12MJ
8	HK-101439	Bushing 12MP - 4FP
9	HK-101591	Gauge
10	HK-101578	90° Elbow 12MB - 12MJ

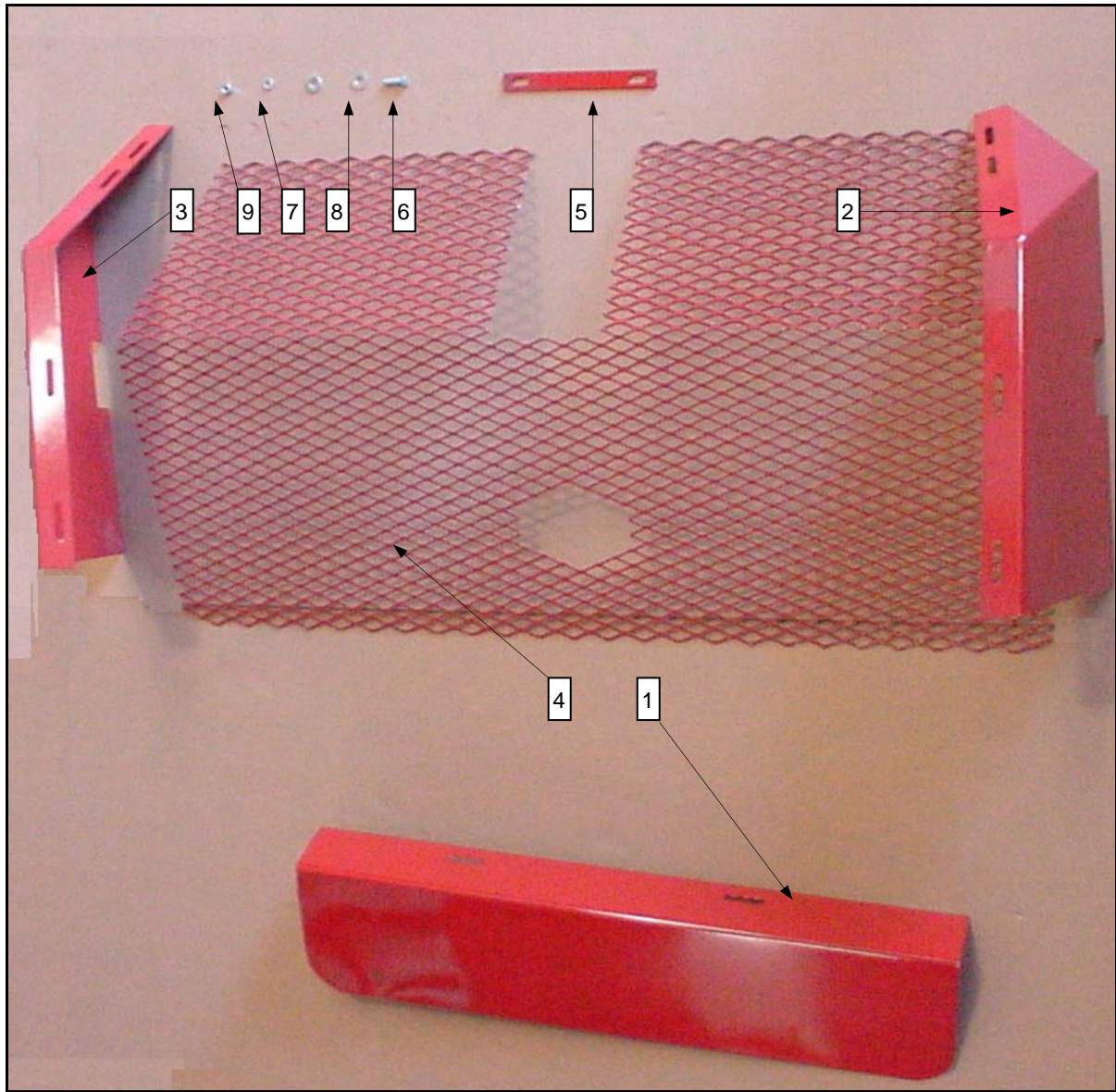

**Guards**

<b>Ref.</b>	<b>Part #</b>	<b>Description</b>
1	HK-100405	Cylinder Chain Guard
2	HK-100694	Cylinder Guard (R.H.)
3	HK-100693	Cylinder Guard (L.H.)
4	HK-100688	Cylinder Front Cover
5	HK-101007	Cylinder Guard Tie
6	HW-204106G5Z	Bolt, HH, ZP., 3/8"-16nc x 1-1/4"
7	HW-335204Z	Washer, Lock, 3/8"
8	HW-325204Z	Washer, Flat, 3/8"
9	HW-300204ZG5	Nut, Hex, 3/8-16nc, ZP

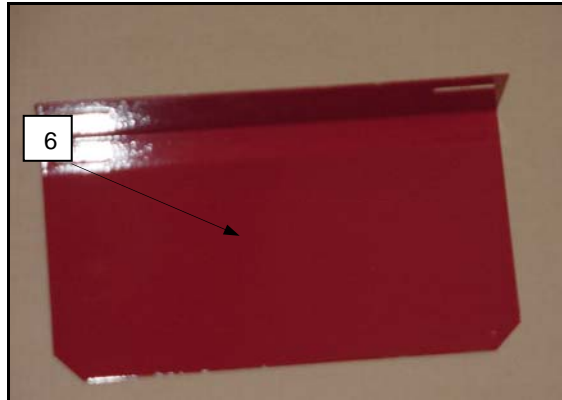
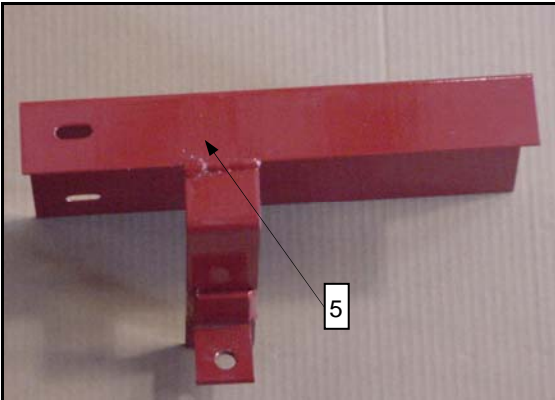
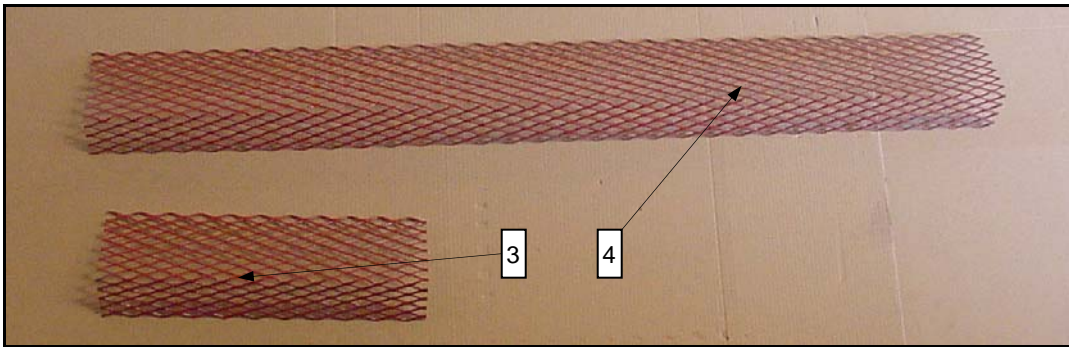
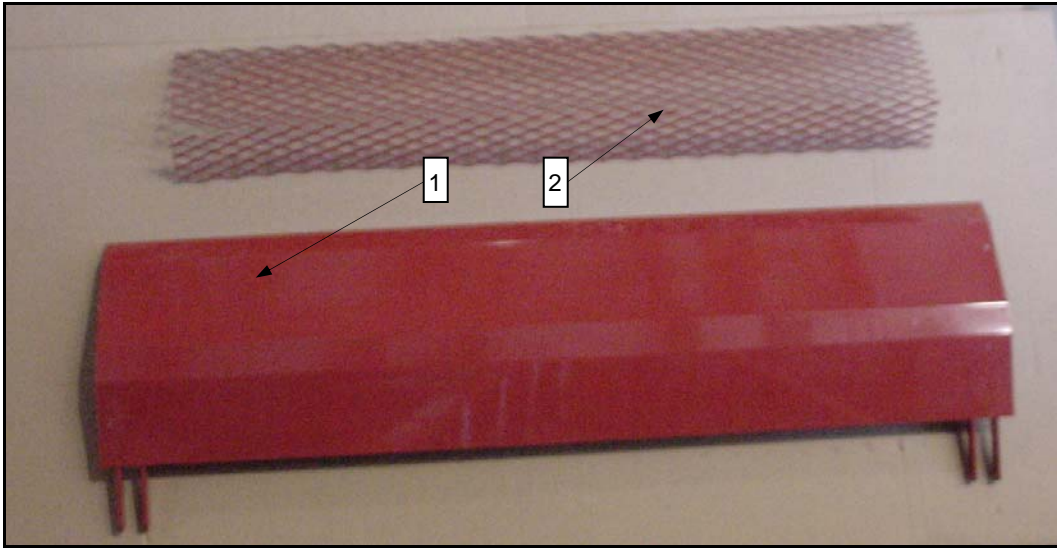

Ref.	Part #	Description
1	02-100390	Top Shield
2	HK-101360	Loading Belt Cover
3	HK-101357	Leveling Belt Inside Cover
4	HK-101358	Leveling Belt Outside Cover
5	HK-100394	Rear Leveling Belt Guard
6	HK-101263	Hydraulic Leveling Drive Chain Guard (Hyd. Unit)

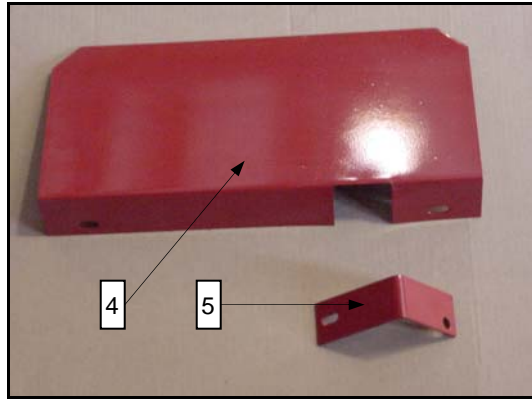
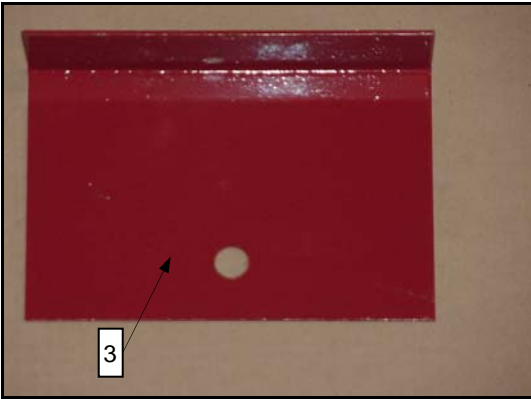
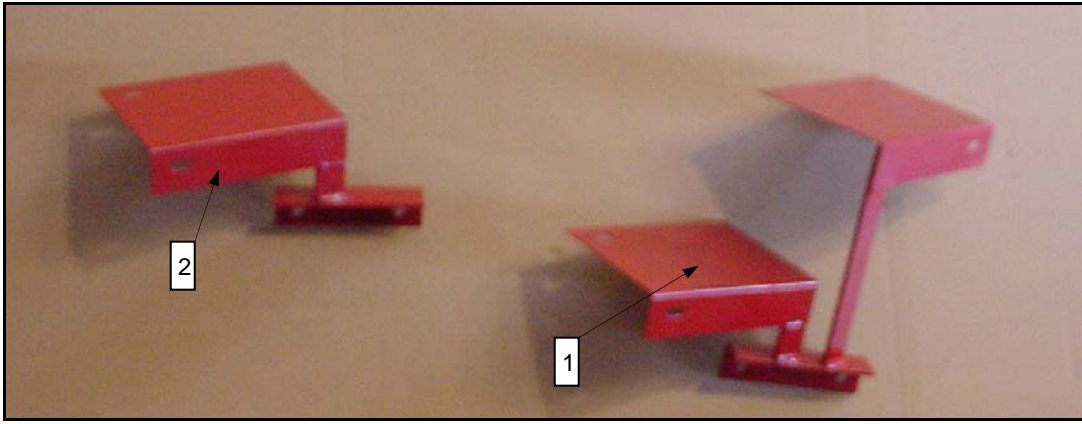

Ref.	Part #	Description
1	HK-100023	Loading And Leveling Belt Guard
2	HK-101449	Loading Belt Guard
3	HK-101036	Front Leveling Chain Guard
4	02-100404	Unloading Chain Guard
5	02-100690	Unloading Chain Guard Mount Bracket

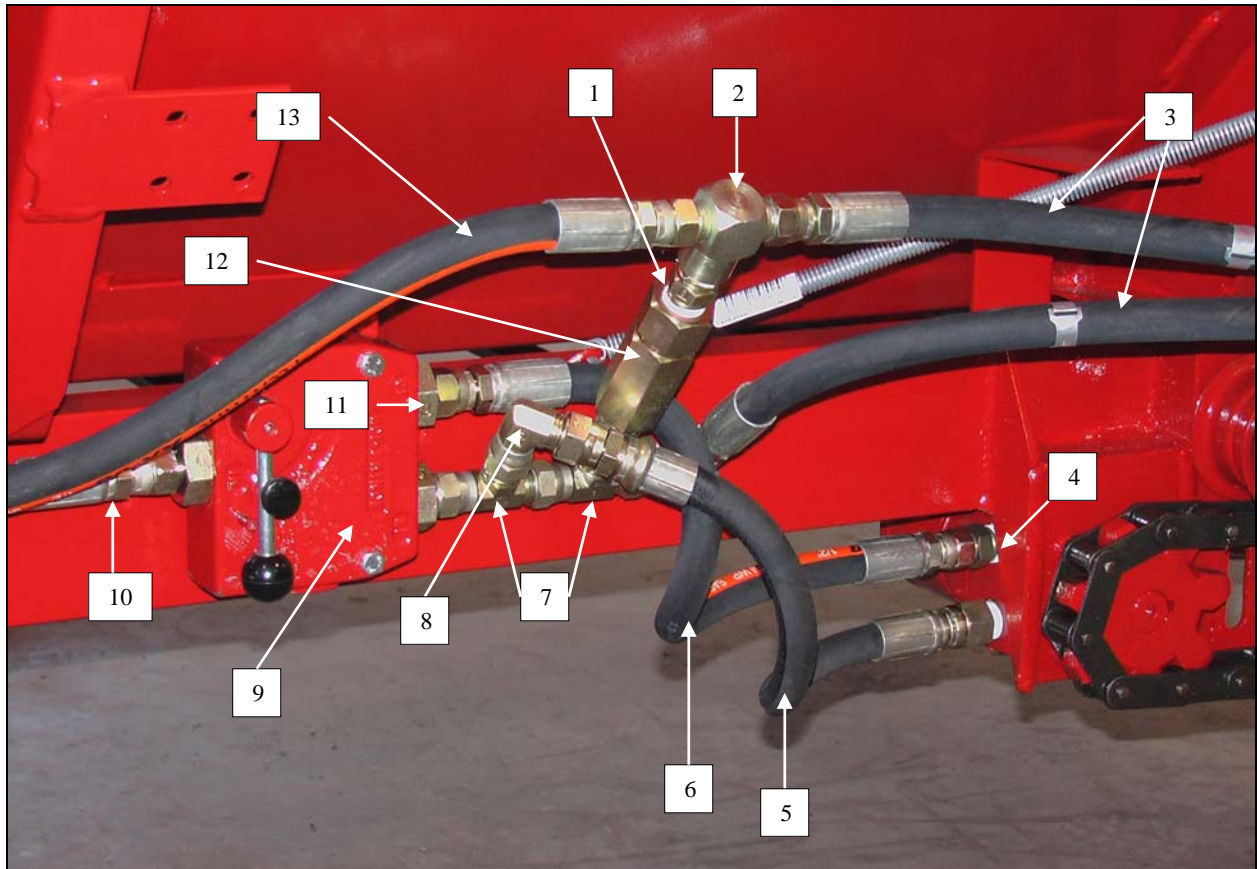

**Hydraulic Hoses**

Ref.	Part #	Description
1	HK-100963	Nipple, ½" X ½"
2	HK-101712	Hyd. Tee, 8 MJIC X 8 MJIC X 8 FP
3	HK-101705	Hyd. Hose, Variable Speed Valve To Spinner Motor
4	HK-101717	Nipple, 8 MJ X 8 MP
5	HK-101707	Hyd. Hose, Variable Speed Valve To Unloading Motor
6	HK-101706	Hyd. Hose, Variable Speed Valve To Unloading Motor
7	HK-101711	Hyd. Tee, 8 MJIC X 8 MJIC X FJIC
8	HK-101718	Hyd. Elbow, 90° 8 MJ X 8 FJ
9	HK-100695	Variable Speed Valve
10	HK-101701	Hyd. Hose, Control Valve To Variable Speed Valve
11	HK-101713	Hyd. Adapter, 8 MJ X 12 MOR
12	HK-100716	Check Valve
13	HK-101702	Hyd. Hose, Variable Speed Valve To Tank (Return Hose)

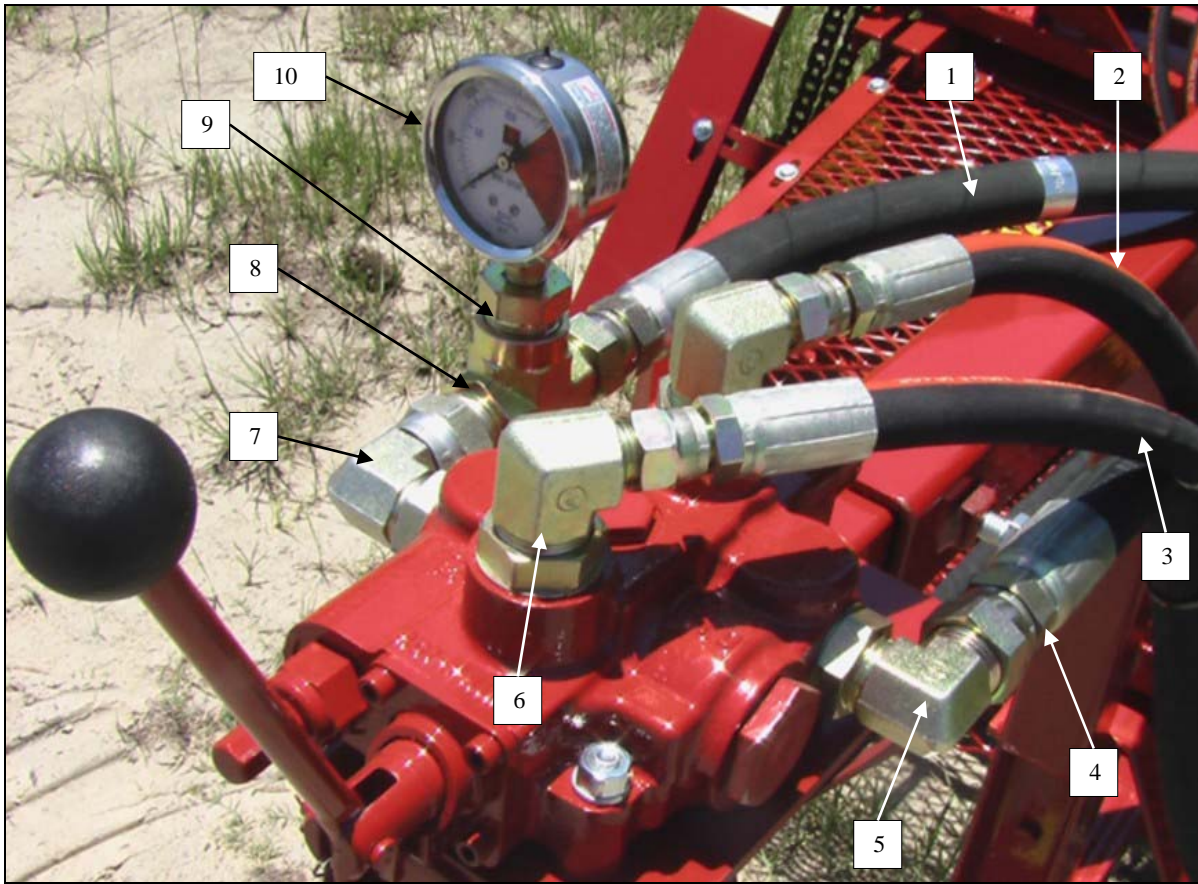

Ref.	Part #	Description
1	HK-101709	Hyd. Hose, Pump To Control Valve
2	HK-101703	Hyd. Hose, Control Valve To Cylinder Motor
3	HK-101701	Hyd. Hose, Control Valve To Variable Speed Valve
4	HK-101708	Hyd. Hose, Control Valve To Tank
5	HK-101578	Hyd. Elbow, 90° 12 MJIC X 12 ORB
6	HK-101629	Hyd. Elbow, 90° 8 MJ X 12 NWO
7	HK-101633	Hyd. Elbow, 90° 12 FJIC X 12 M Boss
8	HK-101634	Hyd Tee, 12 MJIC X 12 MJIC X 12 FMP
9	HK-101439	Bushing, 3/4" X 1/4"
10	HK-101591	Gauge, 2-1/2" Liquid Fill

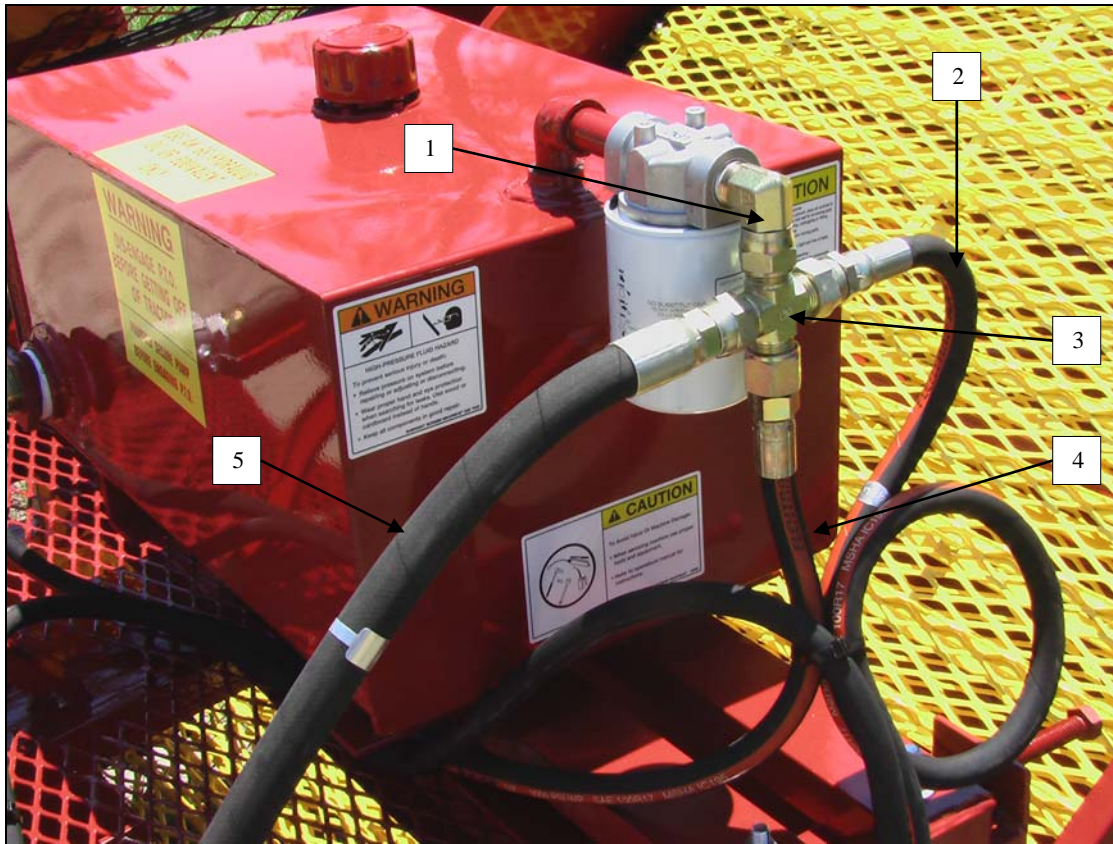

Ref.	Part #	Description
1	HK-101719	Hyd. Elbow, 90° 12 FJ X 12 MP
2	HK-101702	Hyd. Hose, Variable Speed Valve To Tank (Return Hose)
3	HK-101720	Cross, 3/4 MJIC
4	HK-101704	Hyd. Hose, Cylinder To Tank (Standard)
5	HK-101708	Hyd. Hose, Control Valve To Tank



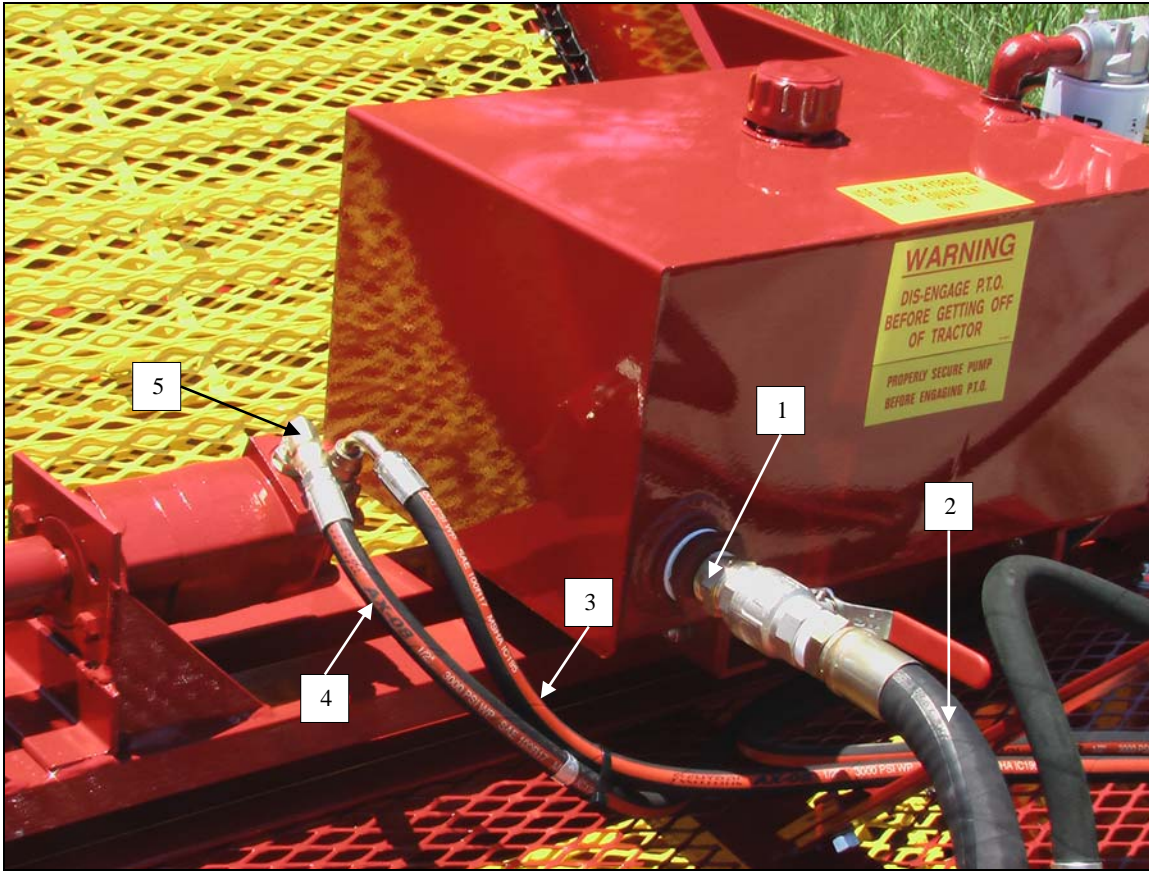

Ref.	Part #	Description
1	HK-100776	Nipple, 1-1/4 X 1-1/4
2	HK-101381	Hyd. Hose, Suction Hose
3	HK-101703	Hyd. Hose, Control Valve To Cylinder Motor
4	HK-101704	Hyd. Hose, Cylinder To Tank (Standard)
5	HK-101716	Hyd. Elbow, 90° X 8 MJ X 10 MOR

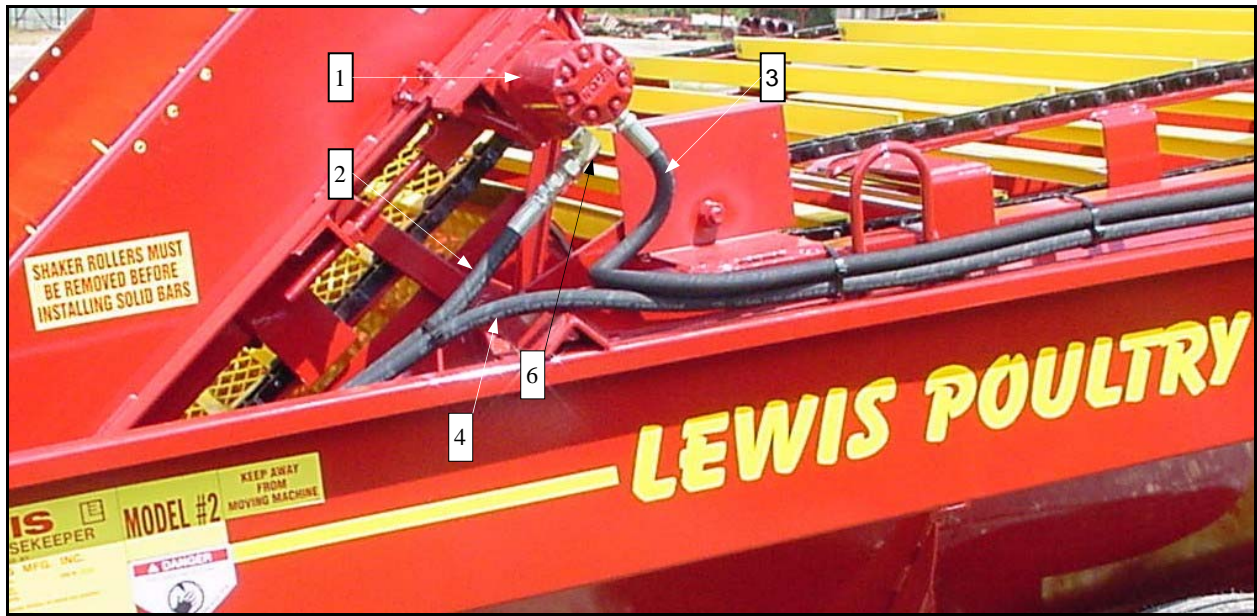

**Hydraulic Loading and Leveling**

Ref.	Part #	Description
1	HK-100512	Loading Motor
2	HK-101383	Hose, Cylinder Motor to Loading Motor
3	HK-101647	Hose, Loading Motor to Leveling Motor
4	HK-101415	Hose, Leveling Motor to Tank (return)
5	HK-101394	Hose, Cylinder Motor to Leveling Motor (not shown)
6	HK-100971	Hydraulic Fitting, 1/2" FPX x 1/2"M 90°
7	HK-100513	Leveling Motor (not shown)

## Fittings and Adapters



Ref.	Part #	Description
1	HK-100968	90° HYD. ELBOW, 16MOR X 20 FP
2	HK-101633	90° HYD. ELBOW, 12 FJ X 12 MORB
3	HK-101578	90° HYD. ELBOW, 12 MJIC X 12 ORB
4	HK-101718	90° HYD. ELBOW, 8 MJ X 8 FJ
5	HK-101629	90° HYD. ELBOW, 8 MJ X 12 MOR
6	HK-101716	90° HYD. ELBOW, 8 MJ X 10 MOR
7	HK-101713	HYD. ADAPTER, 8 MJ X 12 MOR
8	HK-101714	HYD. ADAPTER, 8 MJ X 10 MOR
9	HK-101439	BUSHING ¾ X ¼
10	HK-101717	HYD. NIPPLE, 8 MJ X 8 MP
11	HK-101719	90° HYD. ELBOW, 12 FJ X 12 MP
12	HK-101634	HYD. TEE, 12 MJIC X 12 MJIC X 12 FMP
13	HK-101711	HYD. TEE, 8 MJIC X 8 MJIC X 8 FJIC
14	HK-100776	HYD. NIPPLE, 20 M X 20 M
15	HK-101712	HYD. TEE, 8 MJIC X 8 MJIC X 8 FP
16	HK-100966	QUICK COUPLER KIT
17	HK-101720	CROSS ¾ MJIC
18	HK-101721	HYD. ADAPTER, SWIVEL 8 FJ X 8 MP
19	HK-100963	NIPPLE, 8 M X 8 M
20	HK-100993	PLUG, QUICK CONNECT, FEMALE
21	HK-100994	CAP, QUICK CONNECT, MALE

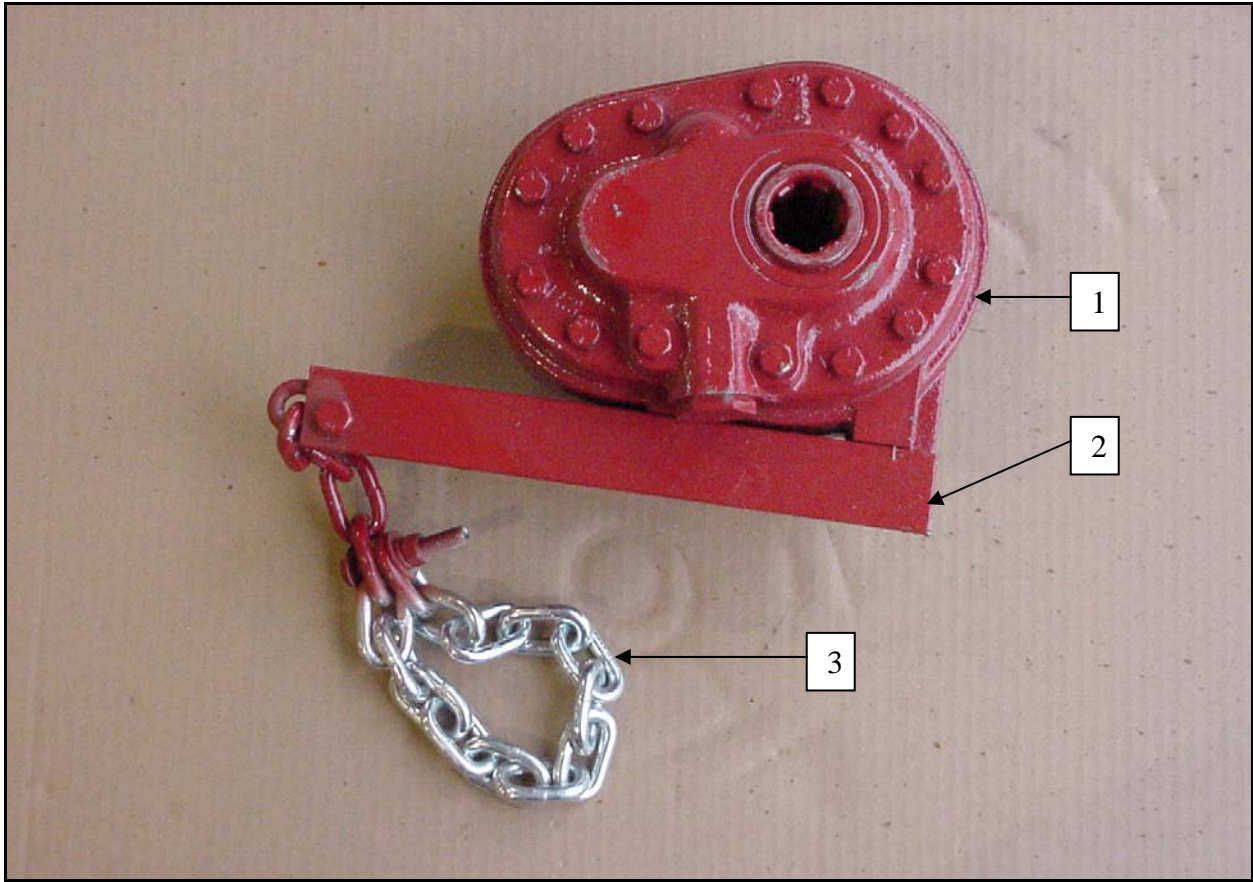

**Hydraulic Pump & Torque Arm Kit**

<b>Ref.</b>	<b>Part #</b>	<b>Description</b>
	<b>HK-101331</b>	<b>Pump &amp; Torque Arm Kit</b>
1	HK-100718	Hydraulic Pump
2	HK-101049	Torque Arm
3	HK-101261	Chain (18 Links)

## Full Load Indicator Kit

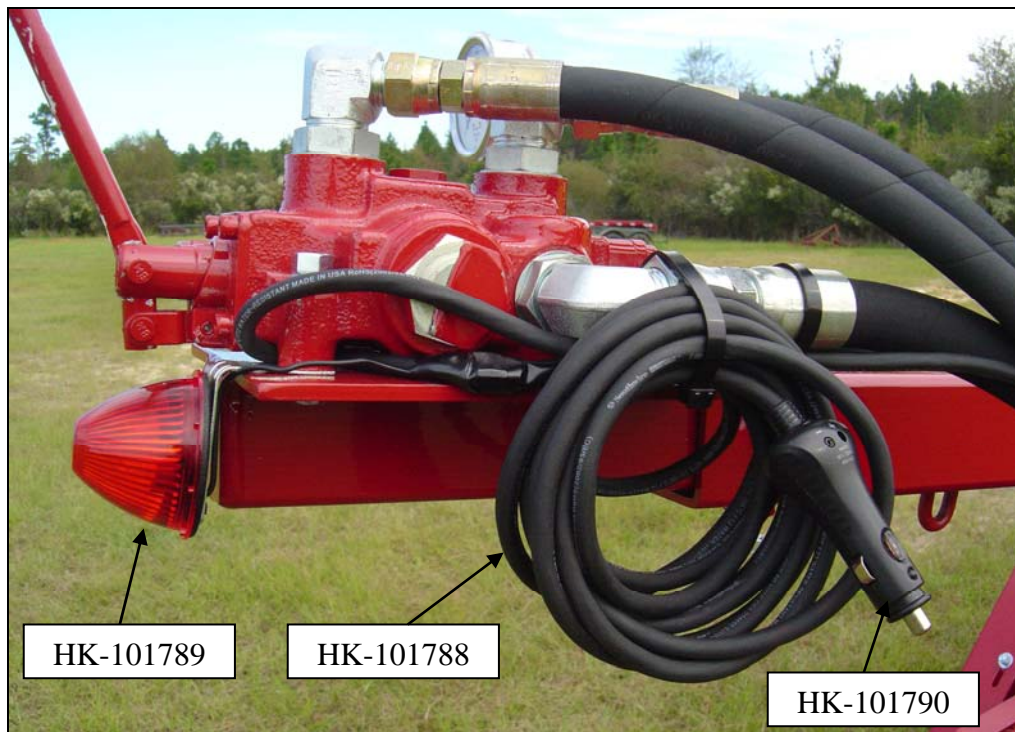

HK-101789

HK-101788

HK-101790

Part Number	Description
<b>HK-101794</b>	<b>Full Load Indicator Kit</b>
HK-101791	Insulated Ring Terminals
HK-101788	Electrical Cable 16/2 sjow Type
HK-101793	Momentary Push Button Switch
Hk-101789	Light
HK-101792	Non Strip Splicer
HK-101790	Power Plug
HW-208108SS	Bolt, HH, 1/2-13NC x 1-1/2" LG 18-8 Stainless Steel
HW-300208ZG5	Nut, Hex, 1/2-13NC Zinc Plated, Gr5
<b>HK-101787</b>	<b>Switch Activator Weldment</b>

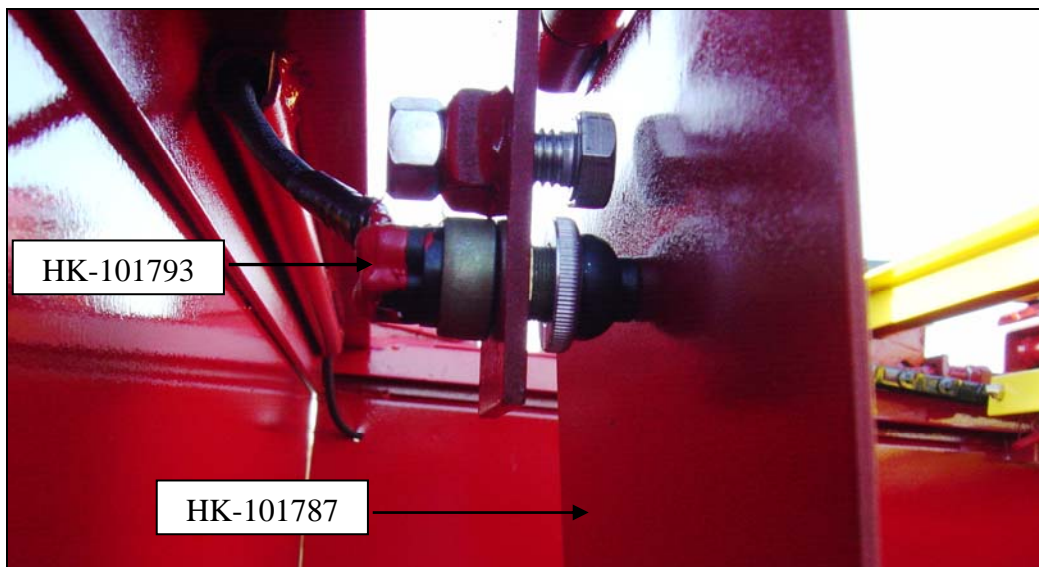

HK-101793

HK-101787

**Optional**

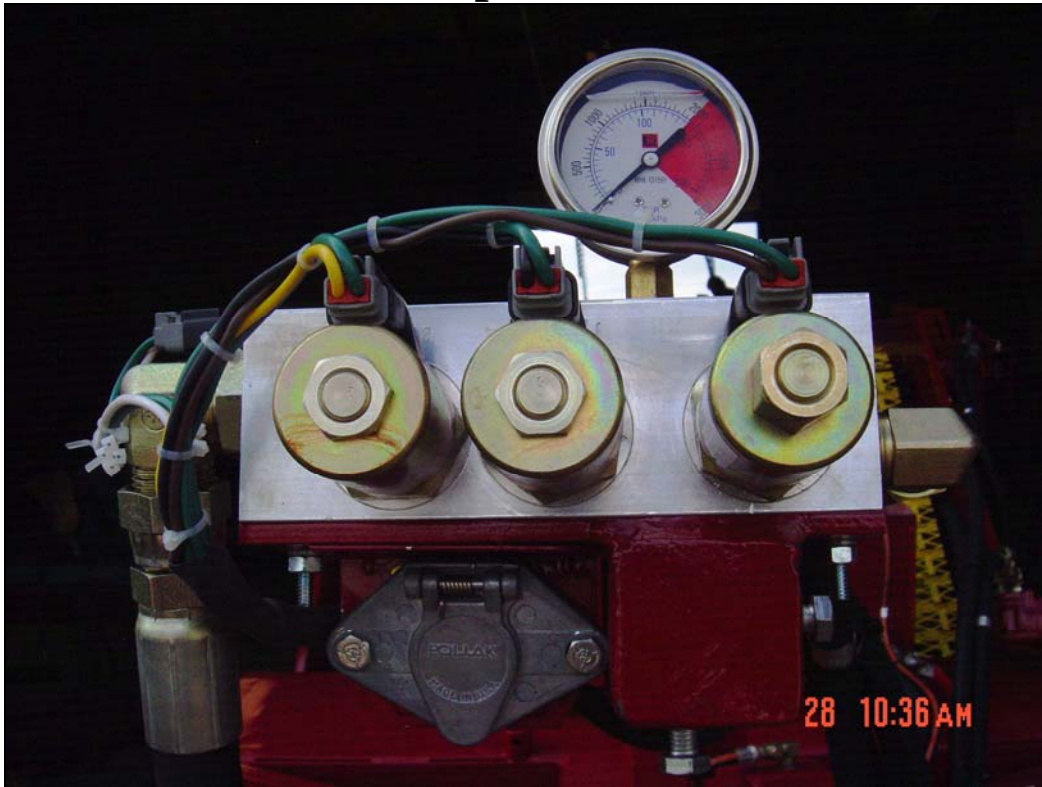

**Electric Control Valve Kit**

**HK-101738**