



CRUSTBUSTER OWNER / OPERATOR MANUAL



MODEL # CB-1 CRUSTBUSTER

Manufactured by: **LEWIS BROTHERS MANUFACTURING, INC.**
Post Office Box 146
Baxley, GA 31513
Tel: (912) 367-4651
Fax: (912) 367-3958

1-2-23

INTRODUCTION

All Lewis Brothers equipment is manufactured under stringent production and quality assurance procedures prior to preparation for shipment. A final quality check is performed on all equipment before shipping.

The best equipment is only as good as its operation and management. Sound operation and good preventive maintenance practices are essential to efficient performance of your Lewis Crustbuster.

Questions on parts and service for the equipment covered in this manual should be referred to the local dealer from whom the equipment was purchased, or the nearest Lewis Brothers Dealer.

We sincerely thank you for purchasing Lewis Brothers equipment.

TABLE OF CONTENTS

INTRODUCTION	2
SAFETY	4
Owner's And Operator's Responsibility	5
General Precautions	6
WARRANTY	7
Limited Warranty	8
SPECIFICATIONS	9
Model CB-1 Specifications	10
SETUP AND OPERATION	11
Attachment to Tractor	12
Operating Instructions	14
MAINTENANCE	15
Chain Adjustment	16
DECALS	17-18
PARTS	19-28

SAFETY

OWNER'S AND OPERATOR'S RESPONSIBILITY

This manual is intended for use with your Lewis Crustbuster. Extra effort has been made to provide for safe operation of this equipment. This manual as well as the safety decals placed on the equipment is part of that effort. Your new Crustbuster should perform the various functions for which it was designed if it is maintained, adjusted to your specific conditions, and operated correctly.

It is the responsibility of the owner and every operator of this equipment to read and understand this manual before initial startup, before each season, before performing service or maintenance tasks and prior to storing the equipment. Each employee who will work on or around this equipment should be instructed in how to do so safely.

It is important to understand the operational methods and safety issues mentioned in this manual. Lewis Brothers cannot anticipate all conceivable ways service and operational functions might be performed and of the possible hazardous consequences of such. Anyone using or servicing this equipment must first satisfy themselves that their chosen methods do not jeopardize the safety of themselves, others, or the equipment.

Read the warranty on page 8. The purchaser is required to fill out and return the registration card supplied with this owner's manual within ten (10) days of purchase to Lewis Brothers Manufacturing to be eligible for warranty coverage.

Genuine Lewis replacement parts will insure the durability and long life of your Crustbuster. Lewis repair parts and optional equipment should be ordered through your Lewis Brothers' Dealer.

Operators should thoroughly inspect the Crustbuster before and after each use. All bearings should be properly lubricated as specified, and any worn or damaged parts repaired or replaced. Failure to repair or replace worn parts could result in damage or excess wear to other parts.

Be sure that all shields are in place. Do Not attempt to work on Crustbuster when supported by tractor lift.

GENERAL PRECAUTIONS

- **MAKE SURE** everyone is clear of the equipment before starting the tractor's engine and while equipment is under operation.
- **DO NOT** permit anyone to ride on this equipment.
- **KEEP** hands, feet, hair and clothing away from all moving parts. Do not wear loose clothing while operating equipment, as this may present an entanglement hazard.
- **DRIVE** the pulling tractor at speeds compatible with conditions and good safety practices. This is especially important when operating over rough ground, on slopes, crossing ditches or while turning.
- **NEVER LEAVE** this equipment in the raised position when parked and unattended.
- **STOP** the tractor's engine and relieve any hydraulic pressure before disconnecting any part of the hydraulic system.
- **MAKE SURE** hitch components are attached securely before operating or transporting.
- **USE** flashing warning lights when on highways, except where prohibited by law.
- **STOP** tractor engine before leaving operator's position to adjust, lubricate, clean or unclog machine.
- **KEEP** all shields in place.
- **MAXIMUM** towing speed is 25 MPH.
- **OBSERVE** all safety decals located on machine. Should any safety decal become damaged unreadable, or lost, **REPLACE IT IMMEDIATELY**. New decals may be obtained from your Lewis Brothers' dealer.
- **WEAR** dust respirator at all times while using this machine (3M part # 8710 is recommended).

WARRANTY

LEWIS BROTHERS MANUFACTURING, INC.

LIMITED WARRANTY

Lewis Brothers Manufacturing, Inc. (hereinafter referred to as "LBM") warrants each item of new equipment manufactured by LBM to be free from defects in material and workmanship under normal use and service.

The obligation of LBM under this LIMITED WARRANTY is limited to repair or replacement, as LBM may elect, of any parts that prove, in LBM's judgment, to be defective in material and workmanship within the first twelve (12) months after the date of invoice to the original purchaser. THIS LIMITED WARRANTY DOES NOT APPLY TO BELTS, HYDRAULIC HOSES, TIRES, AND OTHER SERVICE ITEMS, WHICH SHALL HAVE A NINETY (90) DAY WARRANTY.

THIS LIMITED WARRANTY WILL APPLY FOR (3) MONTHS ONLY WHEN THE UNIT IS USED IN A COMMERCIAL APPLICATION.

All warranty part repairs and replacements must be made by a certified LBM dealer. Any outside work or alterations made without written approval of LBM will render this LIMITED WARRANTY void.

LBM's obligation specifically excludes any liability for consequential damages, such as loss of profit, delays, expenses, damage to goods or property used in connection with or processed in or by the product sold, or damage to the product sold from whatever cause, whether or not such loss is due to negligence by LBM.

This LIMITED WARRANTY shall not apply to any item that has been operated in a manner not recommended by LBM.

No person is authorized to give any other warranties or to assume any other liability on behalf of LBM unless made in writing by Lewis Brothers Manufacturing, Inc.

THIS LIMITED WARRANTY IS IN LIEU OF AND REPLACES ALL OTHER WARRANTIES, EXPRESSED OR IMPLIED. WARRANTIES OF MERCHANTABILITY AND FITNESS FOR A PARTICULAR PURPOSE ARE EXCLUDED, AS ARE ALL OTHER REPRESENTATIONS TO THE USER-PURCHASER AND ALL OTHER OBLIGATIONS OR LIABILITIES, INCLUDING LIABILITY FOR INCIDENTAL AND CONSEQUENTIAL DAMAGES, ON THE PART OF LBM.

LEWIS BROTHERS MANUFACTURING, INC.
P.O. BOX 146 - BAXLEY, GA. 31513
FEBRUARY 1, 2007

SPECIFICATIONS

SPECIFICATIONS

Lewis Crustbuster Model # CB-1

Out side Dimension

Length	33-1/4 inches
Width	92-1/4 inches
Height	44-1/4 inches

Throat

Height	11-1/2 inches
Width	84 inches

Weight

1000 lbs.

Tractor Horsepower required

45 HP

SETUP AND OPERATION

MACHINE SETUP

Attachment to Tractor

The Lewis Crustbuster may be operated on any tractor equipped with a standard 3-point hitch. Attach the Crustbuster as shown in (Figure 1) and secure with the proper attachment pins. Attach the Drive Shaft to the tractor PTO, by Sliding the Drive Shaft onto the PTO. Always try to pull the Drive shaft from the PTO after it is in place to ensure a secure attachment. (Figure 1) See page 13 to adjust Drive Shaft length to fit tractor.



Figure 1

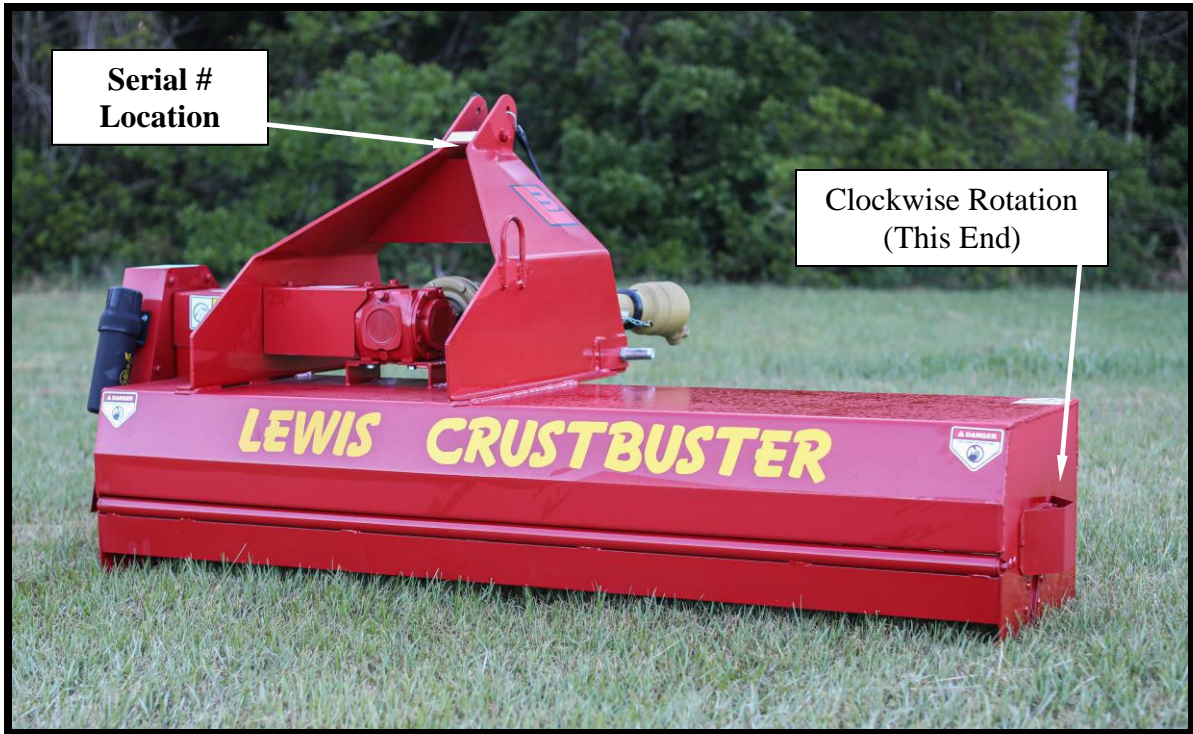
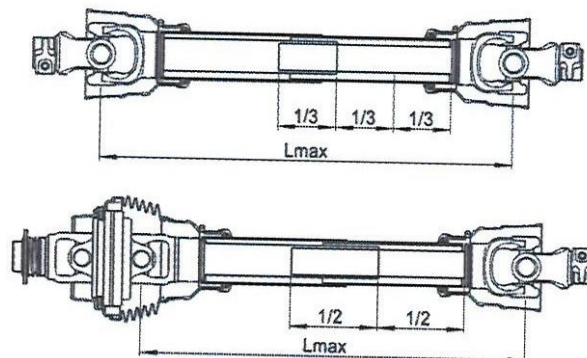

Figure 2

Adjusting a PTO Shaft Length

(1) With the crustbuster attached to the tractor's three point hitch and the PTO not installed, separate the PTO driveline. Attach the implement end to the crustbuster and the tractor end to the tractor PTO shaft. (2) Raise the crustbuster by using the tractor's 3-point hitch, (lift to its maximum height). (3) Holding the half shafts next to each other, mark them so each end is approximately $\frac{1}{2}$ " from hitting the end of the telescopic profiles. (4) Shorten the inner and outer guard tube equally to the amount of the transmission tube, making sure they do not have any burs or shavings and grease the telescopic profile generously before reassembling.

!DO NOT SHORTEN TOO MUCH, THE PROPER OVERLAP IS A MINIMUM OF $\frac{1}{3}$ THE LENGTH OF EACH PROFILE.



Operating Instructions

The Crustbuster should be operated at a consistent depth to achieve maximum results. Proper ground speed for the volume of material being processed will yield the best results. The operator should maintain a safe distance from house walls and any other in-house equipment, so as to avoid any possible damage to the poultry house or the Crustbuster.



Figure 5

Litter conditions will determine the optimum depth and speed combination to operate the Crustbuster. Heavy or Wet litter may require slower ground speeds.

Be sure to wash, clean, and lubricate the Crustbuster after each use..

Keep all shields in place and replace any decals that become worn or missing.

Keep hands and feet away from moving parts.

MAINTENANCE

MATINTENANCE

CHAIN ADJUSTMENT

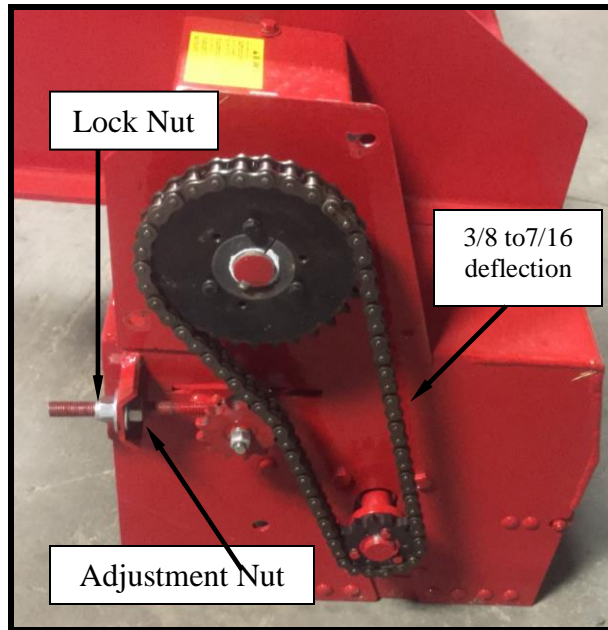

Figure 7

Tighten adjustment nut until 3/8" to 7/16" deflection as shown in figure 7, then tighten lock nut. (Figure 7)

KNIFE KIT

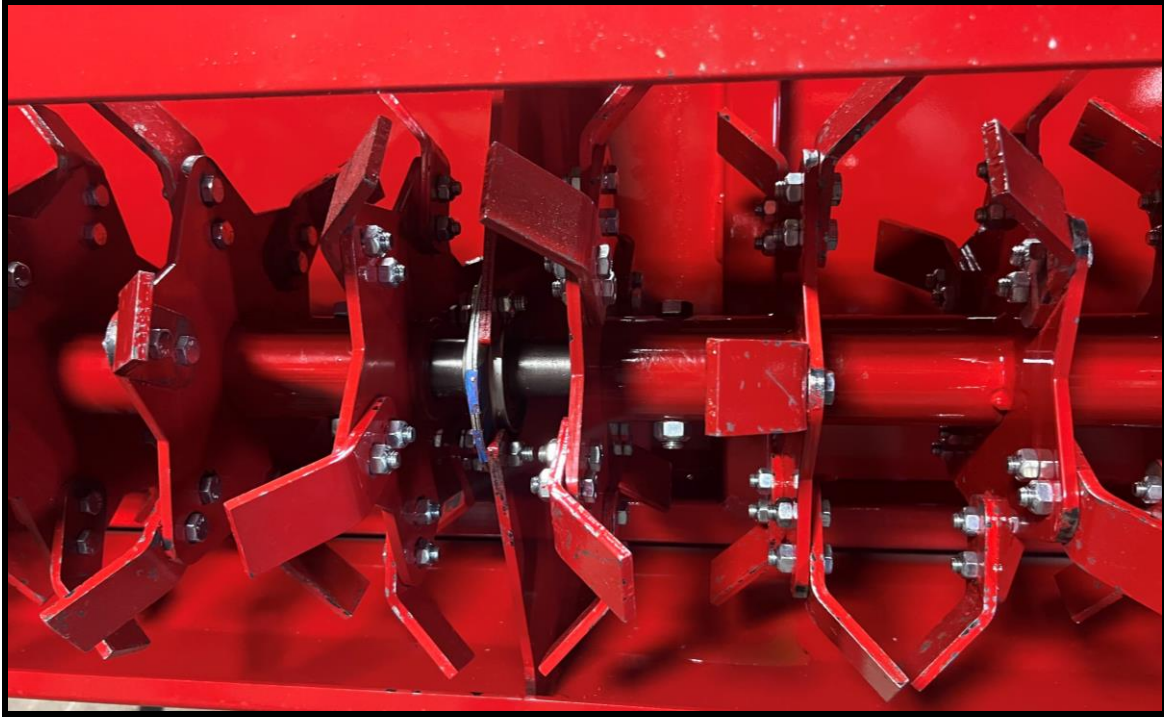

Figure 8



Figure 9

See figure 8 and figure 9 for Knife pattern ; kit # CB-200228.

DECALS

DANGER

Keep hands away from moving parts

Do not operate machinery without guards and safety devices

Do not clean, oil or repair machinery while in motion

HK-100919



HK-100916

BE CAREFUL

- KEEP ALL SHIELDS IN PLACE.
- STOP ENGINE BEFORE LEAVING OPERATOR'S POSITION TO ADJUST, LUBRICATE, CLEAN OR UNLOCK MACHINES.
- WAIT FOR ALL MOVEMENT TO STOP BEFORE SERVICING THE MACHINE.
- KEEP HANDS, FEET AND CLOTHING AWAY FROM POWER DRIVEN PARTS.
- KEEP OFF EQUIPMENT UNLESS SEAT OR PLATFORM FOR OPERATION AND OBSERVATION IS PROVIDED.
- KEEP ALL OTHERS OFF.
- USE FLASHING WARNING LIGHTS WHEN OPERATING ON HIGHWAYS EXCEPT WHEN PROHIBITED BY LAW.
- MAKE CERTAIN EVERYONE IS CLEAR OF MACHINE BEFORE STARTING ENGINE OR OPERATION.

HK-100899

HK-100899

WARNING

**DIS-ENGAGE P.T.O.
BEFORE GETTING OFF
OF TRACTOR**

HK-100912

WARNING

**KEEP AWAY FROM
MOVING MACHINE**

HK-100986

HK-100986



HK-101853

WARNING

MOVING PART HAZARD
To prevent serious injury or death from moving parts:

- Close and secure guards and shields before starting.
- Keep hand, feet, hair and clothing away from moving parts.
- Disconnect and lockout power source before adjusting or servicing.
- Do not stand or climb on machine when operating.

SUNWEST SCREEN GRAPHICS® SW 404

HK-100908

PARTS

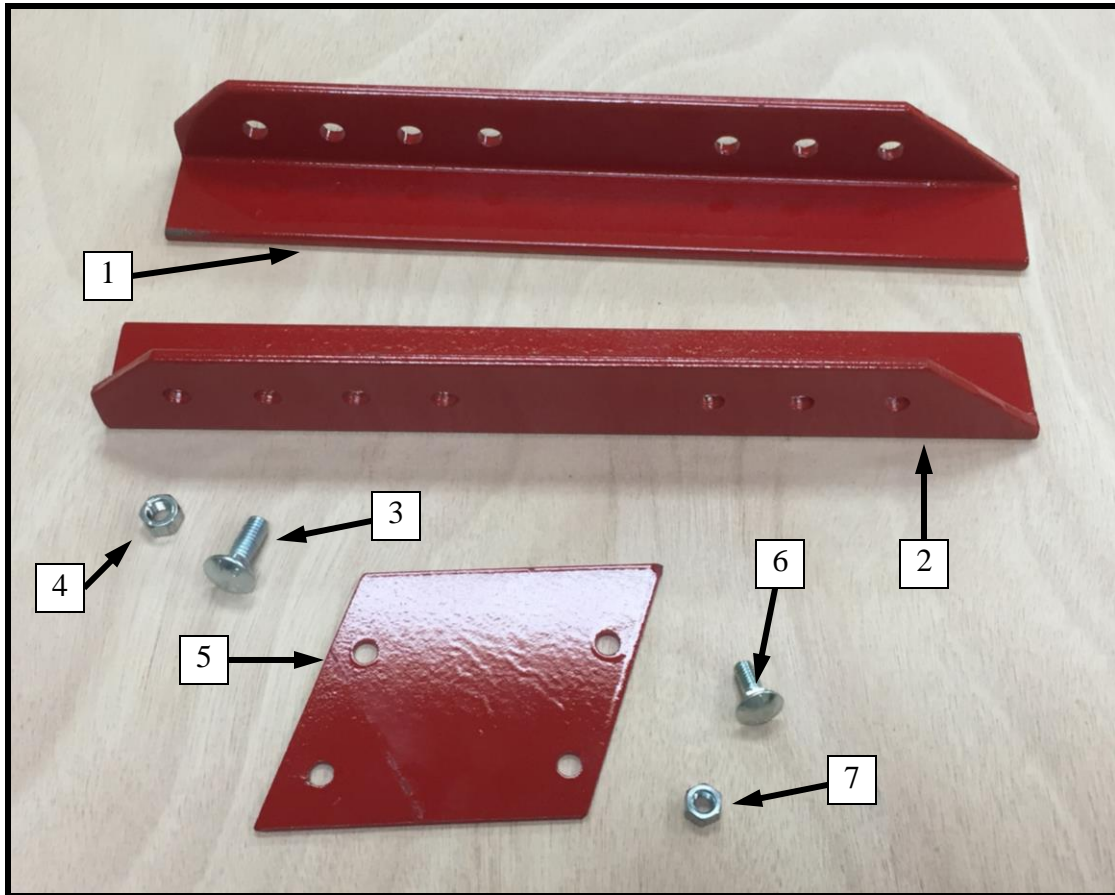

ITEM	PART #	DESCRIPTION	QTY. REQUIRED
1	CB-200127	SLIDE, LEFT SIDE	1
2	CB-200128	SLIDE, RIGHT SIDE	1
3	HW-804104G5Z	BOLT, CARRIAGE 3/8-16 X 1 LG	14
4	HW-300204Z	NUT, HEX, 3/8-16, ZP	14
5	CB-200117	SLOT COVER	2
6	HW-802104	BOLT, CARRIAGE, 5/16-18 X 1 LG, G5, ZP	8
7	HW-300202ZG5	NUT, HEX, 5/16-18, ZP	8
8	HW-335202Z	WASHER, LOCK, SPLIT, 5/16, ZP (NOT SHOWN)	8
9	HW-335204Z	WASHER, LOCK, SPLIT, 3/8, ZP (NOT SHOWN)	14

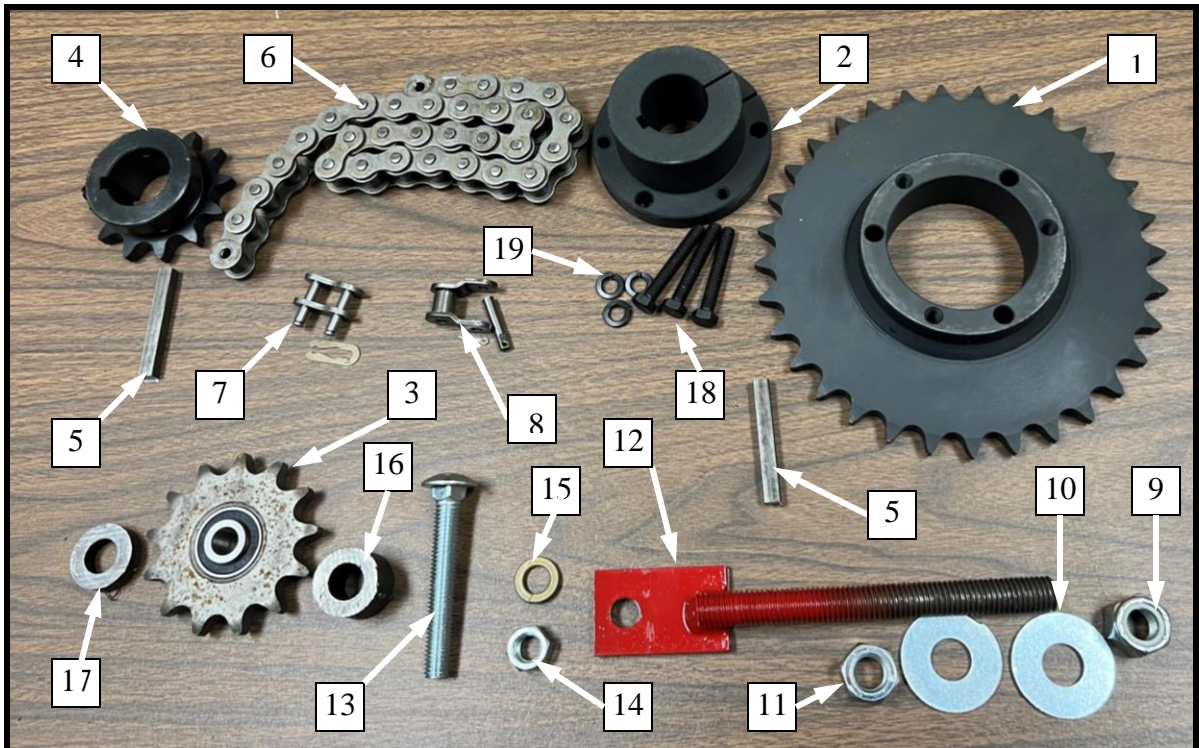
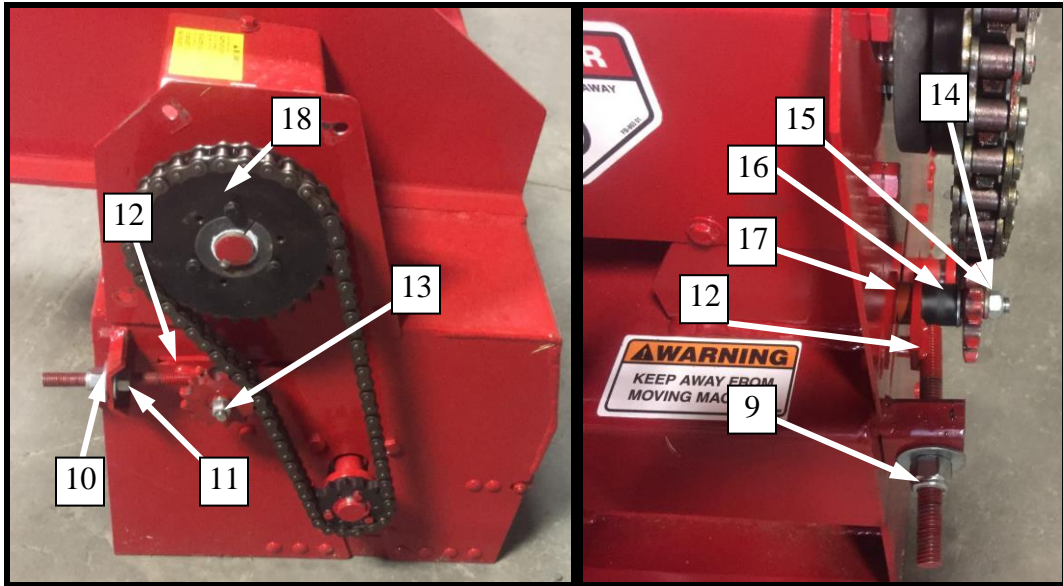

ITEM #	PART #	DESCRIPTION	QTY. REQUIRED
1	CB-400002	SPROCKET (32T) (GEAR BOX DRIVE)	1
2	HK-100447	TAPER BUSHING (GEAR BOX DRIVE)	1
3	CB-400019	IDLER SPROCKET	1
4	HK-101230	SPROCKET (12T) (CYLINDER)	1
5	HK-100496	KEY 5/16 X 5/16 X 2.5 LG	2
6	WR-600092	#60 HD ROLLER CHAIN (48-3/4 IN LG OR 65 PITCHES)	1
7	WR-600094	#60 HD CONNECTING LINK	1
8	WR-600093	#60 HD OFFSET LINK	0
9	HW-301212NEZ	NUT,NYLON INSERT LOCK, HEX, 5/8-11, ZP	1
10	HW-325212Z	5/8, FLAT WASHER,ZP	2
11	HW-300212ZG5	NUT, HEX, 5/8-11, NC PLATED, G5	1
12	CB-400045	CHAIN ADJUSTMENT ROD	1
13	HW-808124G5	BOLT, CARRIAGE, 1/2-13 X 3-1/2" LG, G5	1
14	HW-301208SC	NUT, STOVER LOCK, HEX, 1/2-13	1
15	HW-335208Z	1/2, WASHER, LOCK, ZP	1
16	CB-400049	SPACER (7/8 LG)	1
17	CB-400048	SPACER (3/8 LG)	1
18	HW-202108G8C	BOLT, HEX HEAD, 5/16-18X 1-1/2" LG, G8	3
19	HW 335202Z	5/16, WASHER, LOCK	3

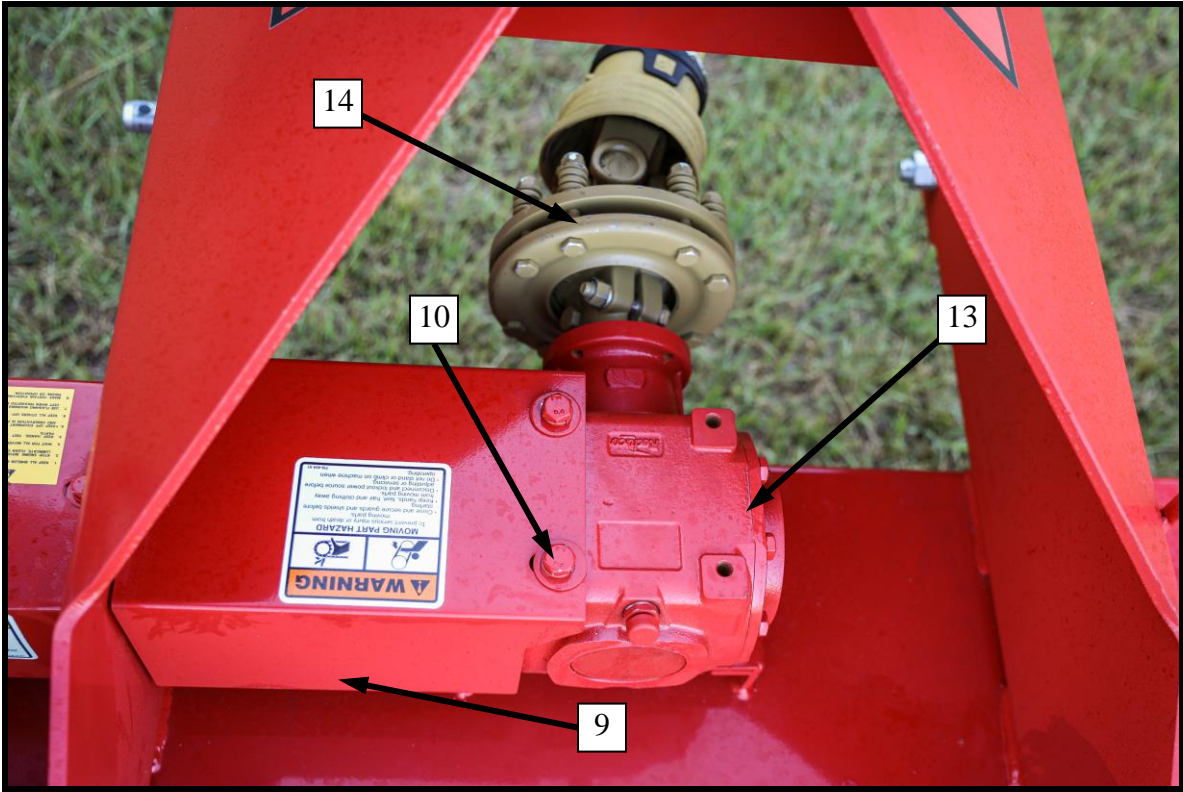
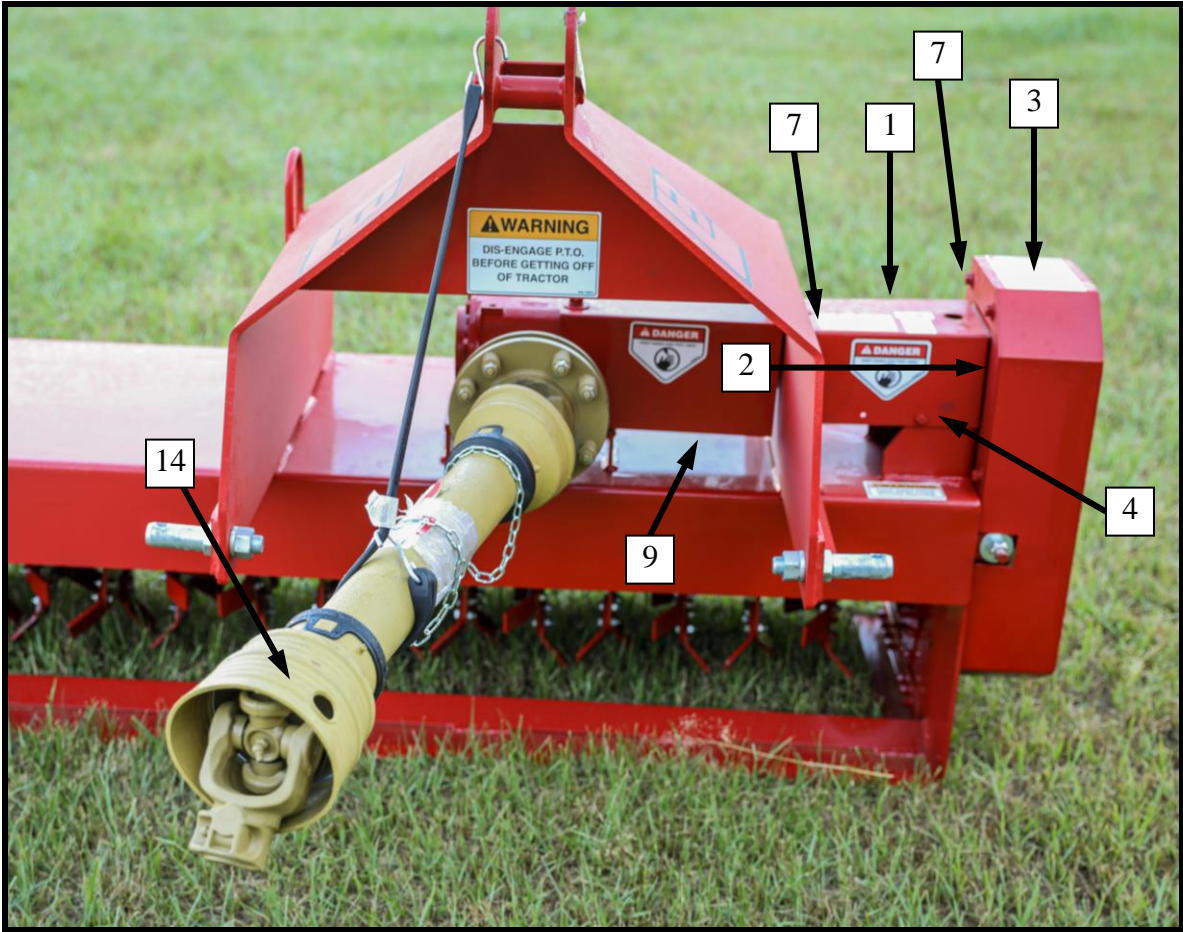

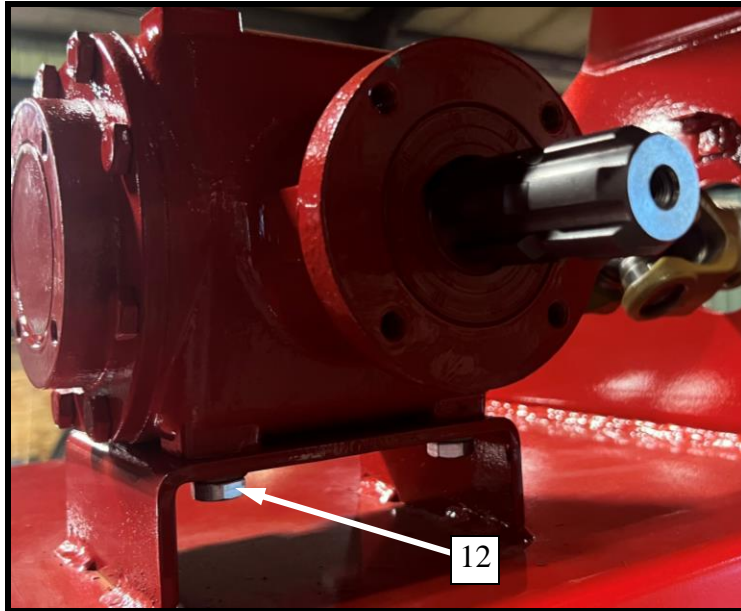

ITEM #	PART #	DESCRIPTION	QTY. REQUIRED
1	CB-400025	BEARING COVER	1
2	CB-400246	GUARD BACK	1
3	CB-400240	CHAIN GUARD	1
4	HW-200104G5	BOLT, HH, 1/4-20 X 1 LG, G5	4
5	HW-300200ZG5	NUT, HEX, 1/4-20, ZP, G5 (NOT SHOWN)	2
6	HW-335200Z	WASHER, LOCK, 1/4, ZP (NOT SHOWN)	4
7	HW-204104G5Z	BOLT, HH, 3/8-16 X 1 LG, G5, ZP	4
8	HW-335204Z	WASHER, LOCK, 3/8, ZP (NOT SHOWN)	4
9	CB-400027	GEAR BOX SHAFT GUARD	1
10	HW-960318	BOLT, HEX, 12MM-1.75 X 16MM LG, ZP,	2
11	HW-335208Z	1/2 " WASHER, LOCK, ZINC PLATER (NOT SHOWN)	6
12	HW-960330	BOLT, HEX, 12MM-1.75 X 20MM LG, ZP,	4
13	WR-100028	GEAR BOX	1
14	CB-400505	DRIVE SHAFT	1

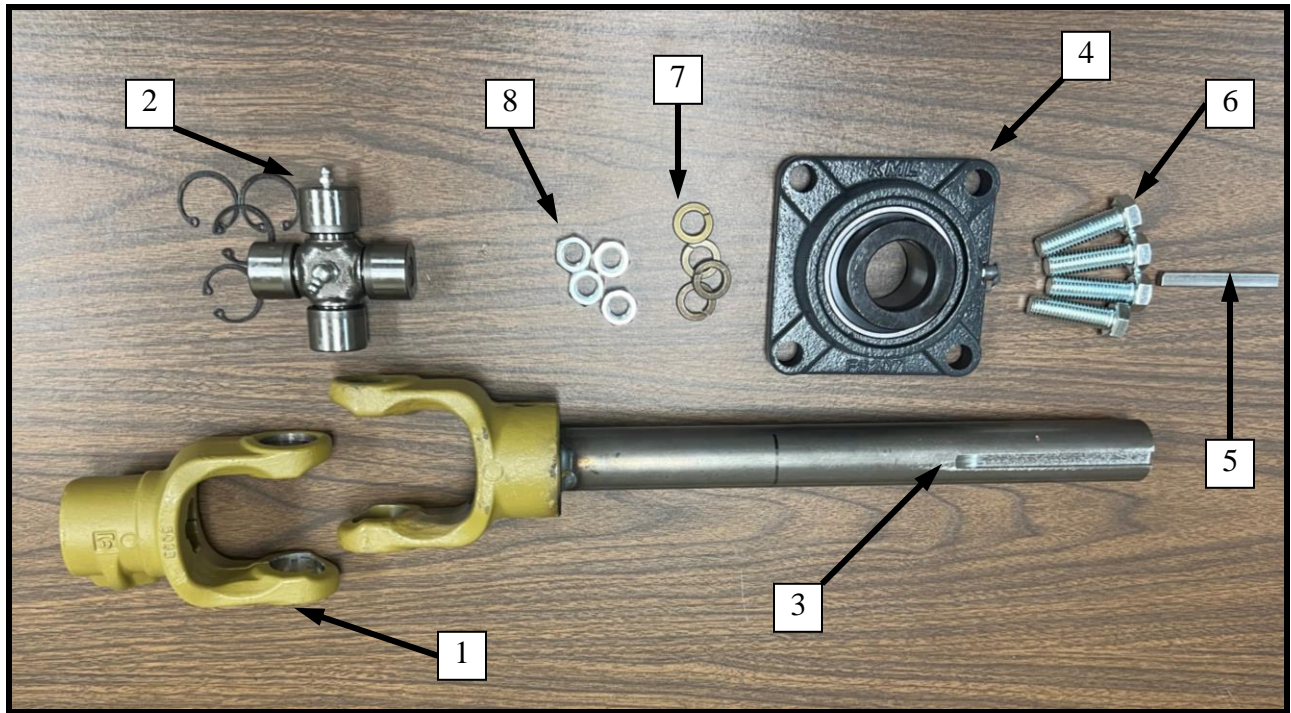

Item #	PART #	DESCRIPTION	QTY. REQUIRED
1	CB-400021	YOKE	1
2	WR-100026	U-JOINT	1
3	CB-400030	SHAFT WELDMENT	1
4	HK-100464	BEARING	1
5	HK-100496	KEY	1
6	HW-208116G5Z	BOLT, HEX HEAD, 1/2NC X 2-1/2	4
7	HW-335208Z	WASHER, LOCK, 1/2	4
8	HW-300208ZG5	NUT, HEX, 1/2 NC	4
9			

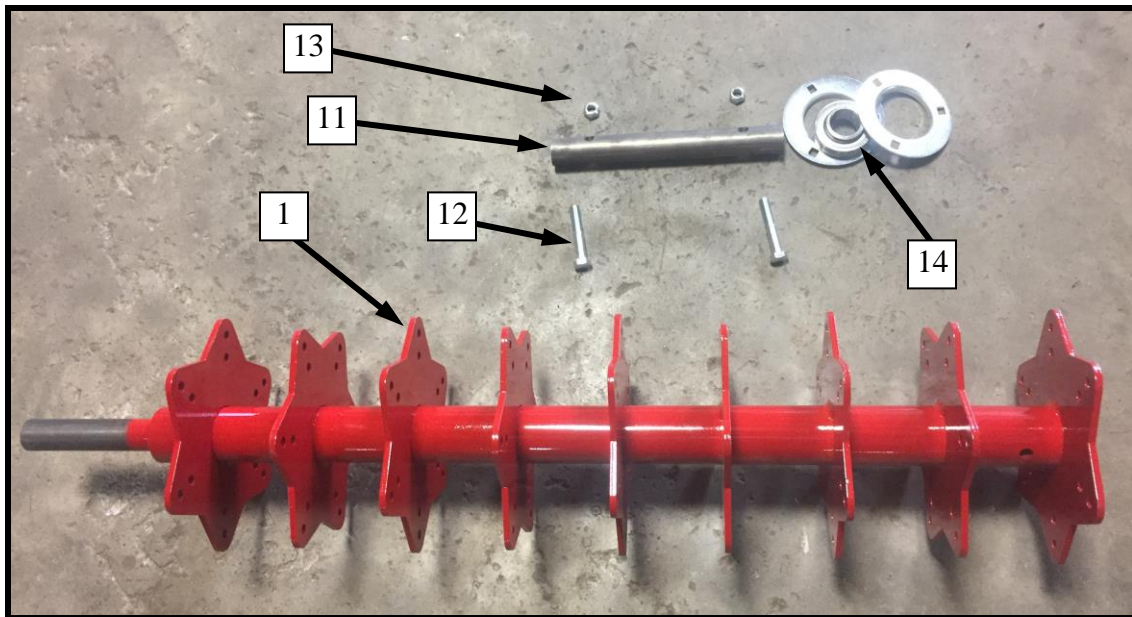
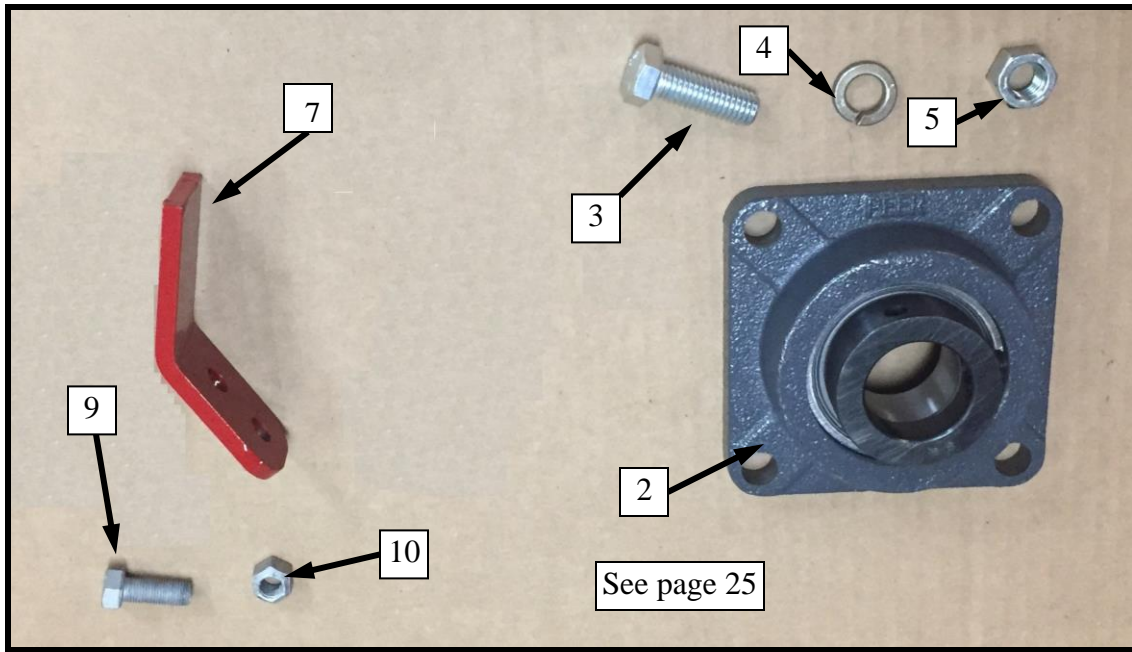

ITEM #	PART #	DESCRIPTION	Qty. required
1	CB-200230	REEL	2
2	HK-100464	FLANGE BEARING	2
3	HW-208112G5Z	BOLT,HH,1/2-13 X 2 LG, G5, ZP,	4
4	HW-335208Z	WASHER, LOCK, 1/2, ZP	4
5	HW-300208ZG5	NUT, HEX, 1/2-13, ZP, G5	4
7	CB-200225	CRUSTBUSTER KNIFE	108
9	HW-204104G5Z	BOLT, HH, 3/8-16 X 1 LG, G5	216
10	HW-301204TLZ	NUT,TOP LOCK, HEX 3/8-16,	216
11	CB-200232	CENTER SHAFT	1
12	HW-208120G5Z	BOLT, HEX HEAD, 1/2-13 X 3" LG, G5, ZP	2
13	HW-301208SC	NUT, STOVER LOCK, HEX, 1/2-13NC	2
14	CB-200010	CENTER BEARING	1

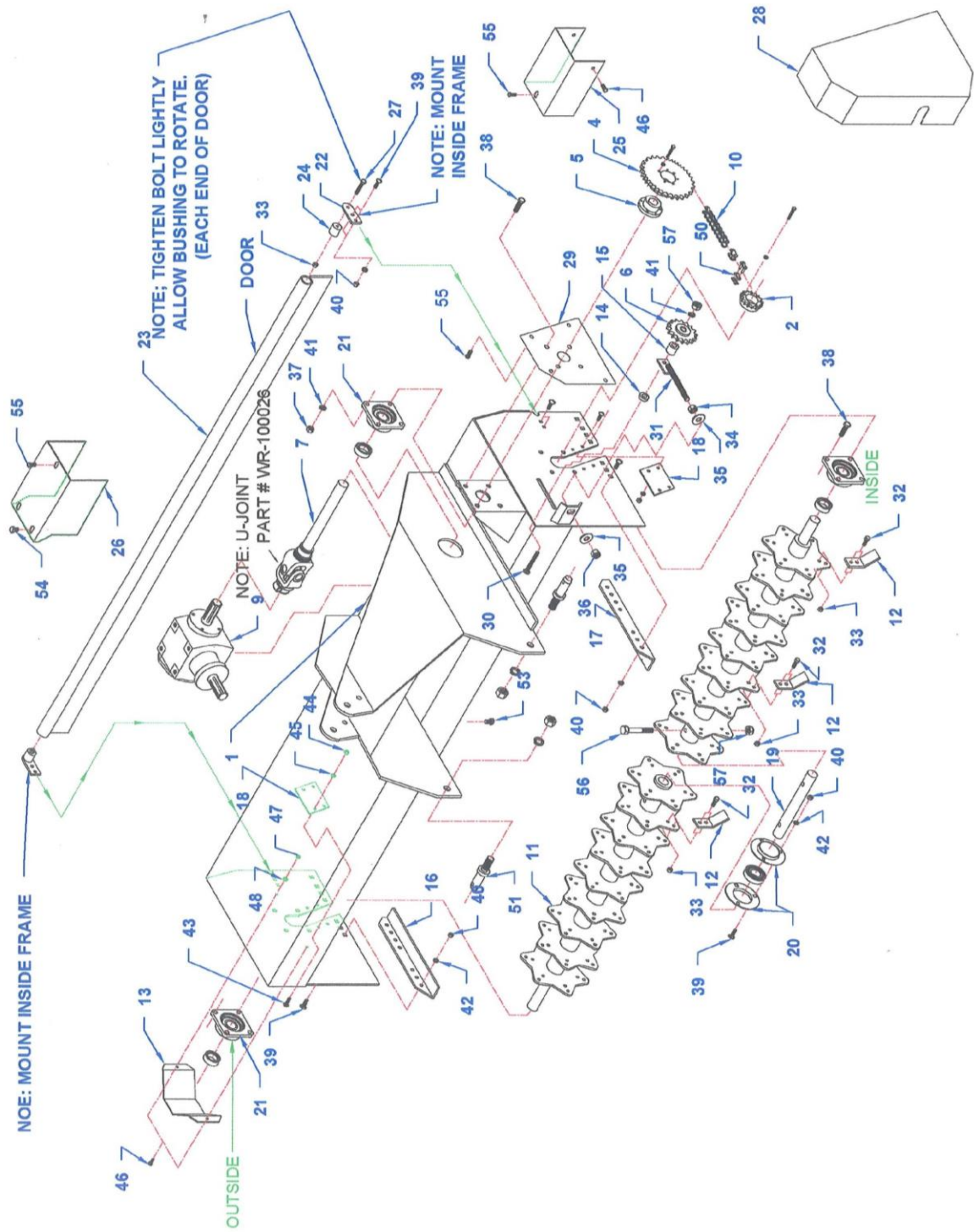

BILL OF MATERIAL		
ITEM	DESCRIPTION	QTY.
2	HK-101230 SPROCKET 12 TOOTH (CYLINDER)	1
3		
4	CB-400002 SPROCKET 32 TOOTH (GEAR BOX DRIVE)	1
5	HK-100447 TAPER BUSHING (GEAR BOX DRIVE)	1
6	CB-400019 IDLER SPROCKER	1
7	CB-400020 SHAFT ASSEMBLY	1
8	CB-400505 DRIVE SHAFT (SEE PAGE 23)	1
9	WR-100028 GEAR BOX	1
10	WR-600092 # 60 ROLLER CHAIN HD	48.75
11	CB-200251 SHAFT WELDMENT	2
12	CB-200225 CRUST BUSTER KNIFE #1	108
13	CB-200055 BEARING COVER	1
14	CB-400048 SPACER (3/8 LG)	1
15	CB-400049 SPACER (7/8 LG)	1
16	CB-200128 SLIDE RIGHT SIDE	1
17	CB-200127 SLIDE LEFT SIDE	1
18	CB-200117 SLOT COVER	2
19	CB-200232 CENTER SHAFT	1
20	CB-200010 CENTER BEARING	1
21	HK-100464 FLANGE BEARING	3
22	CB-200408 GATE MOUNT FLAT	2
23	CB-200400 REAR GATE	1
24	05-100851 BUSHING	2
25	CB-400025 GUARD	1
26	CB-400027 GUARD (GEAR BOX)	1
28	CB-400240 CHAIN GUARD (GEAR BOX MACHINE)	1
29	CB-400246 CHAIN GUARD BACK (GEAR BOX MACHINE)	1
30	HW-808124G5 BOLT CARRIAGE, 1/2-13 X 3-1/2 LG, G5	1
31	CB-400045 CHAIN ADJUSTMENT ROD WELDMENT	1
49	HK-101827 CANISTER	1
50	WR-600094 # 60 CONNECT LINK	1
51	WB-100156 LIFT ARM PINS	2
52	CB-400004 CRUSTBUSTER DECAL KIT	

BILL OF MATERIAL		
ITEM	DESCRIPTION	QTY.
29	CB-400246 CHAIN GUARD BACK (GEAR BOX MACHINE)	1
30	HW-808124G5 BOLT CARRIAGE, 1/2-13 X 3-1/2 LG, G5	1
31	CB-400045 CHAIN ADJUSTMENT ROD WELDMENT	1
32	HW-204104G5Z BOLT, HH, 3/8-16 X 1 LG	216
33	HW-301204TLZ NUT, TOP LOCK, 3/8-16 ZINC PLATE	216
34	HW-300212ZG5 NUT, HEX, 5/8-11 ZINC PLATE, GRADE 5	1
35	HW-325212Z 5/8, USS, FLAT WASHER, ZINC PLATED	2
36	HW-301212NEZ NUT, NYLON INSERT LOCK, HEX, 5/8-11 NC	1
37	HW-300208ZG5 NUT, HEX, 1/2-13 NC, ZINC PLATED, G5	12
38	HW-208110G5Z BOLT, HEX HEAD, 1/2-13 X 1-3/4 LG, G5, ZP	12
39	HW-804104G5Z BOLT, CARRIAGE 3/8-16 X 1, ZP	21
40	HW-300204ZG5 NUT, HEX, 3/8-16, ZP	21
41	HW-335208Z 1/2, WASHER, LOCK, ZINC PLATED	12
42	HW-335204Z 3/8 WASHER LOCK, ZP	21
43	HW-802104 BOLT, CARRIAGE, 5/16-18 X 1 LG,G5, ZP	8
44	HW-300202ZG5 NUT, HEX, 5/16-18, ZP	8
45	HW-335202Z 5/16 WASHER, LOCK, ZP	8
46	HW-200102G5Z BOLT, HEX HEAD, 1/4-20 X 3/4 LG, G5, ZP	2
47	HW-300200ZG5 NUT, HEX, 1/4-20, ZP, G5	2
48	HW-335200Z 1/4, WASHER, LOCK, ZP	2
49	HK-101827 CANISTER	1
50	WR-600094 # 60 CONNECT LINK	1
51	WB-100156 LIFT ARM PINS	2
52	CB-400004 CRUSTBUSTER DECAL KIT	1
53	HW-960330 BOLT, HEX, 12MM-1.75 x 20MM LG, ZP, W/SHOULDER	4
54	HW-960318 BOLT, HEX, 12MM-1.75 x 16MM LG, ZP, W/SHOULDER	2
55	HW-204103G5Z BOLT, HEX HEAD, 3/8-16 X 7/8, LG, G5, ZP	8
56	HW-208122G5Z BOLT, HH, 1/2-13NC X 3-1/4	2
57	HW-301208SC NUT, STOVER LOCK, HEX, 1/2-13NC	3